

## CATEGORIA I

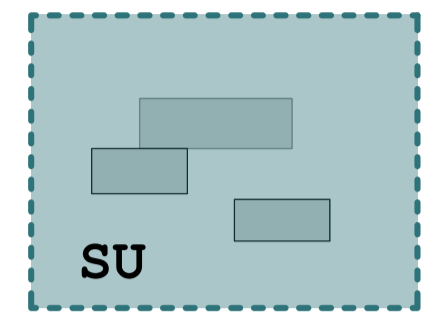

1. Edificaciones en suelo urbano

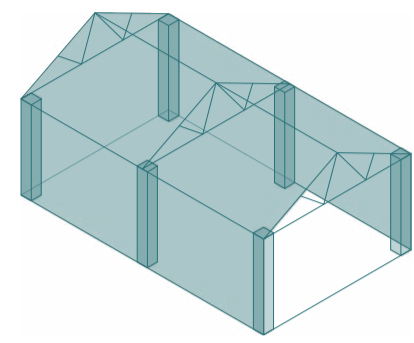

7. Mantener a nivel patrimonial estructura y volumen

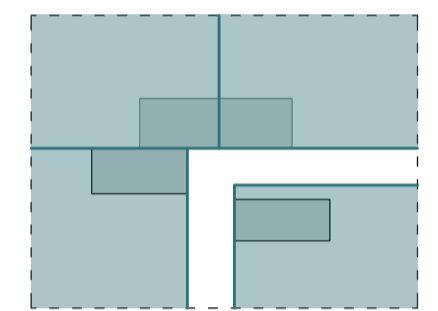

2. Ámbito que se puede dividir en diferentes propiedades

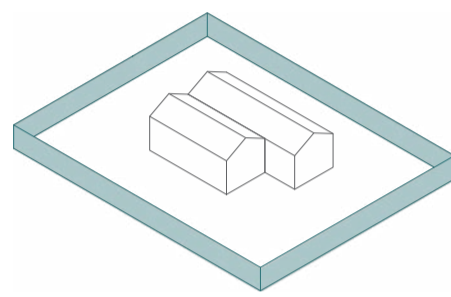

8. Vallas de protección entre edificación productiva y tejido residencial

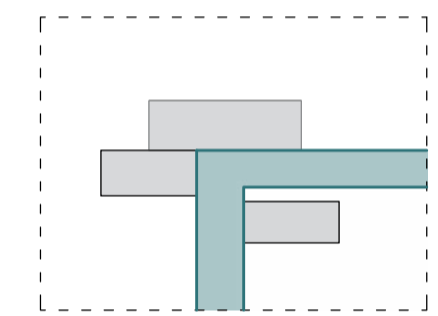

3. Accesibilidad a todas las subdivisiones

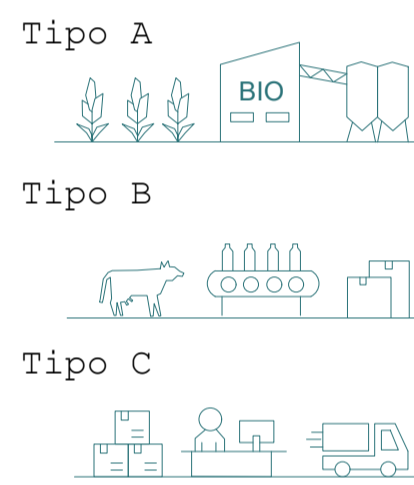

9. Usos

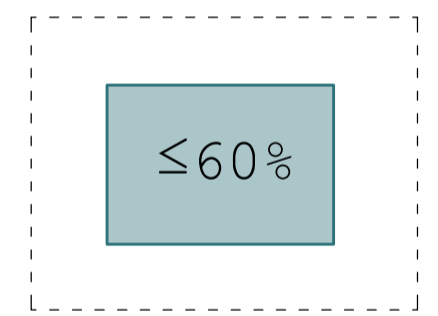

4. Ocupación  $\leq 60\%$

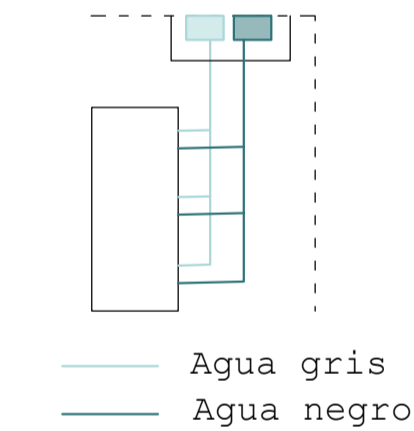

10. Redes separativas

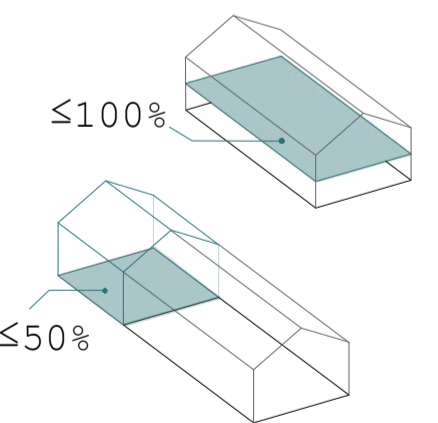

5. Edificabilidad  $\leq 100\%$   
 $\leq 50\%$

I.E.  $\leq 1,8 \text{ m}^2\text{t}/\text{m}^2\text{s}$

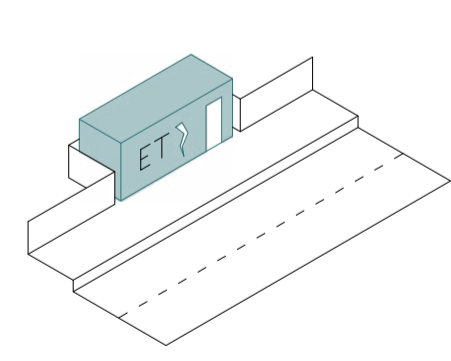

11. ET

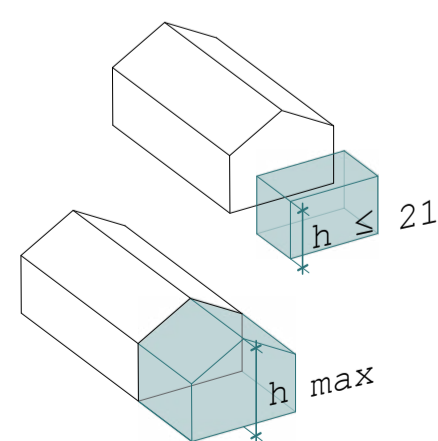

6. Altura máxima de ampliaciones  $h \leq 21\text{m}$   
 $h_{\text{max}}$

## CATEGORIA II

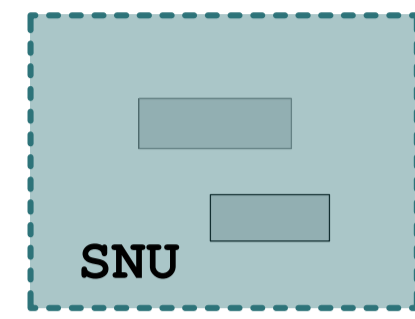

1. Edificaciones en suelo no urbanizable

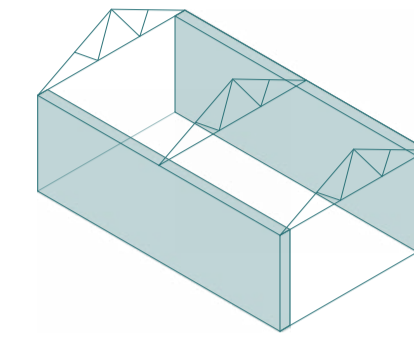

6. Mantener a nivel patrimonial estructura y fachada

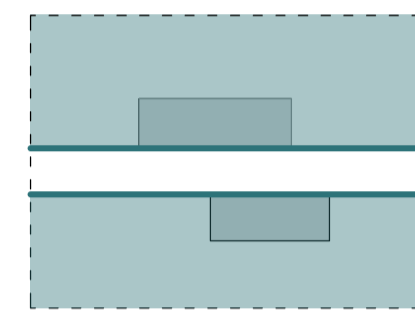

2. Ámbito que se puede dividir en diferentes propiedades

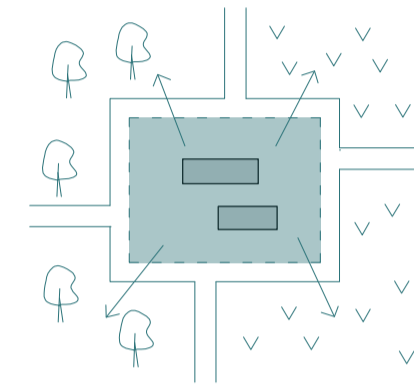

7. Relación con el entorno

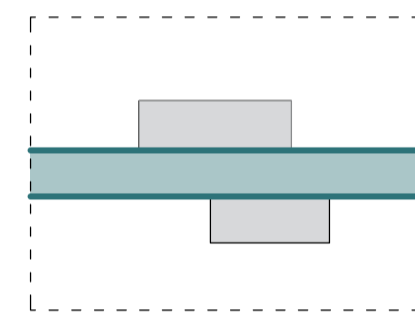

3. Accesibilidad a todas las subdivisiones

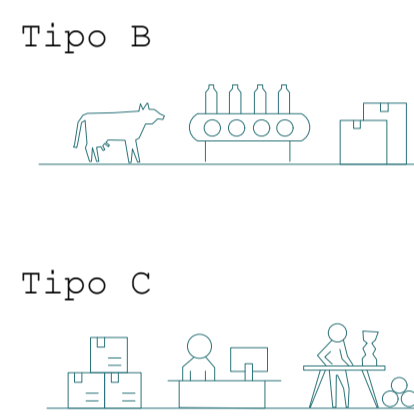

8. Usos

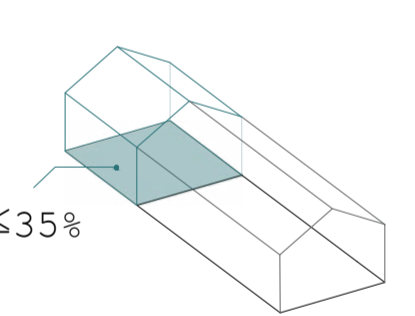

4. Edificabilidad  $\leq 35\%$

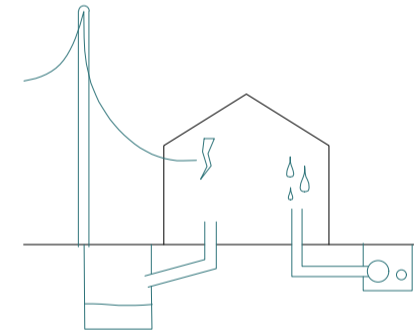

9. Conexión a redes aéreas y agua

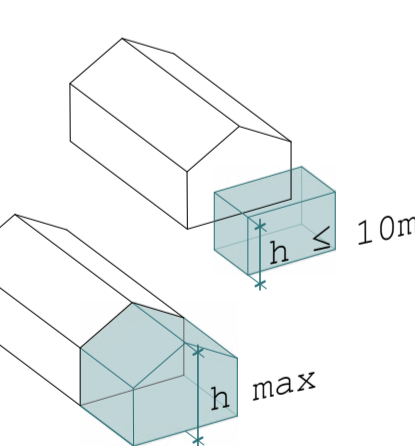

5. Altura máxima de ampliaciones  $h \leq 10\text{m}$   
 $h_{\text{max}}$

## CATEGORIA III

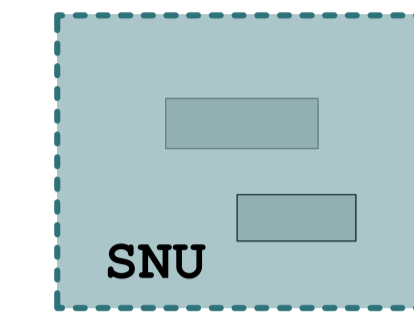

1. Edificaciones en suelo no urbanizable

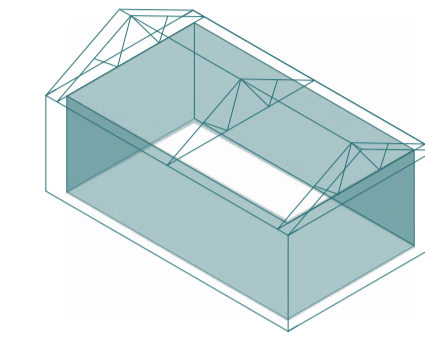

6. Mantener a nivel patrimonial, solo permite la modificación interior y la limpieza

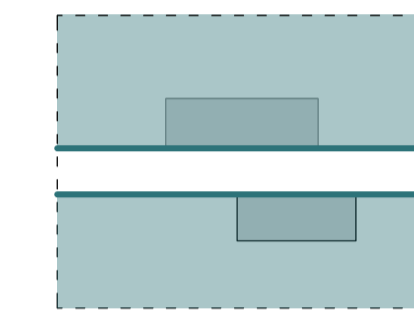

2. Ámbito que se puede dividir en diferentes propiedades

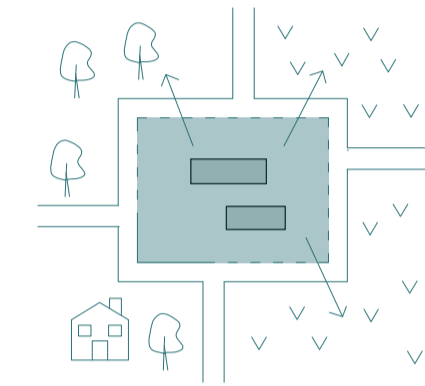

7. Relación con el entorno

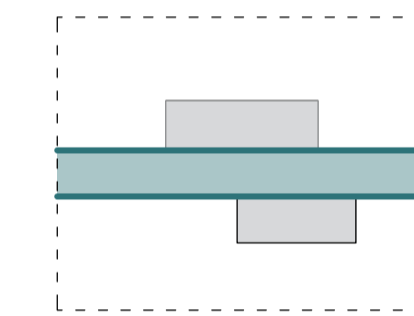

3. Accesibilidad a todas las subdivisiones

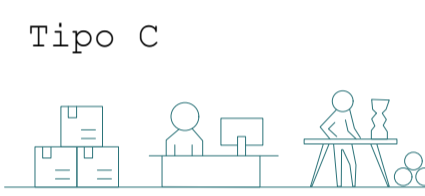

8. Usos

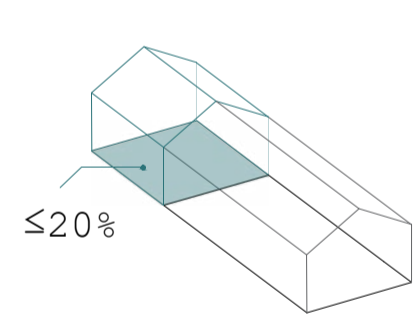

4. Edificabilidad  $\leq 20\%$

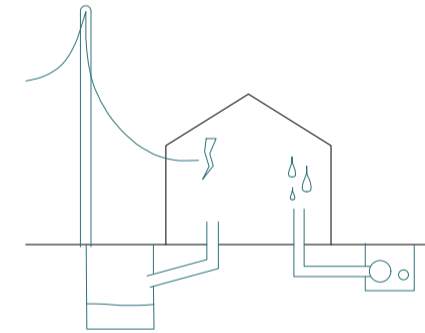

9. Conexión a redes aéreas y agua

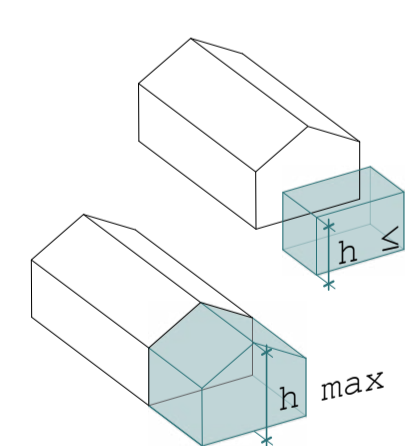

5. Altura máxima de ampliaciones  $h \leq 10\text{m}$   
 $h_{\text{max}}$