

DIAGRAMES

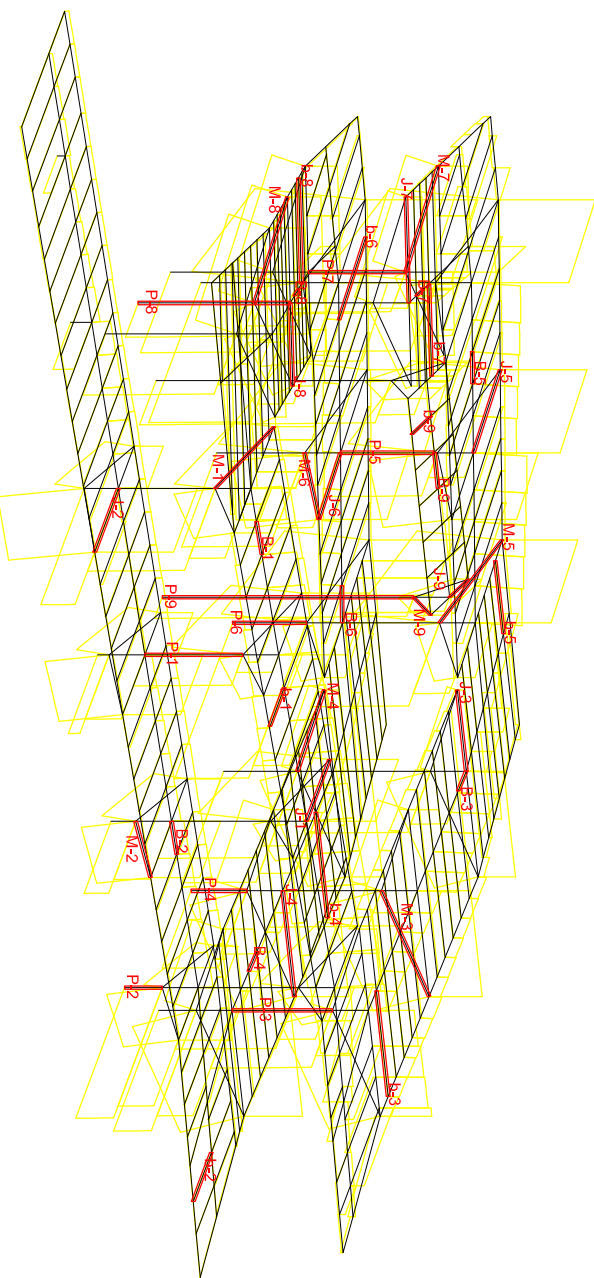

AXIS

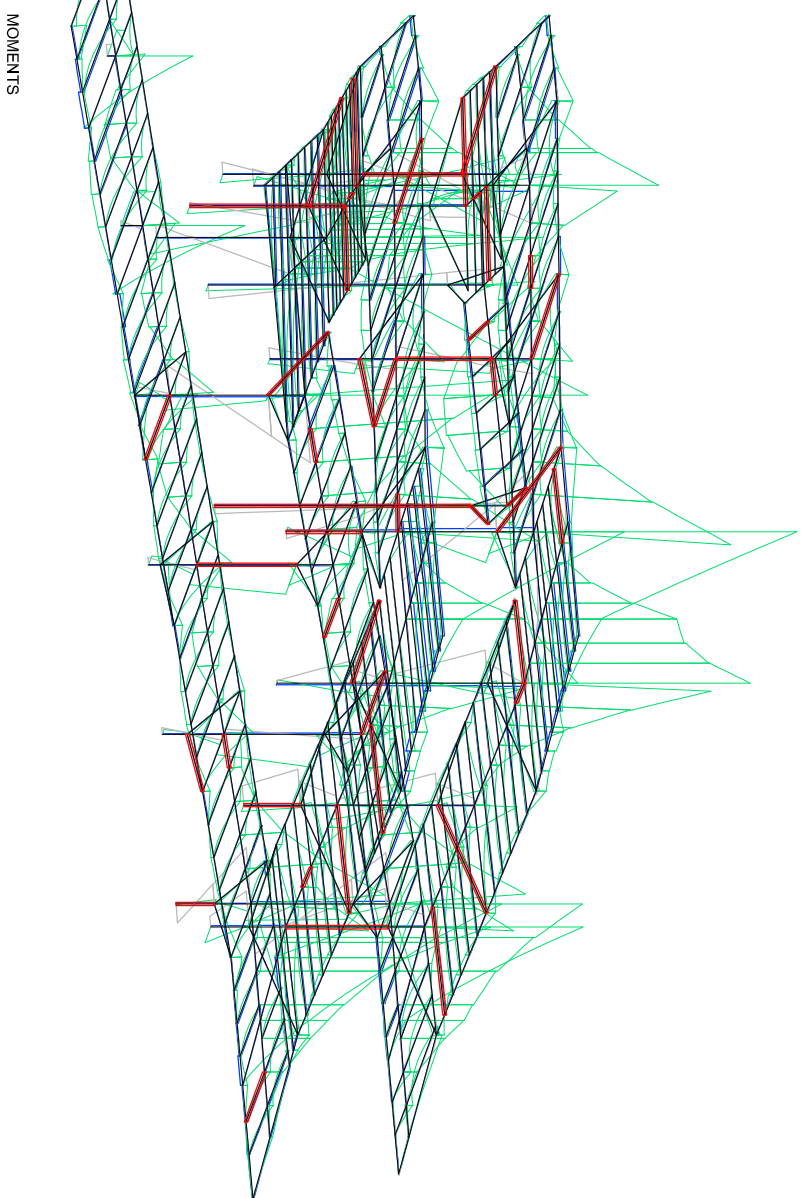

MOMENTS

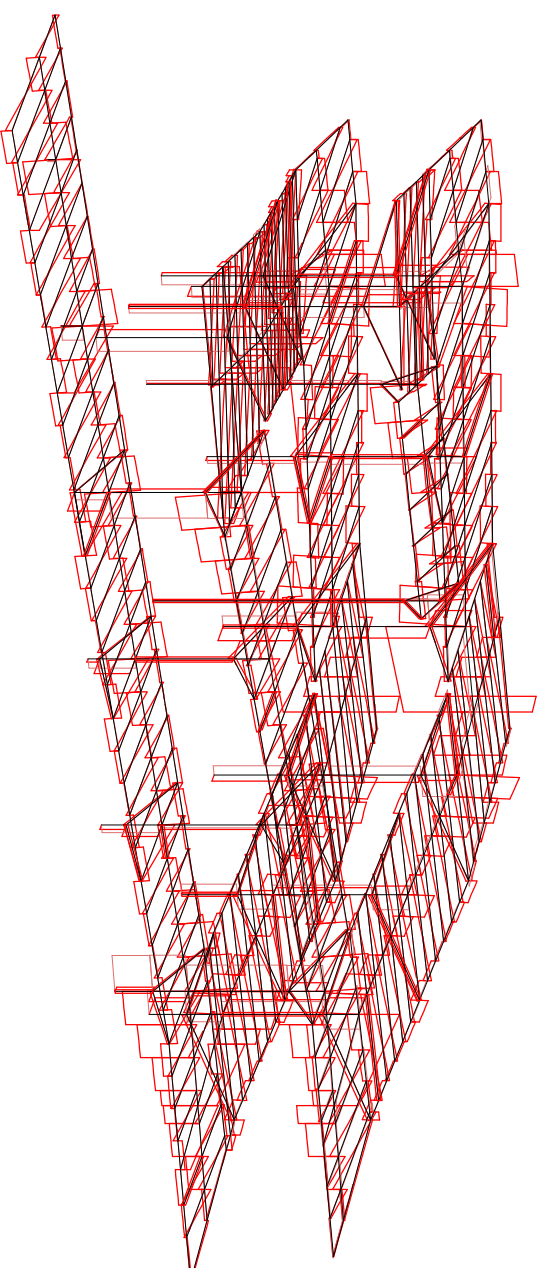

TALLANTS

DEFORMADA

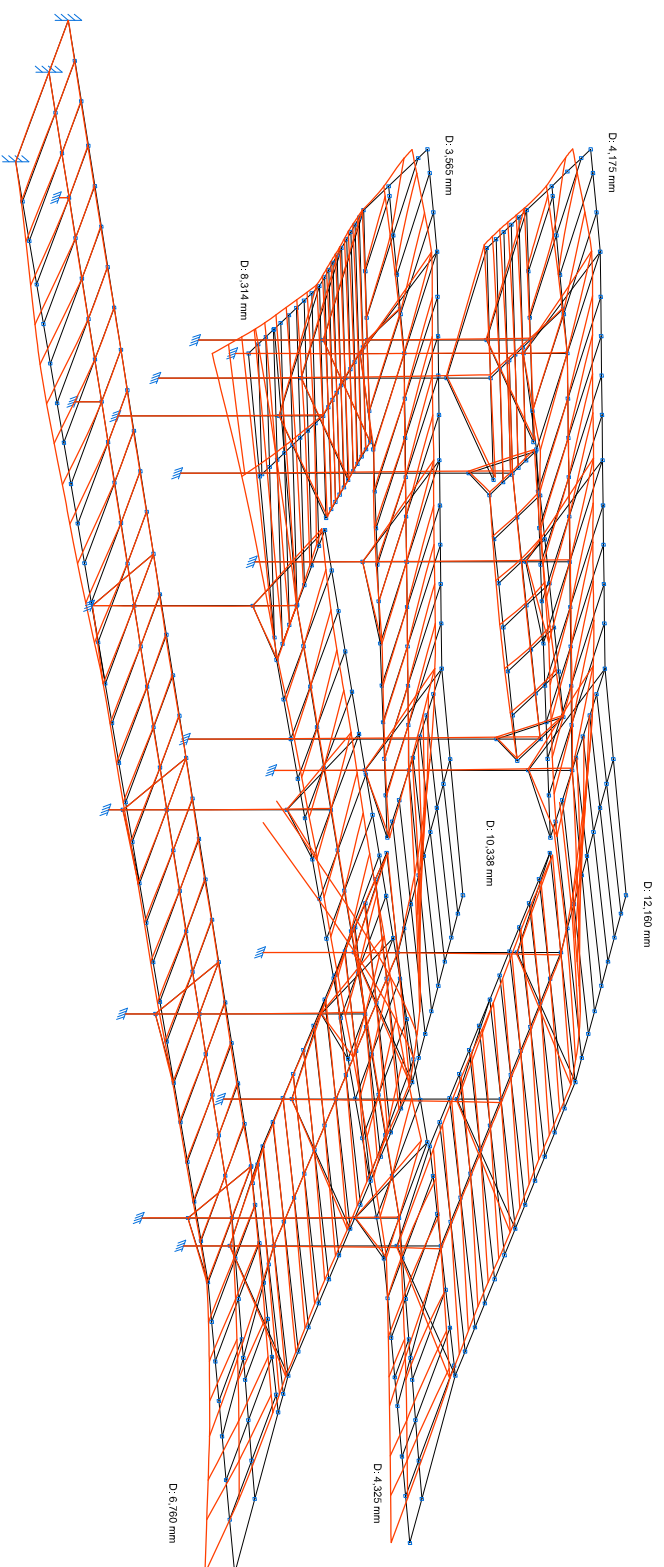

Ename	Tercera	N	Vy	Efectos positiu											
				Ed	Em	Ed	Em	Ed	Em	Ed	Em	Ed	Em		
N25/N25S	1230.40	43.649	0.000	9.141	1.150	14.651	-0.066	-28.189	0.703	0	0	0	0	0	0
N25/N25L	212.44	7.571	1.003	3.689	0.167	2.600	0.006	5.797	-4.053	0	0	0	0	0	0
N27/N10	1516.37	54.040	1.999	11.473	0.746	17.772	-0.007	-9.807	-4.106	0	0	0	0	0	0
N28/N23S	206.59	6.098	0.000	3.247	-0.177	-3.830	0.013	-3.908	0.073	0	0	0	0	0	0
N43/N44S	395.85	7.338	1.003	12.800	0.835	2.478	-0.019	-1.448	-3.377	0	0	0	0	0	0
N43/N44L	1342.37	44.278	0.000	-4.196	0.106	15.448	0.041	-28.073	3.348	0	0	0	0	0	0
N45/N40S	34.326	12.237	0.000	-7.726	-0.483	3.307	0.017	11.405	11.116	0	0	0	0	0	0
N45/N40L	115.67	4.119	0.000	-0.817	-0.189	-0.181	0.007	5.387	-0.092	0	0	0	0	0	0
N10/N11S	384.43	14.650	1.000	0.219	-0.029	-4.680	0.006	14.287	0.014	0	0	0	0	0	0
N8/N15	532.78	18.937	0.000	19.260	0.130	-2.497	0.003	-4.202	1.298	0	0	0	0	0	0
N4/N7S	534.17	18.037	4.138	21.981	-0.013	3.637	0.013	-7.620	0.021	0	0	0	0	0	0
N18/N18S	803.37	28.543	0.000	-16.864	-0.019	-1.106	0.003	-2.686	0.039	0	0	0	0	0	0
N17/N16	308.80	11.059	0.000	15.177	-0.045	-2.263	0.001	-3.434	-0.076	0	0	0	0	0	0
N27/N25S	682.15	24.510	0.000	24.178	-0.211	-3.815	0.003	-7.629	-0.282	0	0	0	0	0	0
N27/N25L	541.39	19.284	3.861	19.097	-0.190	3.801	0.013	-7.661	0.073	0	0	0	0	0	0
N18/N18L	169.28	6.246	2.116	4.482	0.030	-1.792	0.003	-2.359	0.021	0	0	0	0	0	0
N10/N10S	101.82	3.629	0.000	3.782	0.029	-0.488	-0.006	-0.343	0.031	0	0	0	0	0	0
N13/N13S	863.37	30.862	4.141	-12.077	0.137	-0.299	0.019	0.624	-0.288	0	0	0	0	0	0
N11/N11S	673.20	23.056	0.000	-13.602	0.018	-0.520	0.001	-1.541	0.027	0	0	0	0	0	0
N18/N18L	900.37	28.545	0.000	-16.864	-0.019	-1.106	0.003	-2.686	-0.039	0	0	0	0	0	0
N18/N15S	299.35	10.688	2.832	-4.459	-0.129	0.288	-0.008	-0.088	0.226	0	0	0	0	0	0
N15/N15S	2031.63	72.033	0.000	-23.146	0.137	-1.385	0.005	-4.333	0.284	0	0	0	0	0	0
N15/N15L	891.69	31.421	0.000	-20.204	0.026	-0.402	0.006	-1.102	0.027	0	0	0	0	0	0
N15/N15S	403.28	14.327	0.000	-9.516	-0.027	-0.875	0.006	-1.728	0.014	0	0	0	0	0	0
N15/N15L	427.80	15.022	0.000	-10.483	0.016	-0.626	-0.001	-1.664	0.011	0	0	0	0	0	0
N10/N10S	101.82	3.629	0.000	3.782	0.029	-0.488	-0.006	-0.343	0.031	0	0	0	0	0	0
N27/N27L	626.53	22.328	2.268	0.256	-4.206	1.386	-0.022	-1.425	0.237	0	0	0	0	0	0
N28/N16S	636.18	22.672	3.172	0.014	0.009	1.793	-0.288	-1.657	-0.014	0	0	0	0	0	0
N22/N23S	602.53	21.473	0.000	-0.061	0.045	-1.787	-0.274	-1.483	0.080	0	0	0	0	0	0
N24/N24L	756.33	26.654	0.000	-0.033	-0.081	-1.984	0.203	-1.891	-1.198	0	0	0	0	0	0
N28/N16S	819.62	29.188	2.268	0.000	0.000	1.917	-0.003	-2.286	0.000	0	0	0	0	0	0
N28/N16L	527.60	18.803	2.666	0.313	0.002	1.841	-0.035	-1.432	0.001	0	0	0	0	0	0
N45/N40S	561.72	20.018	0.000	-0.104	0.089	-1.678	-0.120	-1.356	0.135	0	0	0	0	0	0
N45/N40L	115.97	4.119	0.000	-0.817	-0.189	-0.181	0.007	5.387	-0.092	0	0	0	0	0	0

COMPROVACIONS:

- P-1= N76/N140
- P-2= N127/N143
- P-3= N118/N146
- P-4= N129/N147
- P-5= N87/N153
- P-6= N127/N150
- P-7= N86/N154
- P-8= N135/N158
- P-9= N137/N161
- B-1= N262/N265
- B-2= N27/N250
- B-3= N379/N110
- B-4= N320/N323
- B-5= N443/N446
- B-6= N85/N397
- B-7= N505/N502
- B-8= N465/N468
- B-9= N510/N513
- J-1= N53/N35
- J-2= N44/N15
- J-3= N148/N48
- J-4= N117/N116
- J-5= N97/N155
- J-6= N23/N87
- J-7= N104/N80
- J-8= N28/N89
- J-9= N109/N62
- M-1= N138/N33
- M-2= N141/N19
- M-3= N148/N48
- M-4= N149/N15
- M-5= N151/N56
- M-6= N152/N23
- M-7= N157/N88
- M-8= N158/N13
- M-9= N109/N62
- N-1= N276/N274
- N-2= N308/N165
- N-3= N522/N523
- N-4= N341/N342
- N-5= N395/N184
- N-6= N501/N502
- N-7= N462/N463
- N-8= N465/N468

P.: pillar
 B.: biga Vdd
 J.: jassera
 M.: mensula
 b.: bigues

TRANSFORMACIONS

Tutor: Enric Massip
 Matriuella Bettemun i Ardil PFG-OP 08/07

