

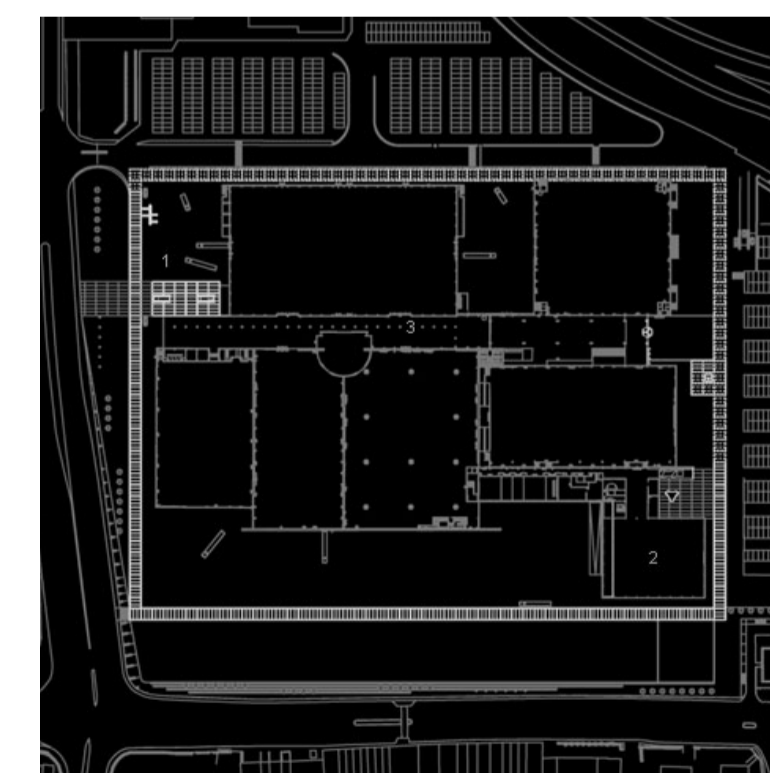

EXTRAMURAL CITY

FRAME

The entrance to the exposition hall is accented by an office building that adopts the structure of the frame. **The frame redefines the exposition site as a clear whole, delineating its place in the urban fabric. The frame is a gallery that imposes order on the entrances, passages, parking, and logistics.** It gives the XPO site a recognizable façade that mediates between the scale of the visitor, that of the site, and that of the exhibition hall that it encloses. *



*TEXT AND IMAGE SOURCE: "XPO Gallery" by OFFICE, 2009

EXTRAMURAL
 RECOVERY OF AN INDUSTRIAL LANDSCAPE
 IN THE SUBURBS OF BARCELONA

TUTOR CLAUDI AGUILÓ
 MASTER THESIS JURY 7
 ETSAB JANUARY 2014

TONI
 POCH