

Enginyer Autor del Projecte: Ulric Celada Blesa 	Alternativa al Pont de la Gola del Llobregat Vial Port-Aeroport	Escala: Acotat	Data: 2013	Plànol nº: Alçat i planta del pont
				1

Secció AA'

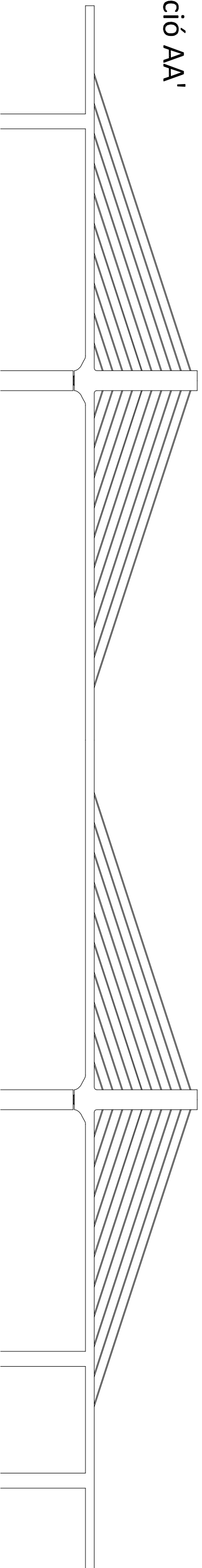

Secció BB'

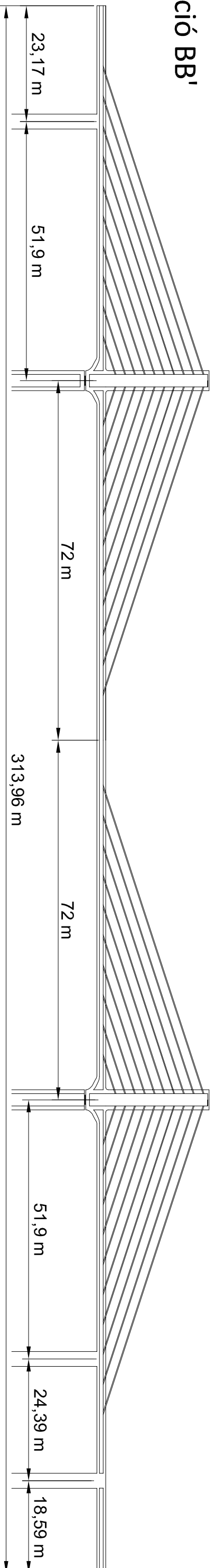

Secció CC'

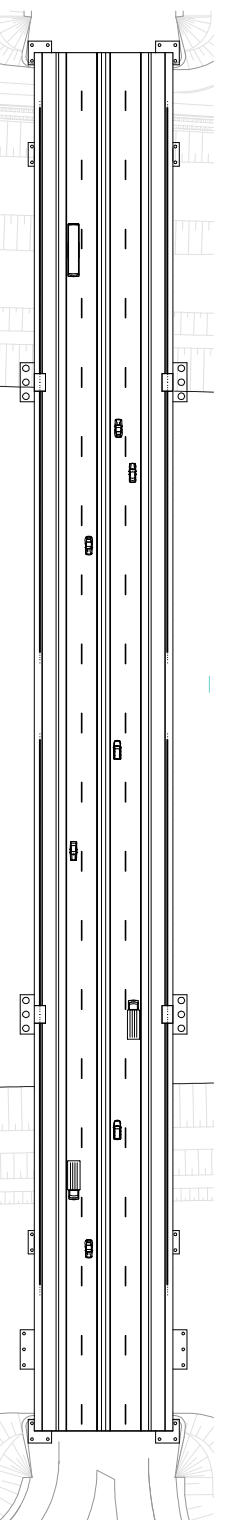
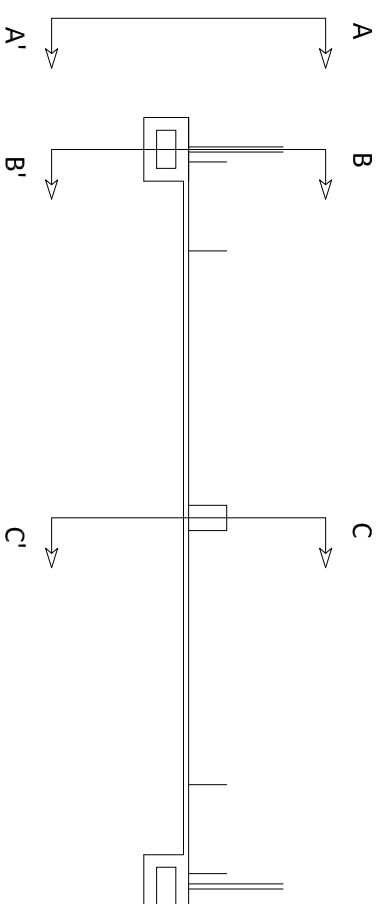
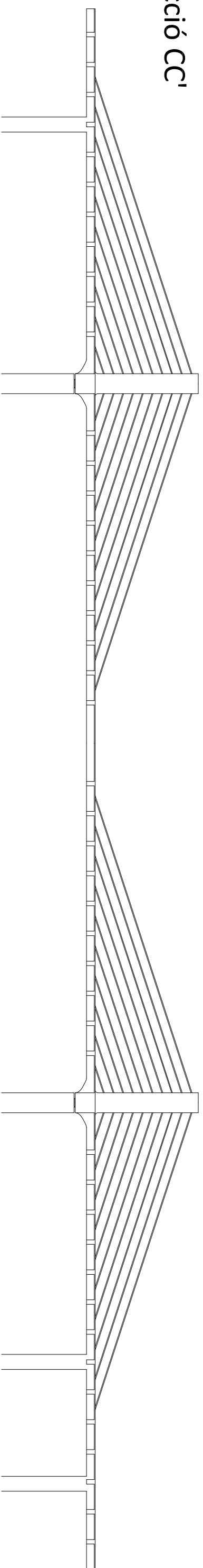

Enginyer Autor del Projecte:
Ulric Celada Blesa

Alternativa al Pont de la
Gola del Llobregat Vial
Port-Aeroport

Escala:
Acotat

Data:
2013

Plànol nº: 2
Alçats del pont amb tallis a les seccions AA', BB' i CC' amb línies discontinues del model numèric.

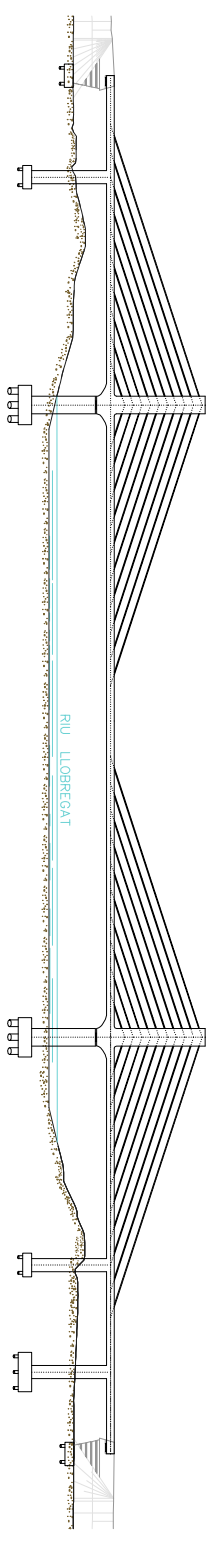
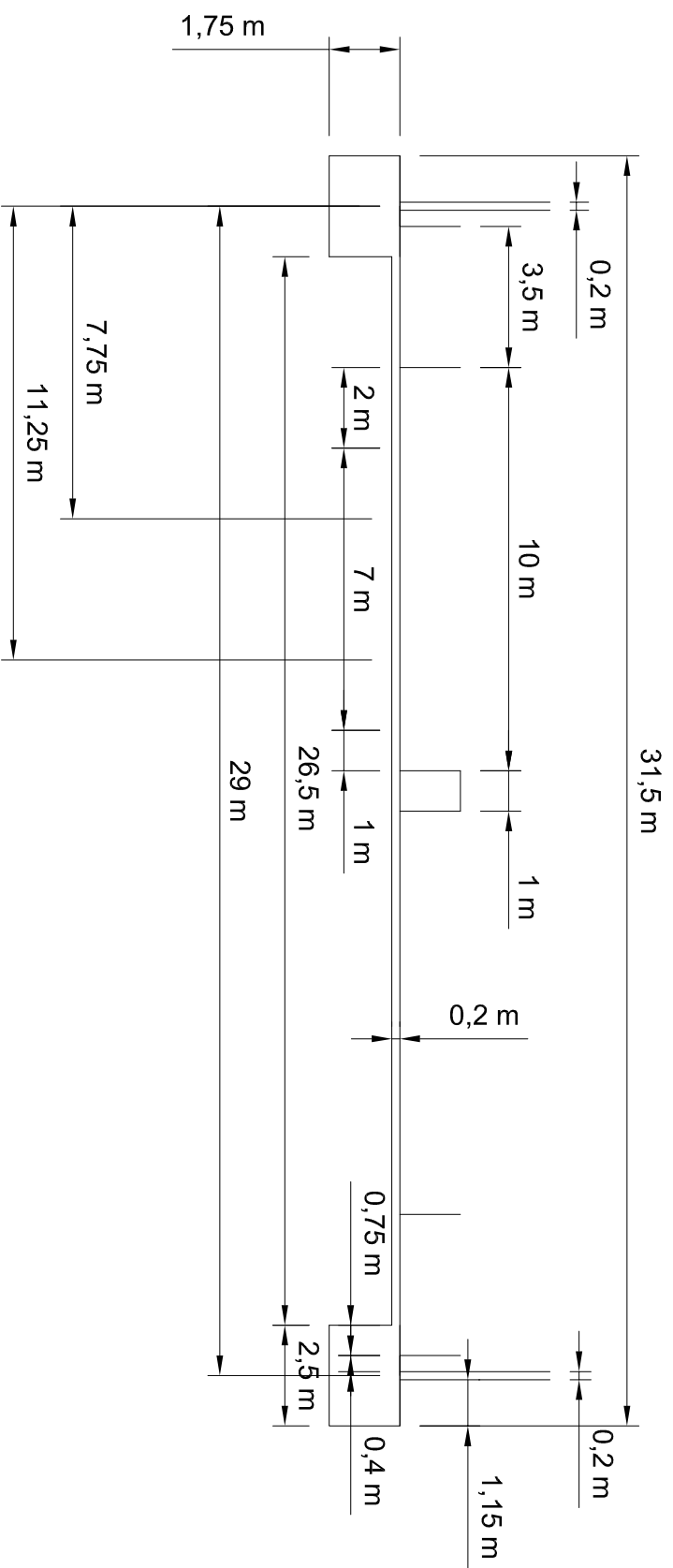
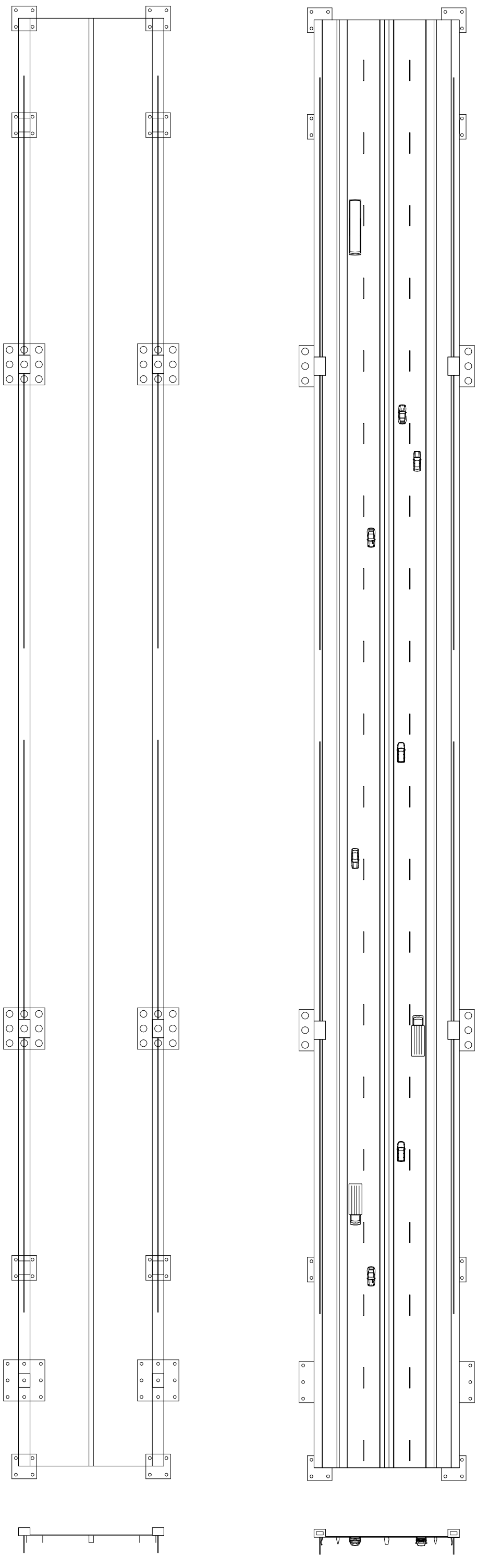

Enginyer Autor del Projecte:
 Ulric Celada Blesa
Ulric Celada Blesa

Alternativa al Pont de la
Gola del Llobregat Vial
Port-Aeroport

Escala:
 Acotat

Data:
 2013

Plànol nº:
 3

Planta del pont amb sobre estructura i transparent.
 Secció amb sobre estructura i acotacions

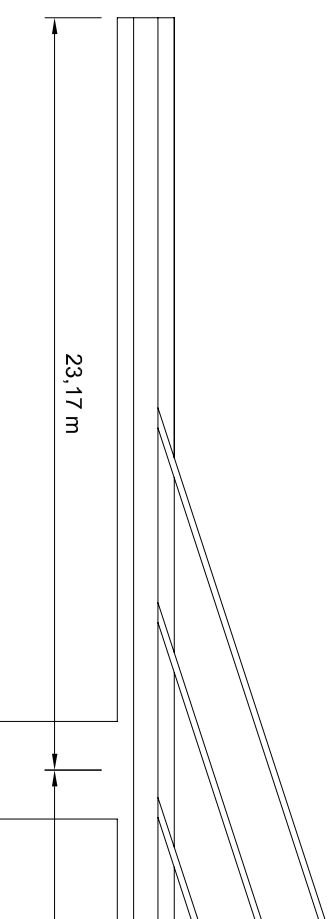
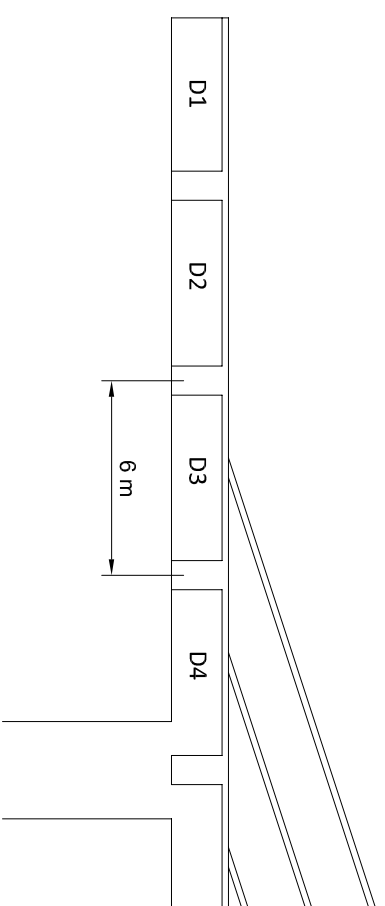

Dimensions bàsiques del finger

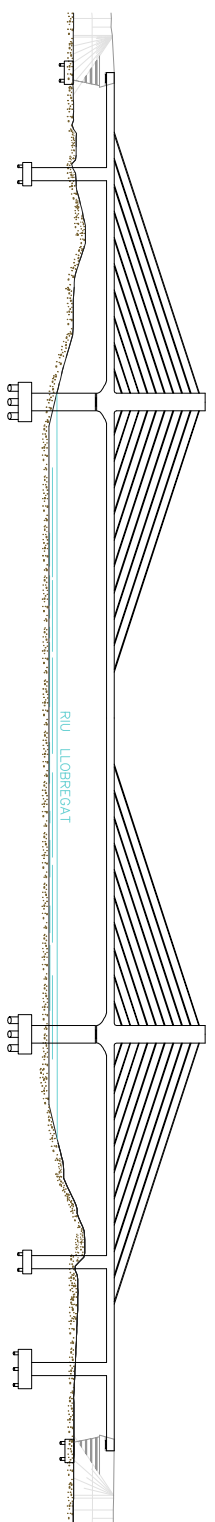
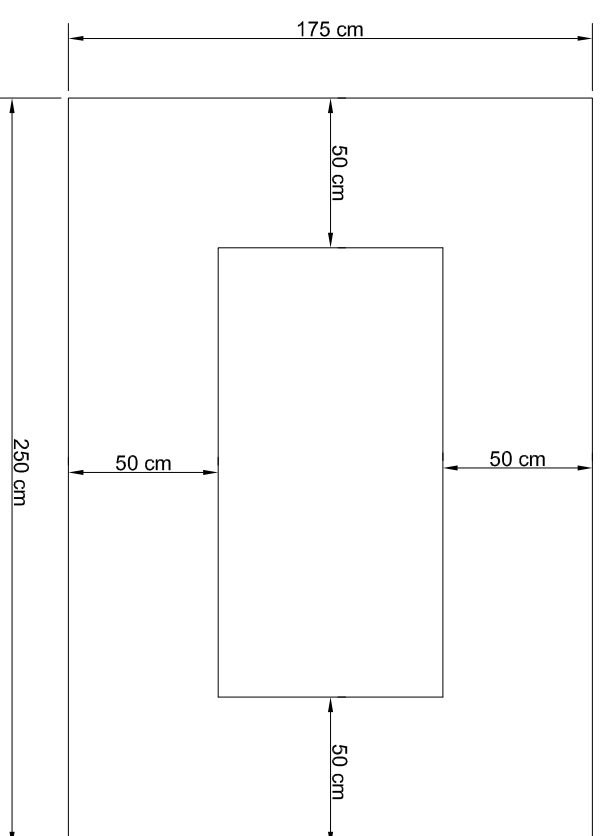

Dovella 1-4

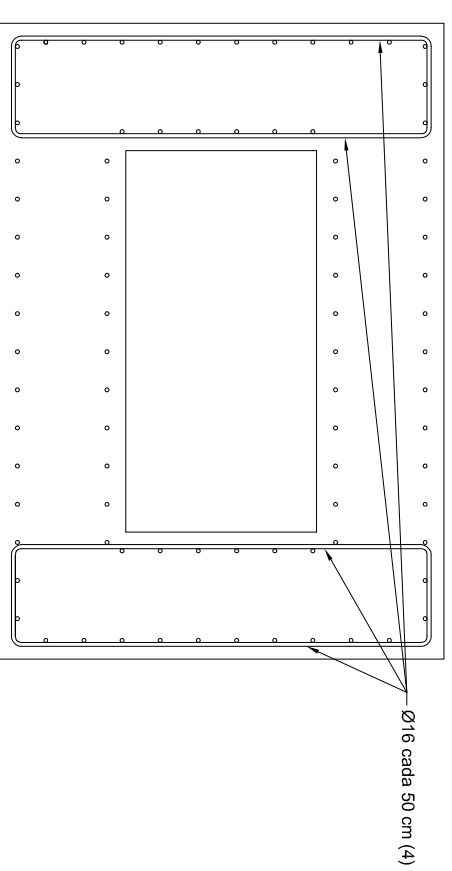
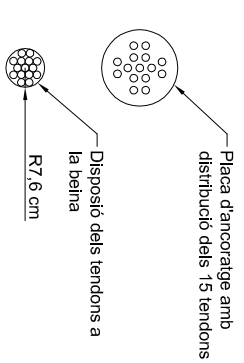
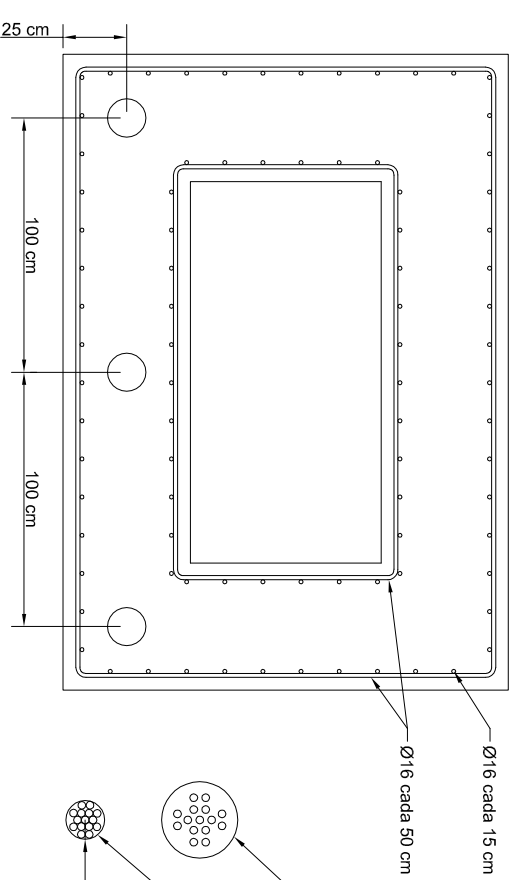

Enginyer Autor del Projecte:
Ulric Celada Blesa

Alternativa al Pont de la
Gola del Llobregat Vial
Port-Aeroport

Escala:
Acotat

Data:
2013

Plànol nº: 4
Detalls dels fingers de la zona:
Estrep Pila Prat

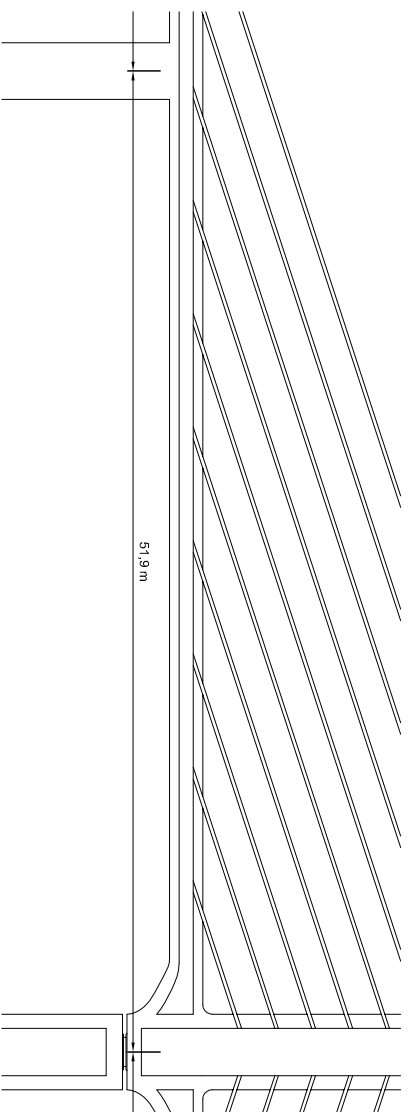
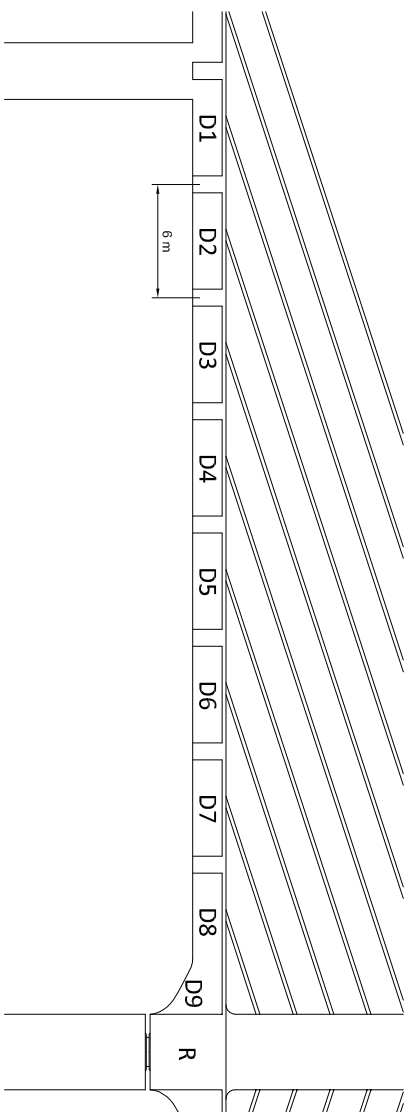

Dimensions bàsiques del finger

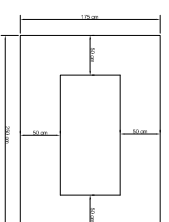

Dimensions del finger a prop de la torre

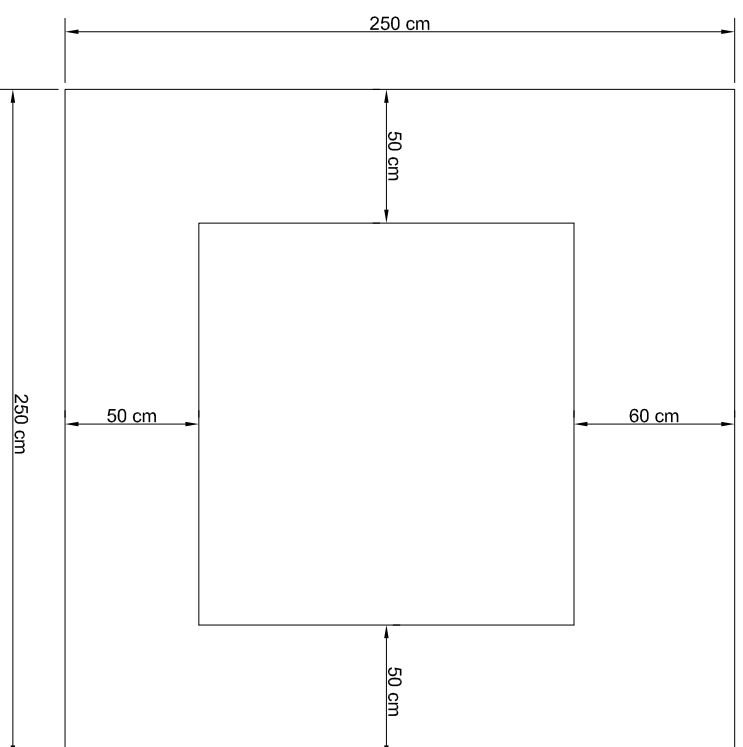

Dovella 1-6

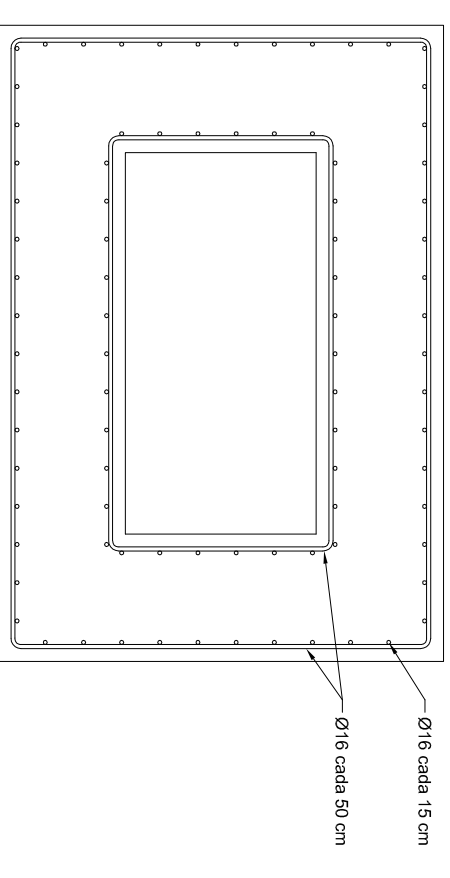

Dovella 7

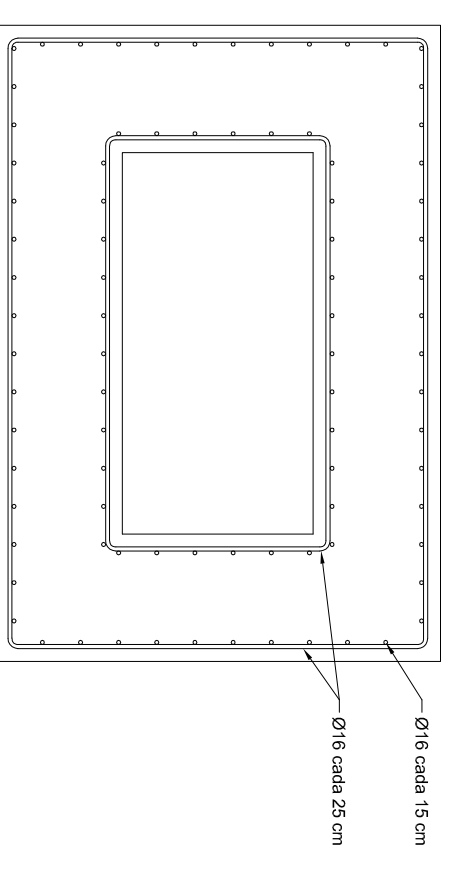

Dovella 8

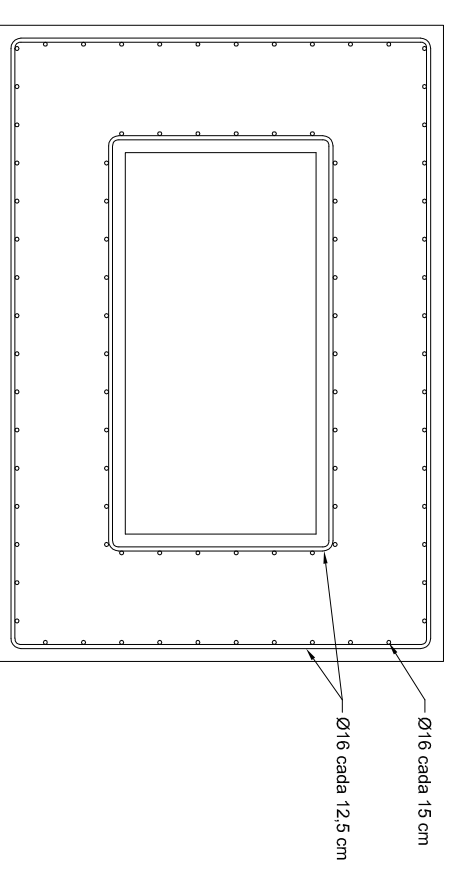

Dovella 9

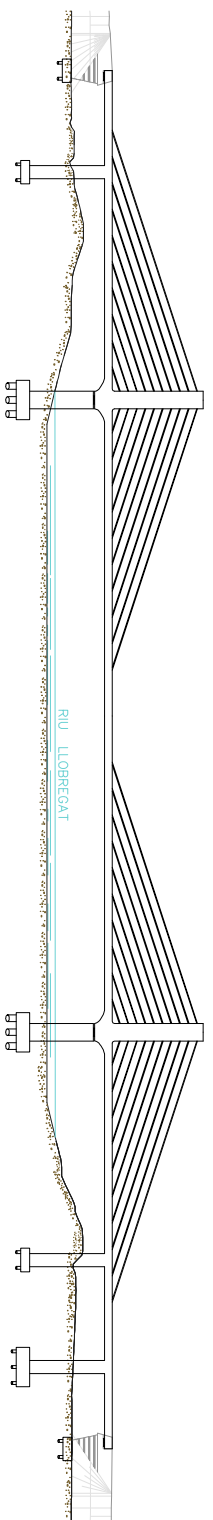
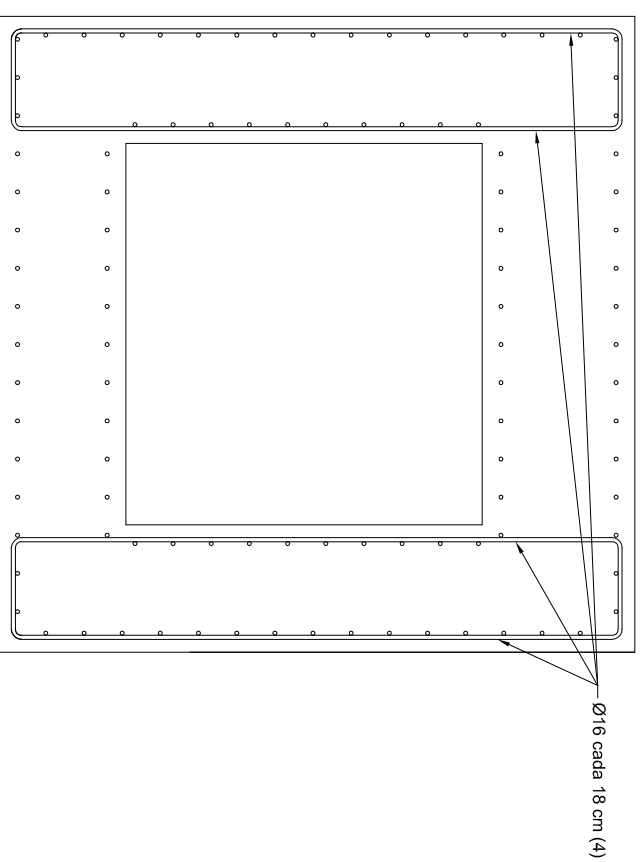
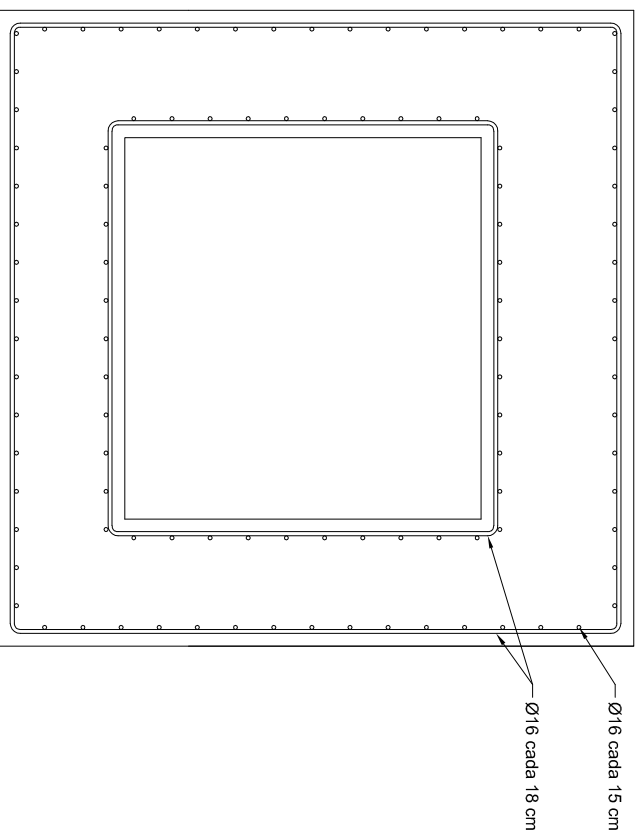

Enginyer Autor del Projecte:
Ulric Celada Blesa

Alternativa al Pont de la
Gola del Llobregat Vial
Port-Aeroport

Escala:
Acotat

Data:
2013

Plànol nº: 5
Detalls dels fingers de la zona:
Pila Torre Prat

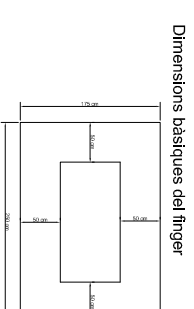
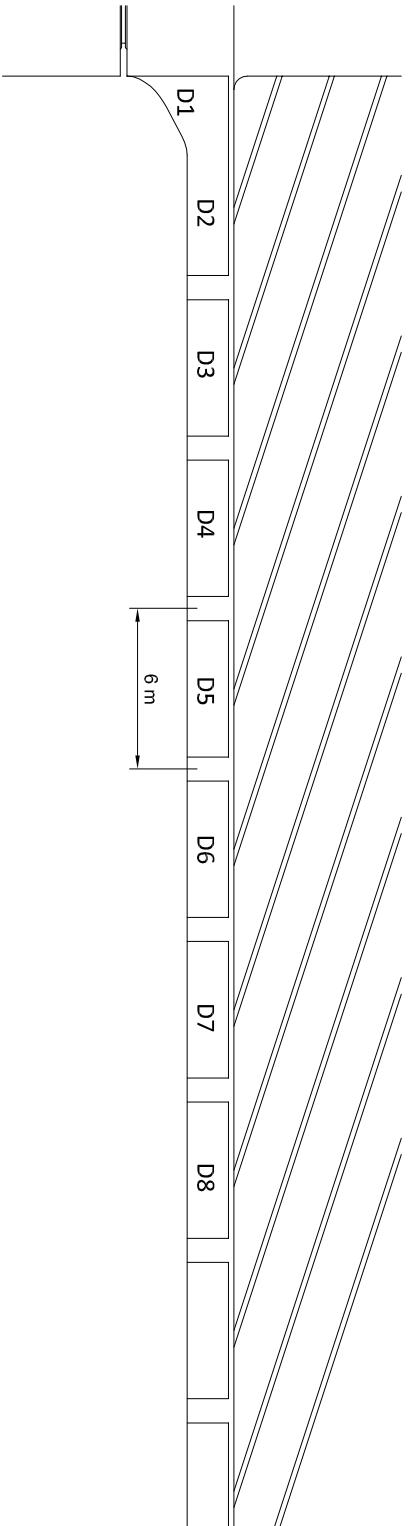

Dimensions bàsiques del finger

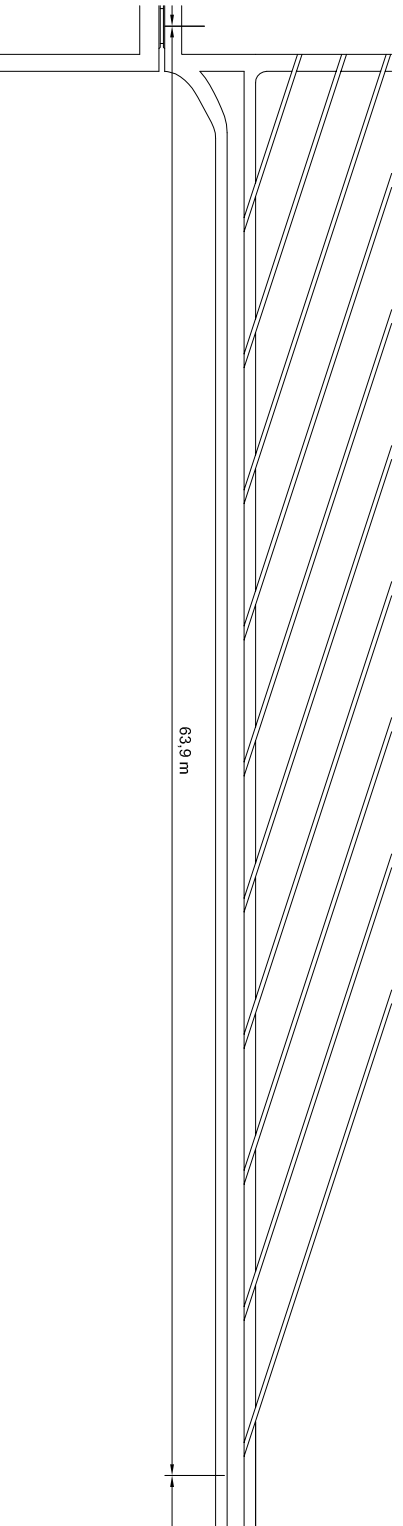

Dimensions del finger a prop de la torre

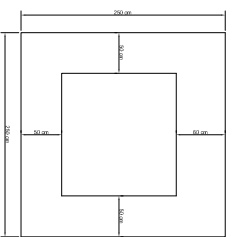

Dovella 2

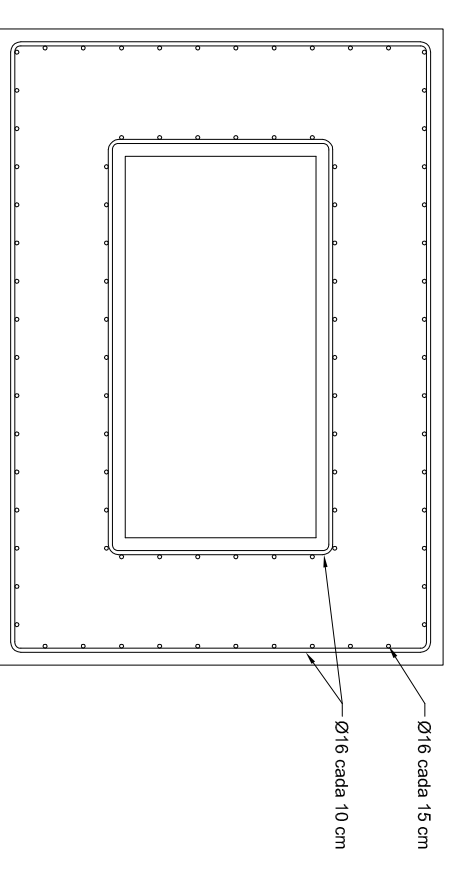

Dovella 3

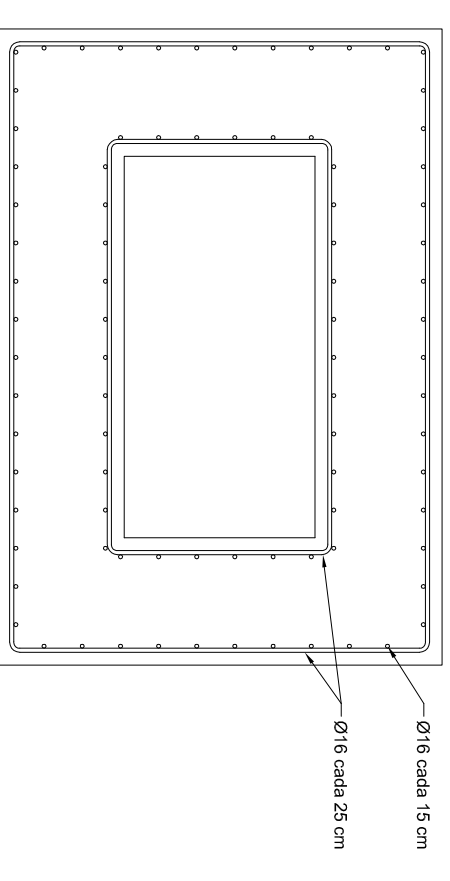

Dovella 4-8

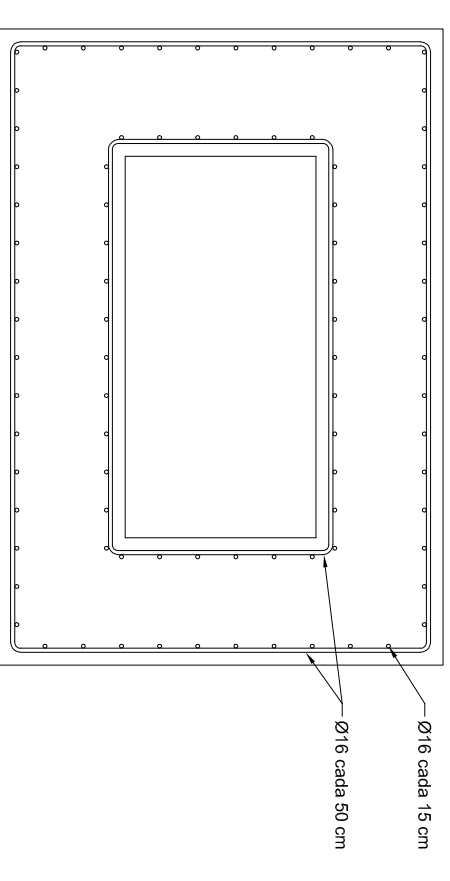

Dovella 1

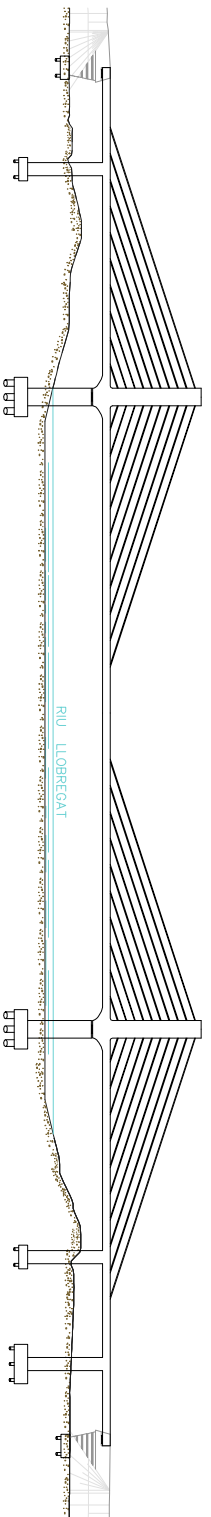
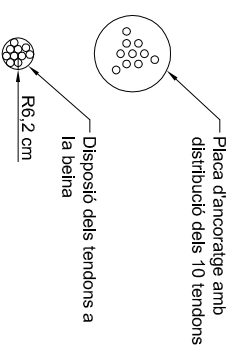
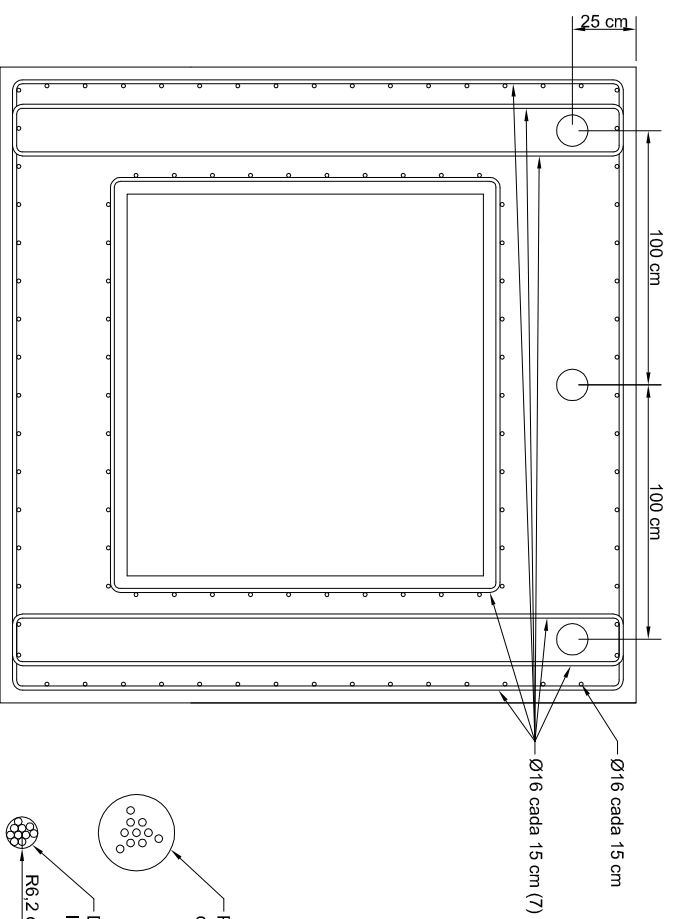

Enginyer Autor del Projecte:
Uric Celada Blesa

Alternativa al Pont de la
Gola del Llobregat Vial
Port-Aeroport

Escala:
Acotat

Data:
2013

Plànol nº:
6
Detalls dels fingers de la zona:
Torre Centre Llum Prat

Algat seccions BB' i CC':

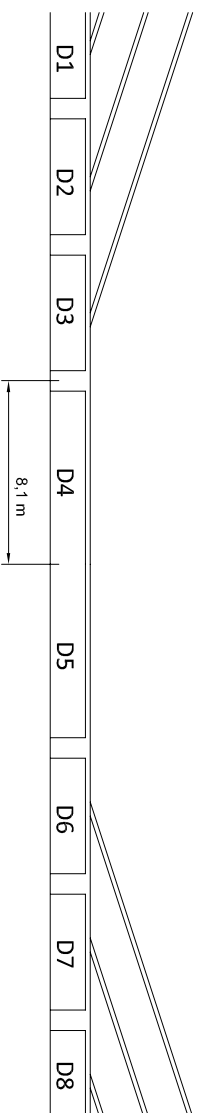

Dimensions bàsiques del finger

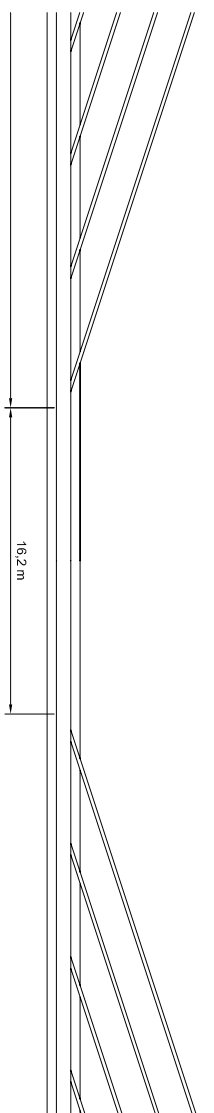
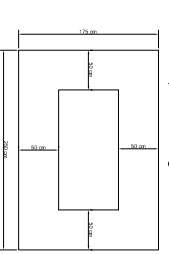

Dovella 2,3,6, i 7

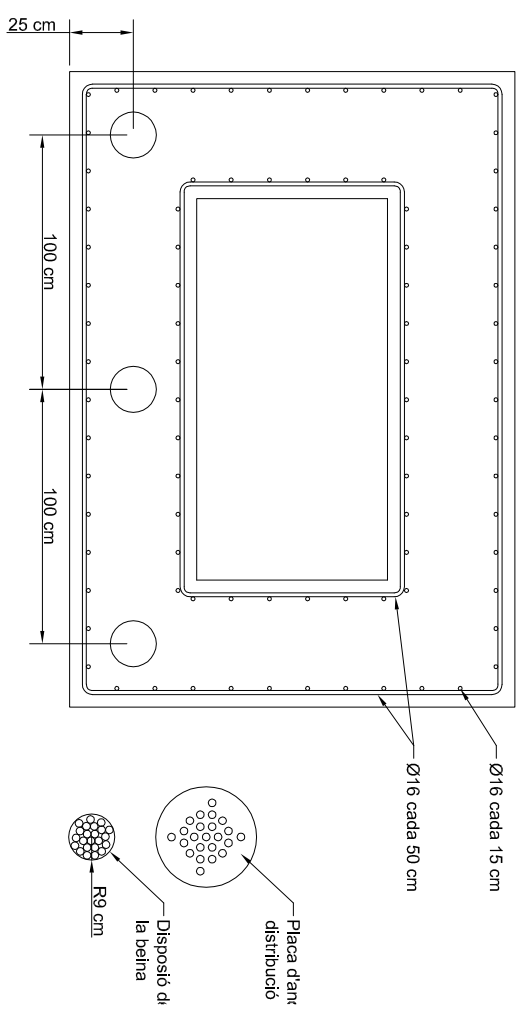

Dovella 1 i 8

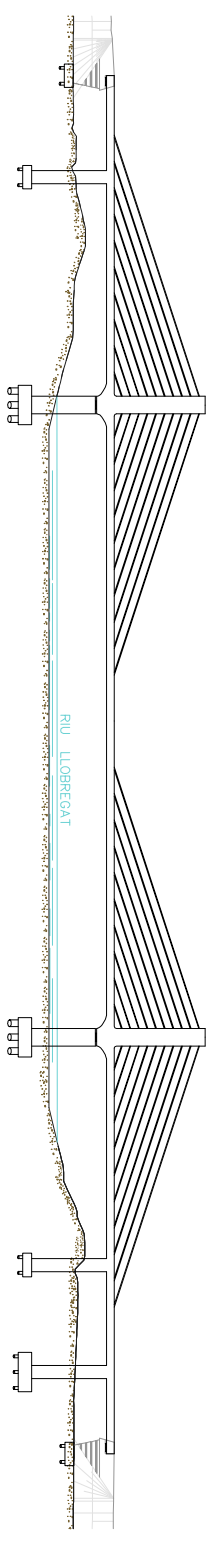
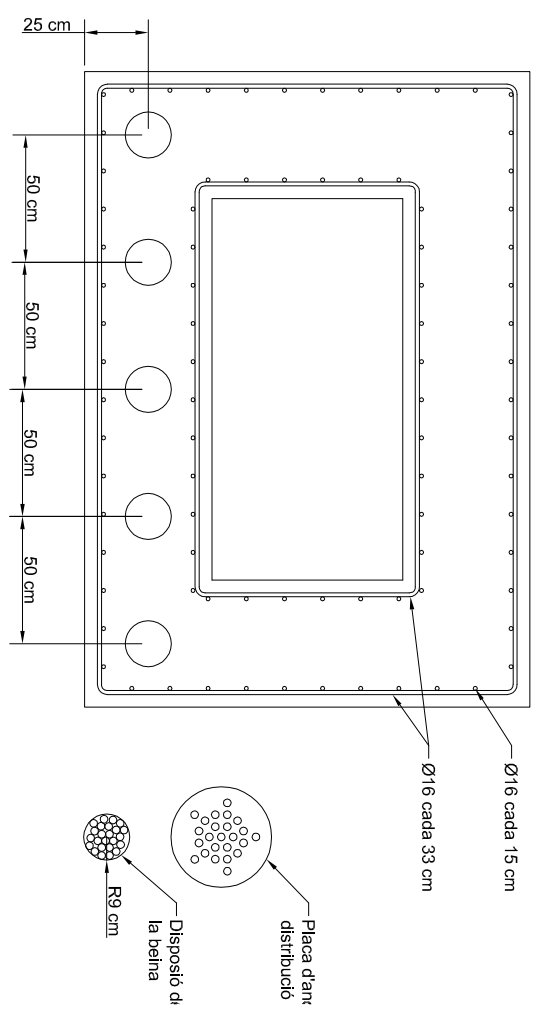
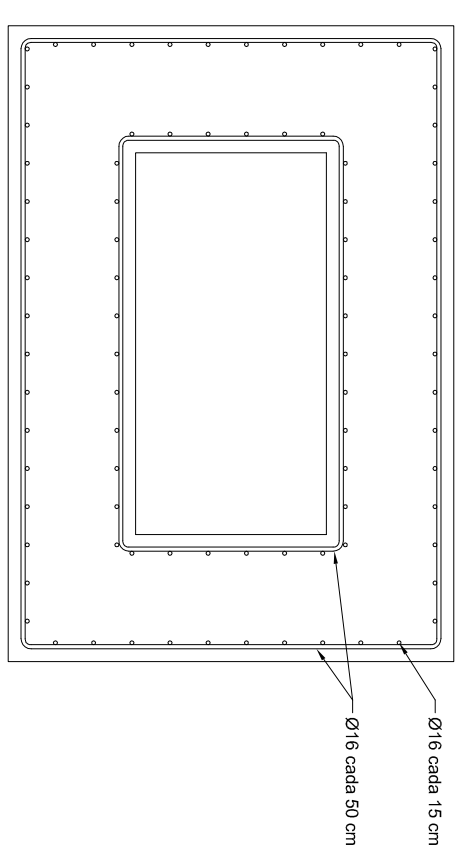

Enginyer Autor del Projecte: Ulric Celada Blesa	Alternativa al Pont de la Gola del Llobregat Vial Port-Aeroport	Escala: Acotat	Data: 2013	Plànol nº: 7
				Detalls dels fingers de la zona: Centre Llum

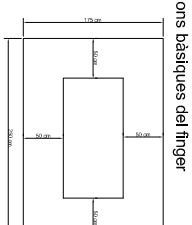
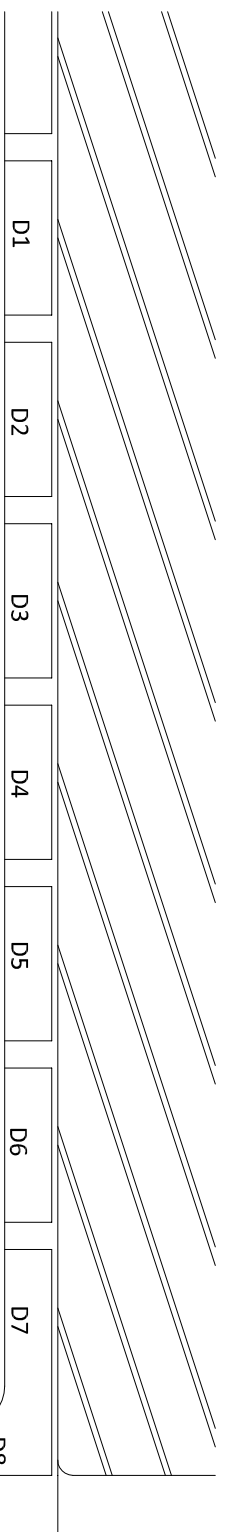

Dimensions bàsiques del finger

Dovella 1-5

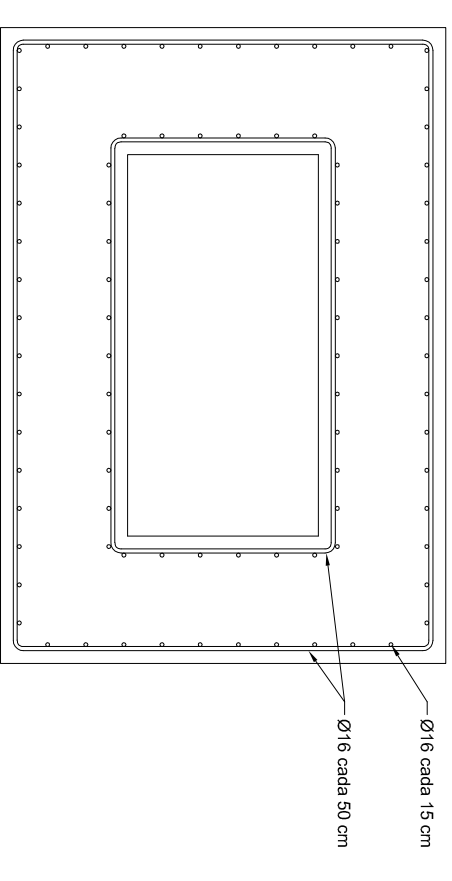

Dovella 6

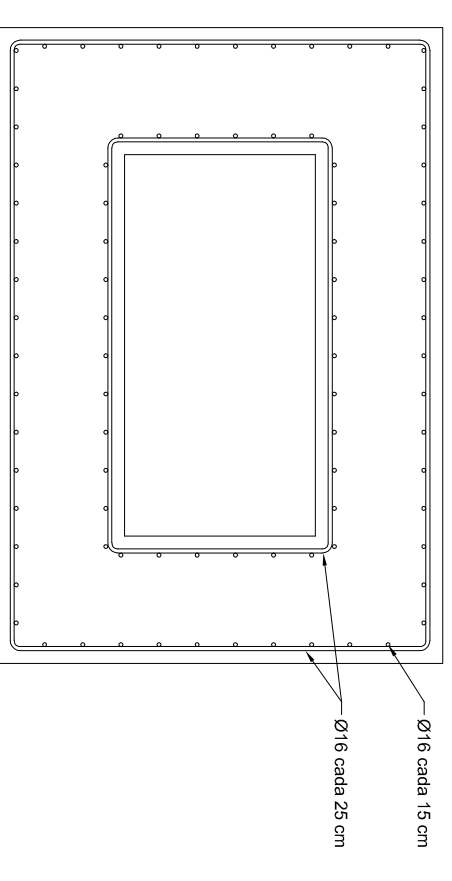

Dovella 7

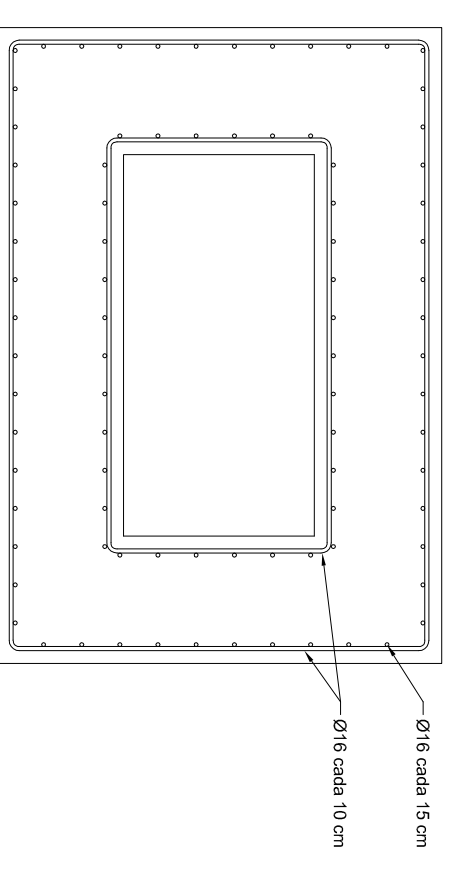

Dovella 8

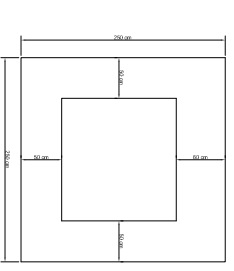
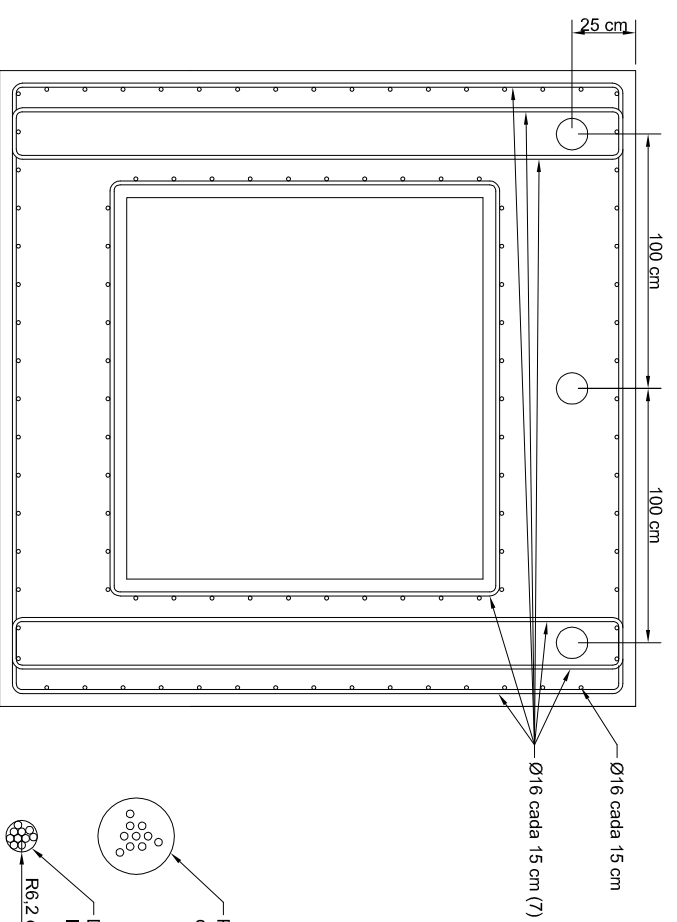

Dimensions del finger a prop de la torre

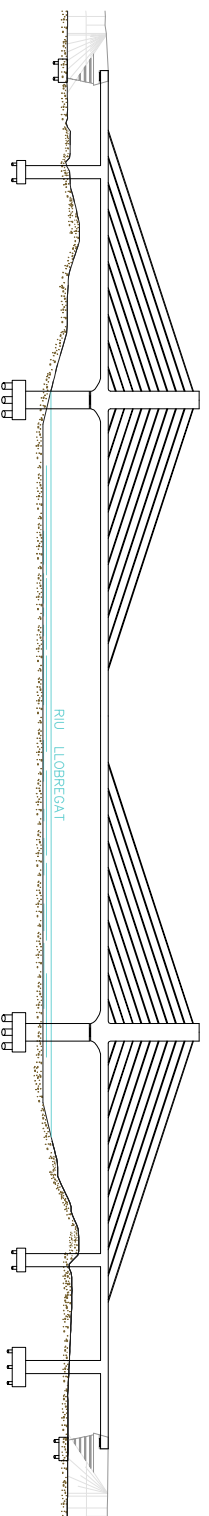
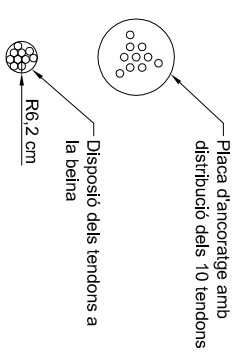

Enginyer Autor del Projecte:

Uriac Celada Blesa

Alternativa al Pont de la Gola del Llobregat Vial Port-Aeroport

Escala:

Acotat

Data:

2013

Plànol nº: 8

Detalls dels fingers de la zona: Centre Llum Torre Barcelona

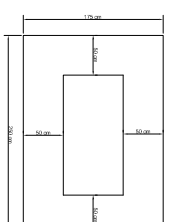
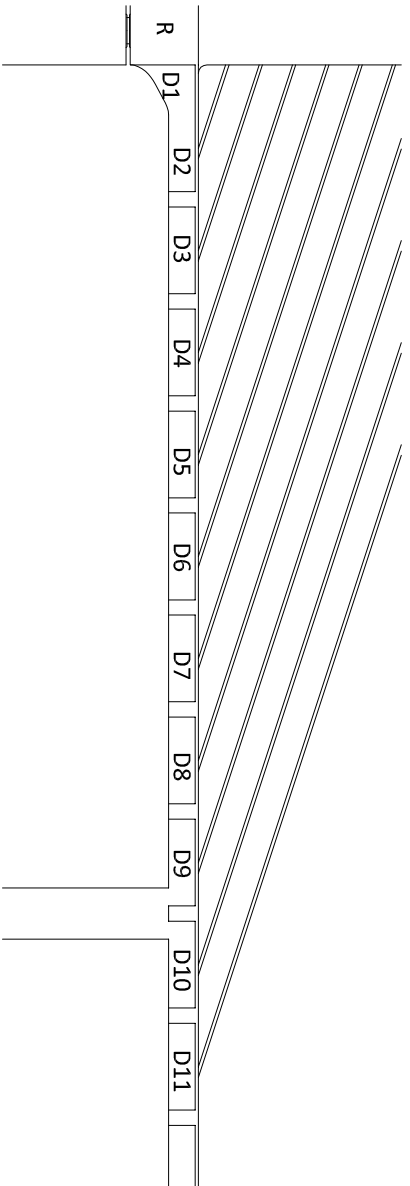

Dimensions bàsiques del finger

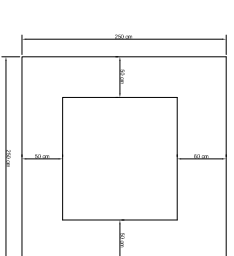
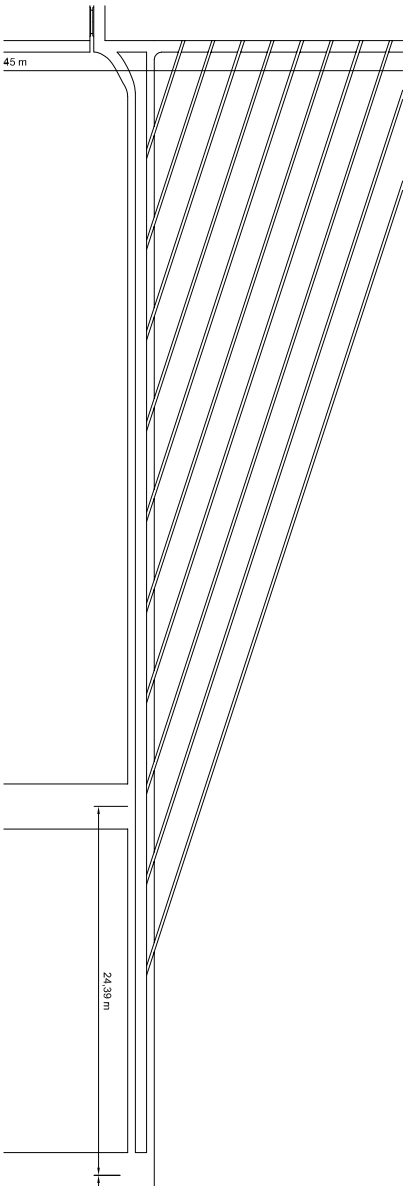

Dimensions del finger a prop de la torre

Dovella 2

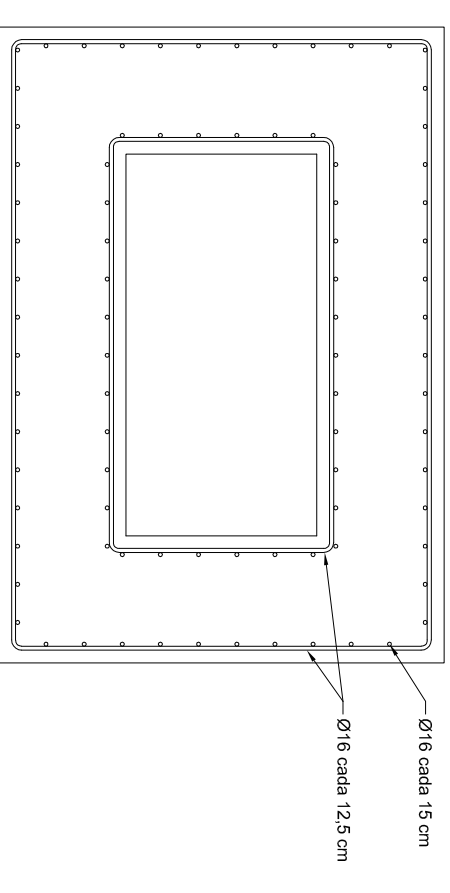

Dovella 3

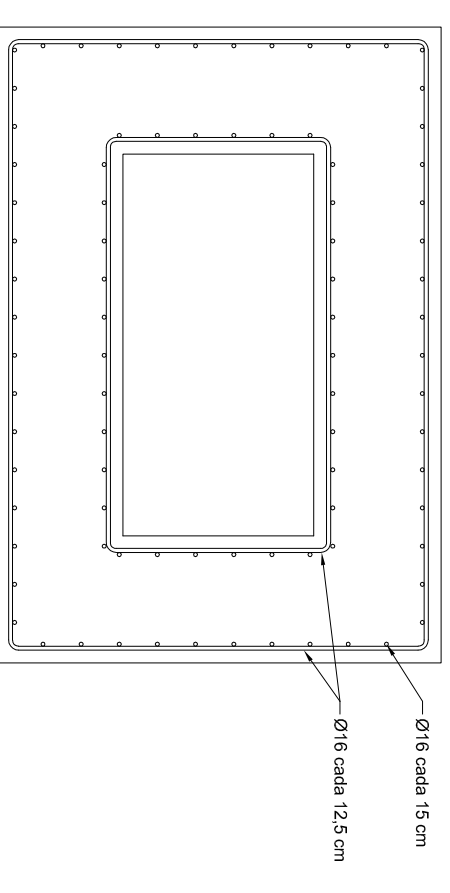

Dovella 1

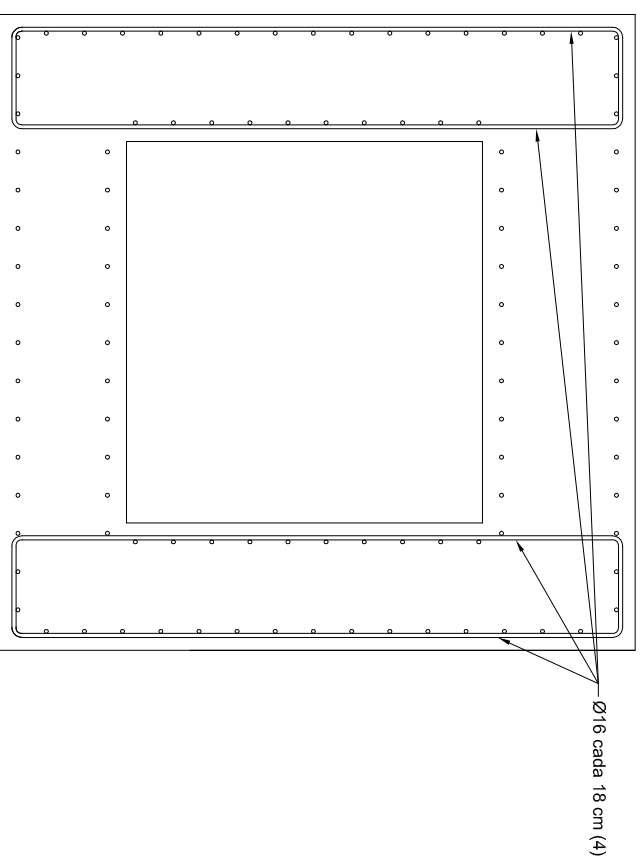
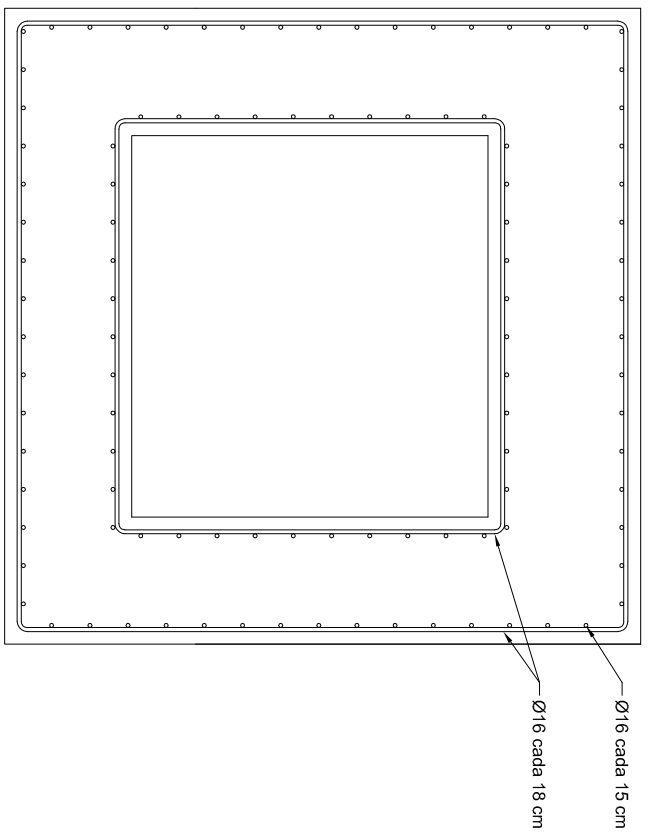

Dovella 4-11

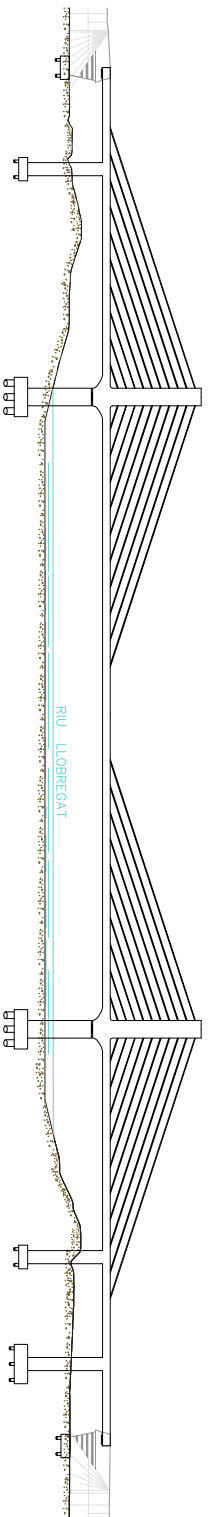
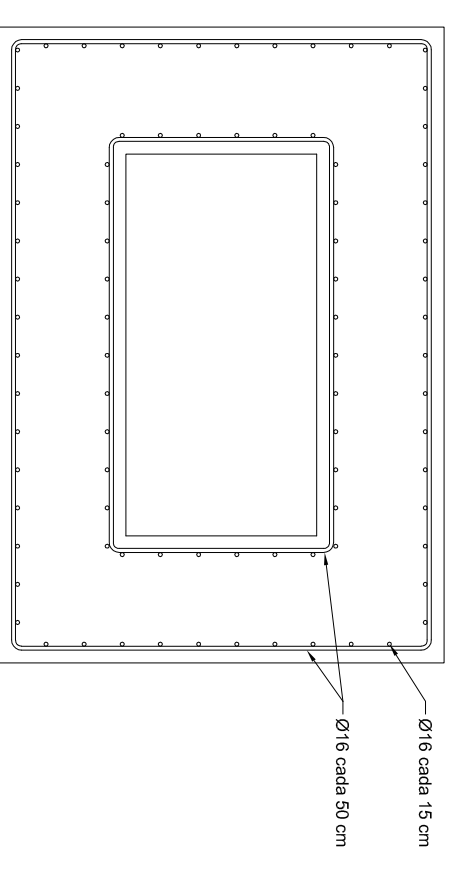

Enginyer Autor del Projecte:
Uric Celada Blesa

Alternativa al Pont de la
Gola del Llobregat Vial
Port-Aeroport

Escala:
Acotat

Data:
2013

Plànol nº:
9
Detalls dels fingers de la zona:
Torre Vila Barcelona

Dovella 1

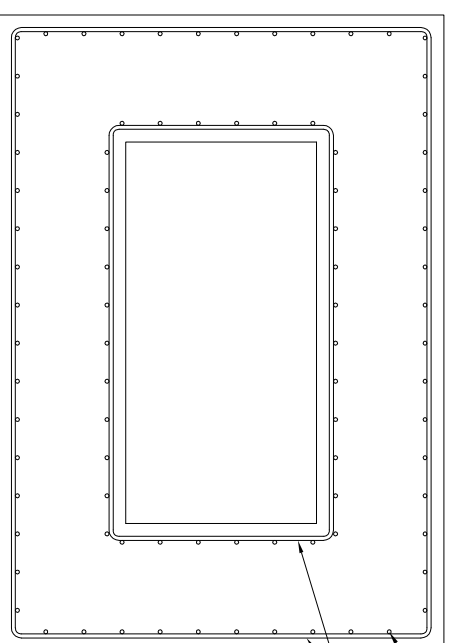
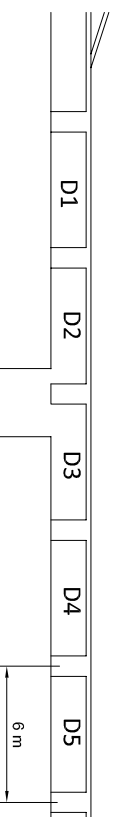

Ø16 cada 15 cm
Ø16 cada 33 cm

Dovella 4

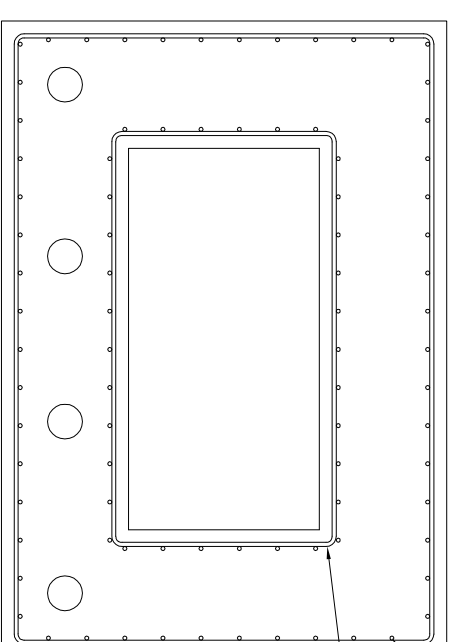

Ø16 cada 15 cm
Ø16 cada 50 cm

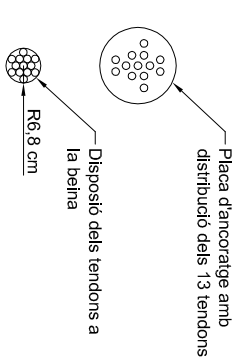

Dovella 2 i 3

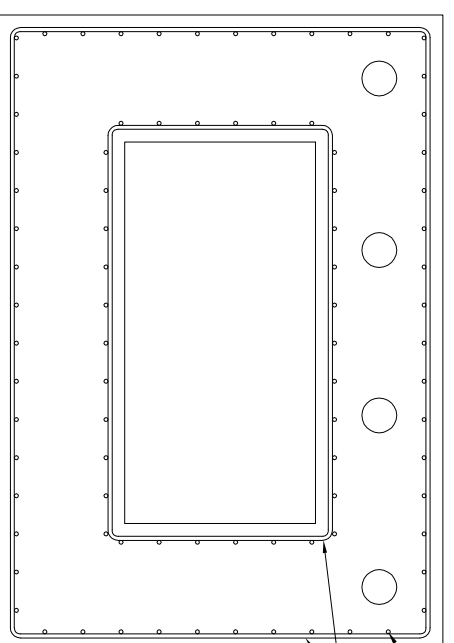
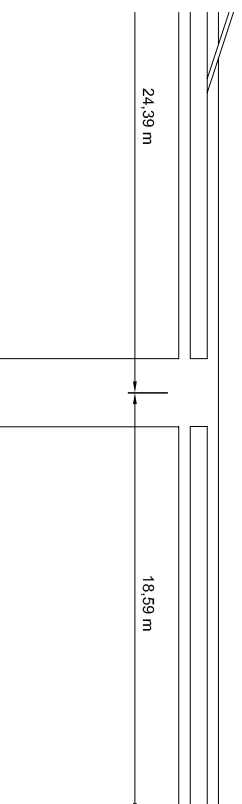

Ø16 cada 15 cm
Ø16 cada 20 cm

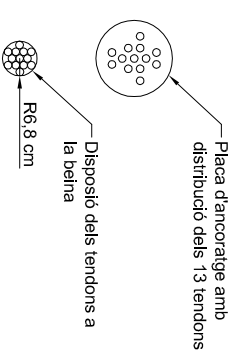

Dovella 5

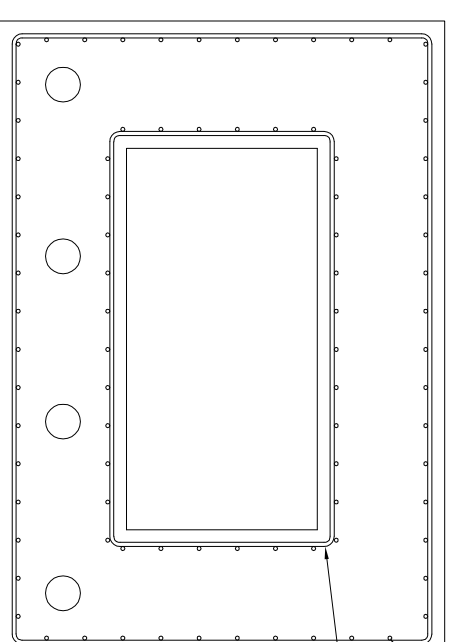

Ø16 cada 15 cm
Ø16 cada 40 cm

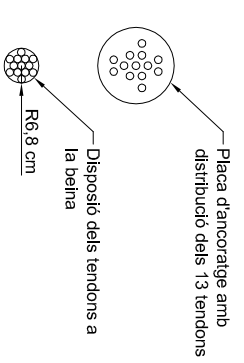

Dimensions bàsiques del finger

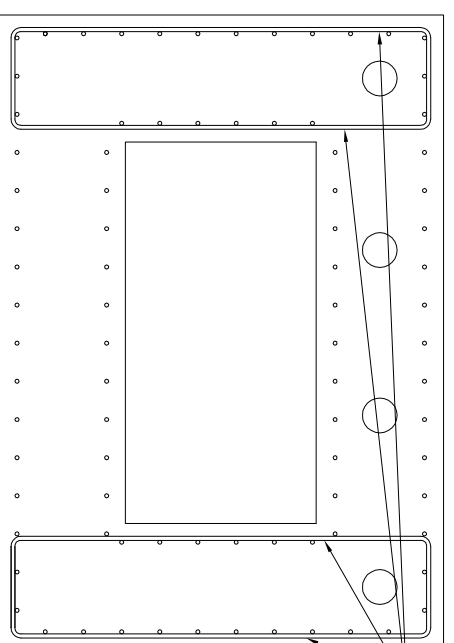
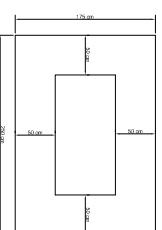

Ø16 cada 20 cm (4)

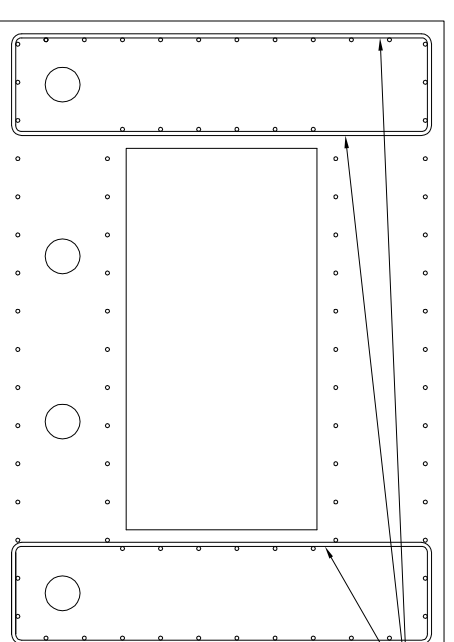

Ø16 cada 40 cm (4)

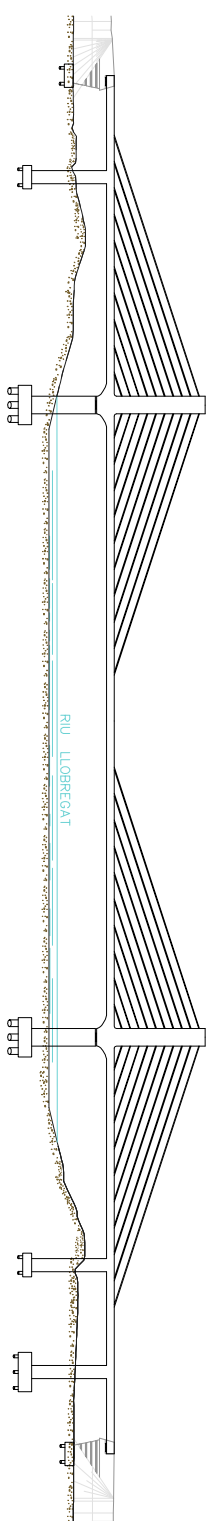

Enginyer Autor del Projecte:
Ulric Celada Blesa

Alternativa al Pont de la
Gola del Llobregat Vial
Port-Aeroport

Escala:
Acotat

Data:
2013

Plànol nº:
10
Detalls dels fingers de la zona:
Pila Estrep Barcelona

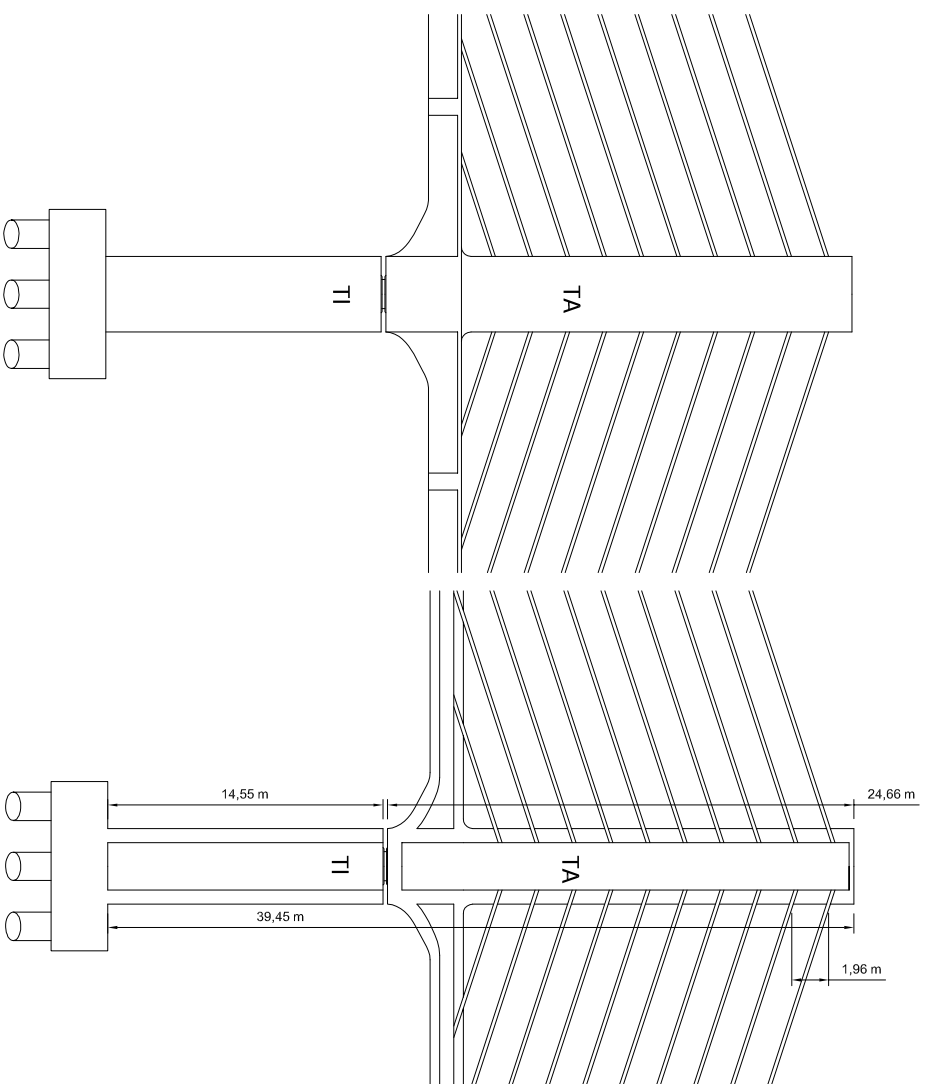

Torre

Ancoratges

Armat Genèric

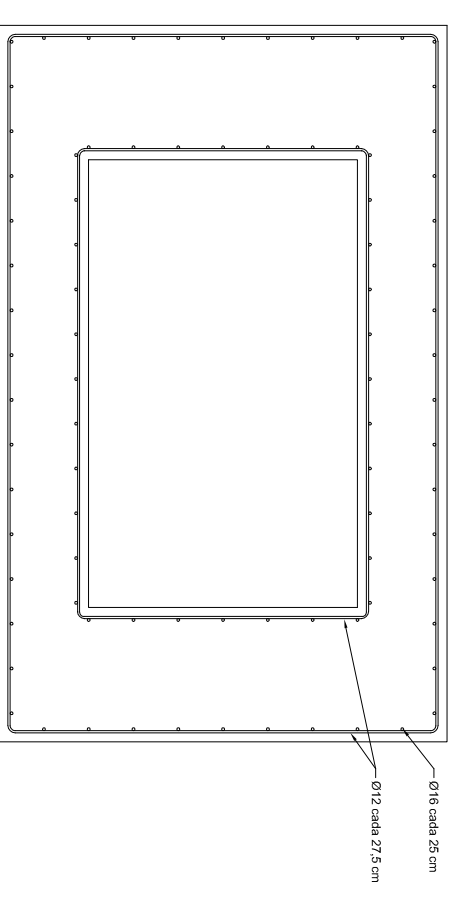
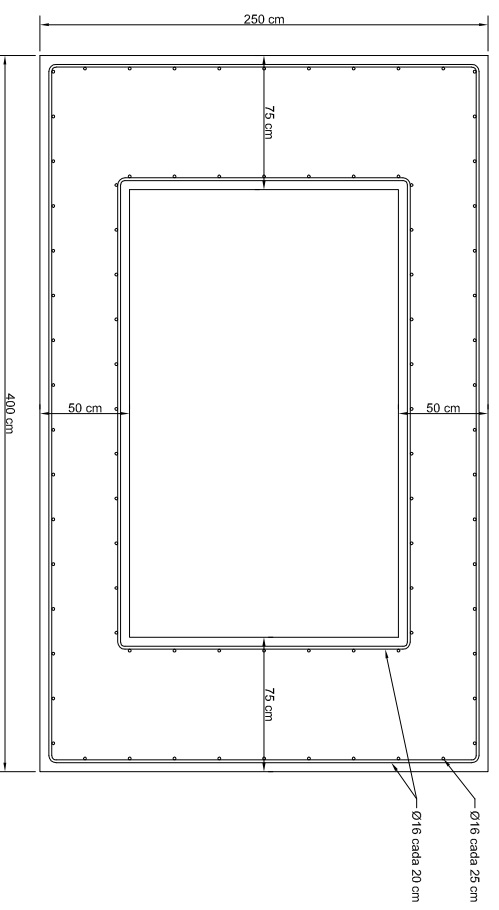

Part Inferior

Pila

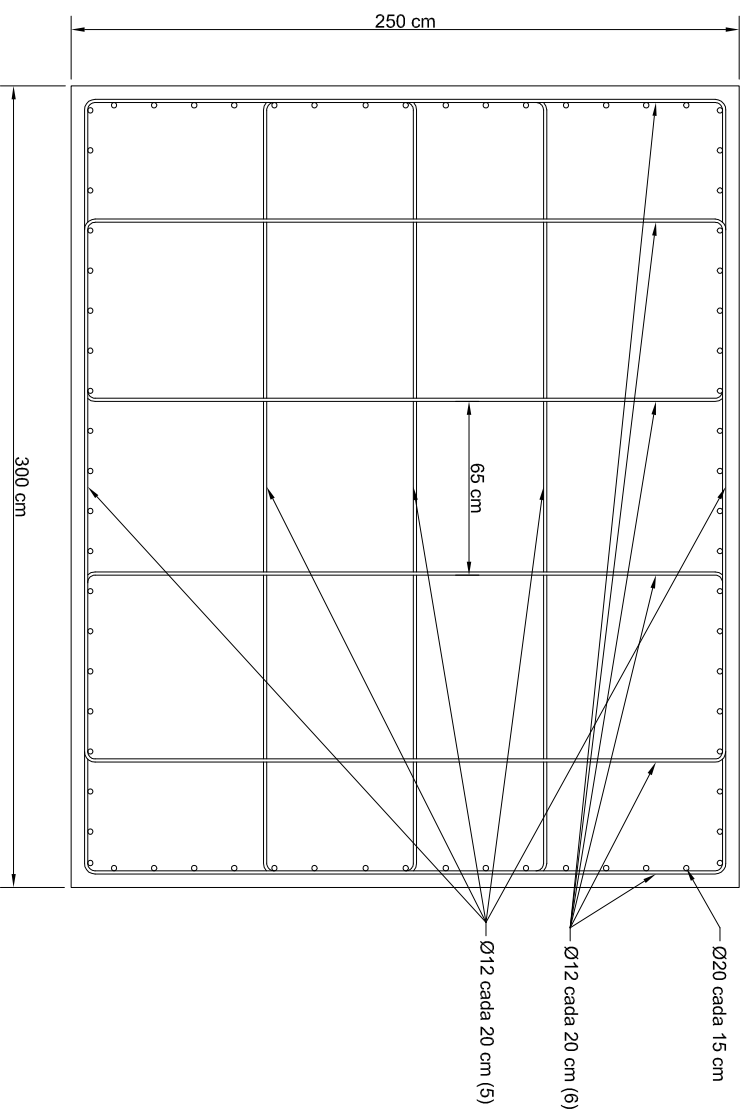

Armat Proper dels Tirants

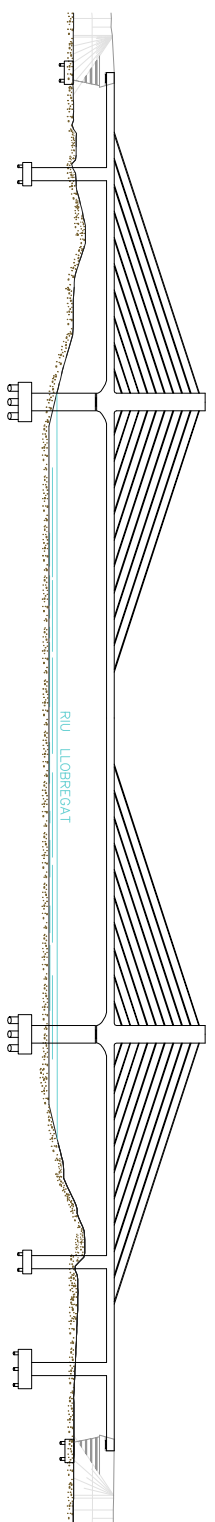
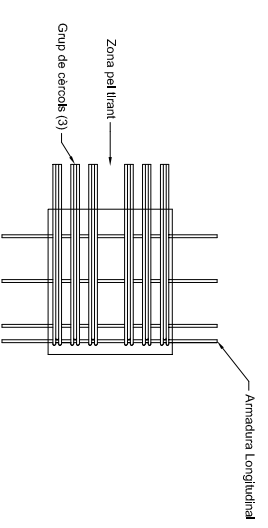
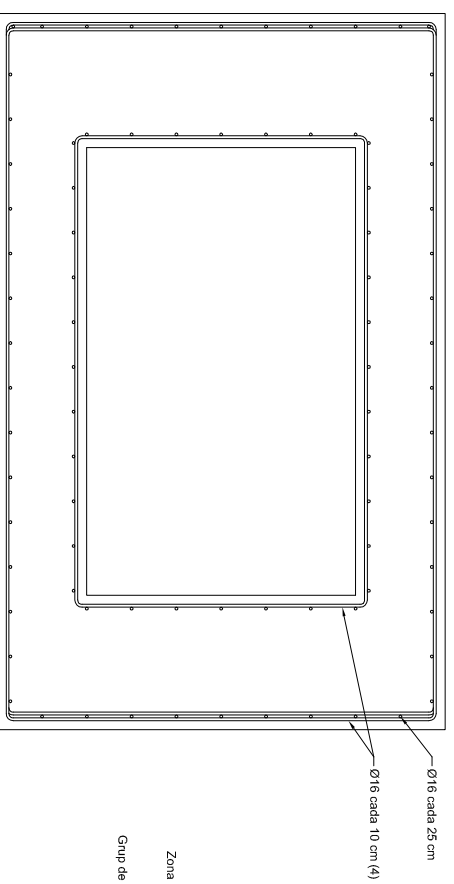

Enginyer Autor del Projecte:
Ulric Celada Blesa

Alternativa al Pont de la
Gola del Llobregat Vial
Port-Aeroport

Escala:
Acotat

Data:
2013

Plànol nº:
Detalls de les torres i les piles.
11

Costelles

Alçat seccions BB':

1era Configuració relativa a les costelles properes a la torre.

Costelles amb la Configuració 1

Traçat de les Baines

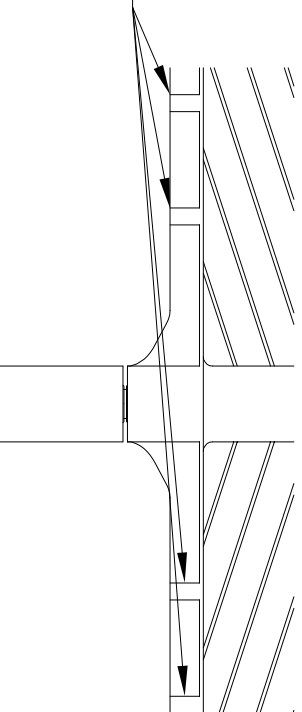
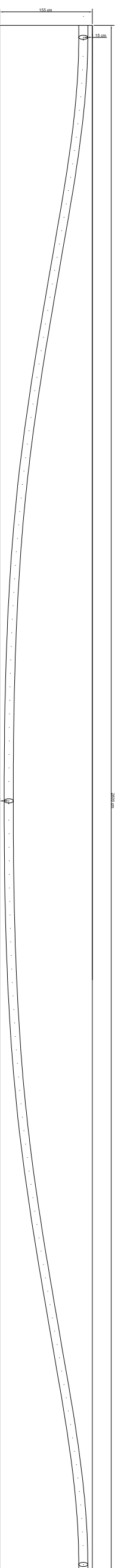

Secció Punta

Secció Centre Llum

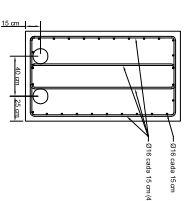
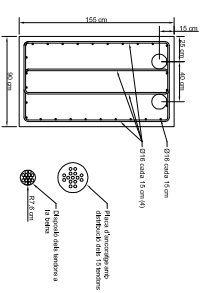

Costelles

Zona Configuració relativa a la resta de costelles

Traçat de les Baines

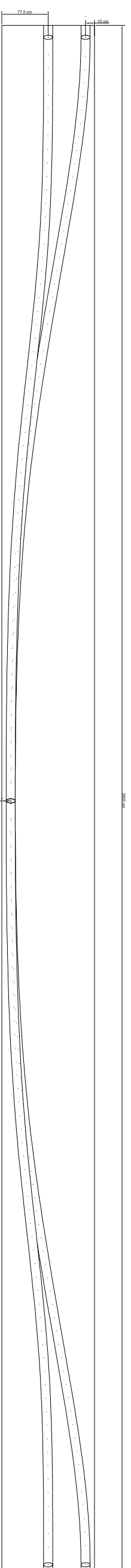

Secció Punta

Secció Centre Llum

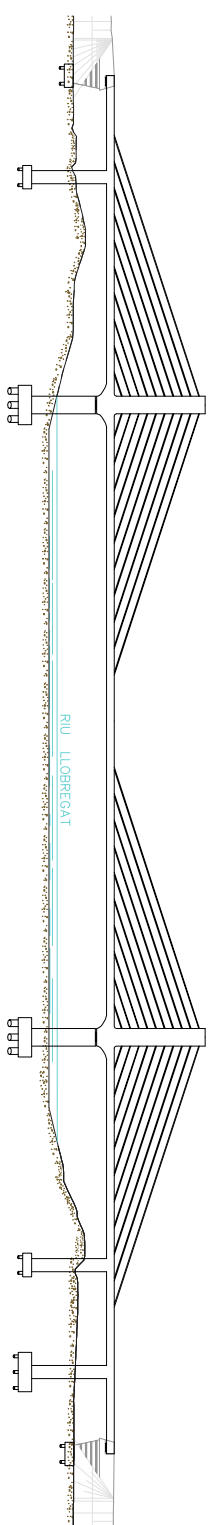
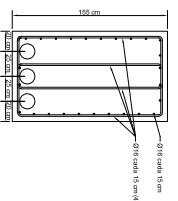
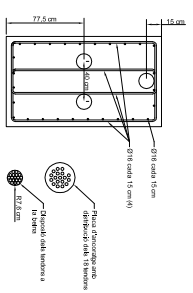

Enginyer Autor del Projecte: Ulric Celada Blesa 	Alternativa al Pont de la Gola del Llobregat Vial Port-Aeroport	Escala: Acotat	Data: 2013	Plànol nº: Detalls de les costelles	12
---	---	--------------------------	----------------------	---	-----------

Alçat sections BB'1:

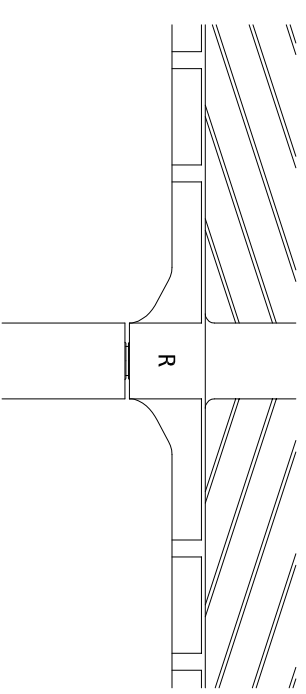

Riostra

Tragat de les Baines

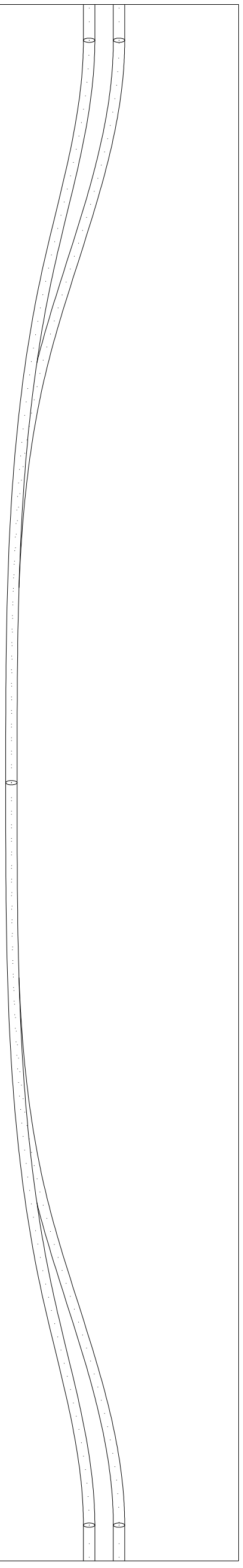

Secció Punta

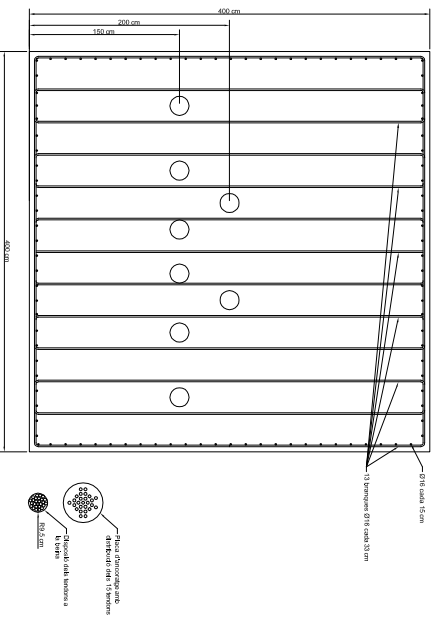

Secció Centre Llum

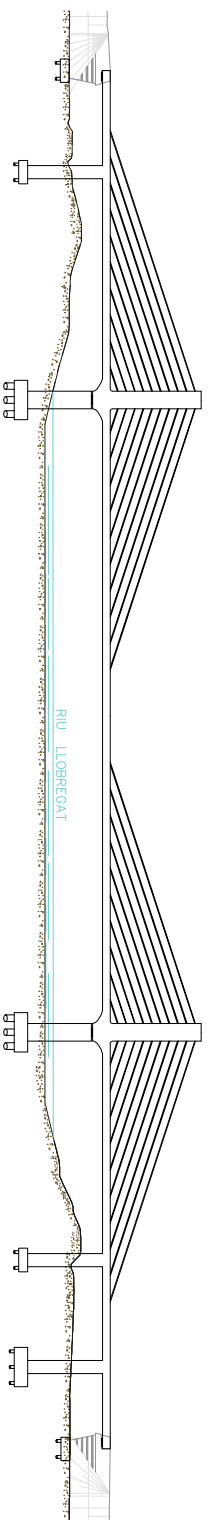
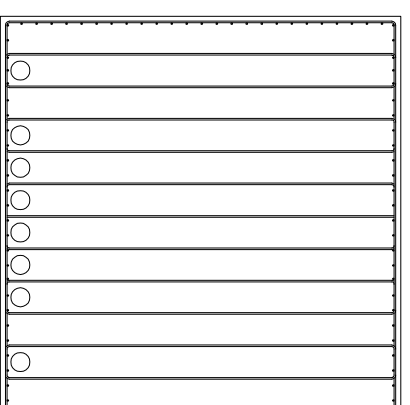

RIU LOBREGAT

Enginyer Autor del Projecte:
Ulric Celada Blesa

Alternativa al Pont de la
Gola del Llobregat Vial
Port-Aeroport

Escala:
Acotat

Data:
2013

Plànol nº:
Detalls de les riostrs

13

Llosa

Centre Llum

Sobre les riostrres

Vista Superior

Vista Superior

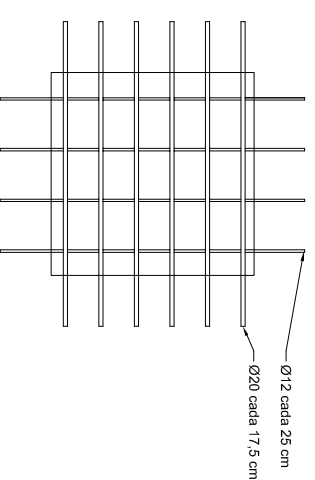
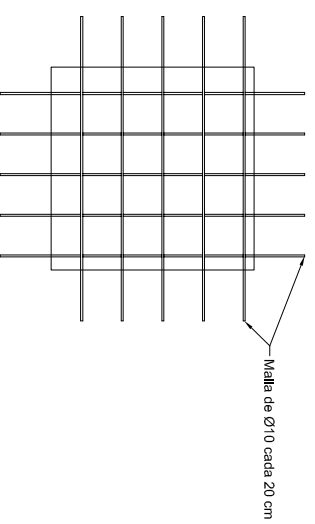

Alçat

Alçat

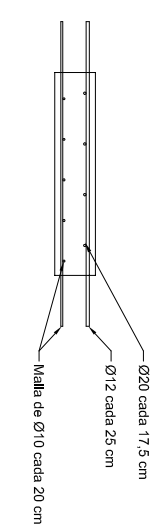
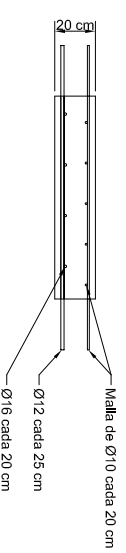

Vista Inferior

Vista Inferior

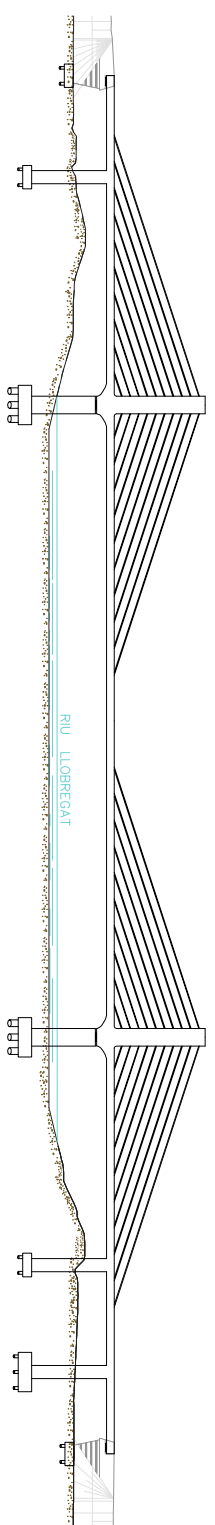
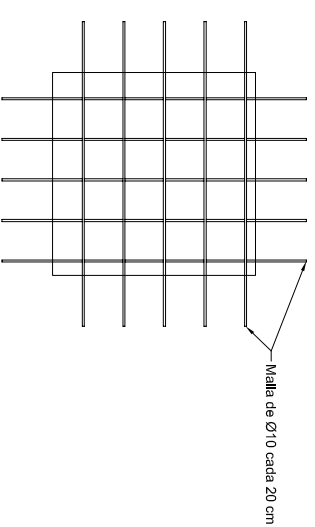
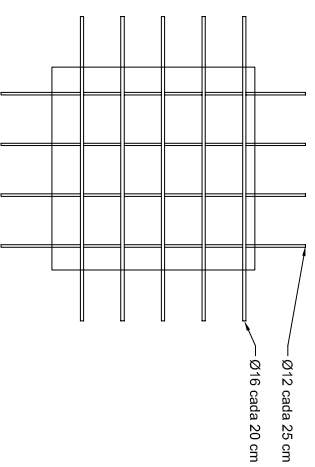

Enginyer Autor del Projecte: Ulric Celada Blesa 	Alternativa al Pont de la Gola del Llobregat Vial Port-Aeroport	Escala: Acotat	Data: 2013	Plànol nº: Detalls de les lloses	14
---	--	--------------------------	----------------------	--	-----------

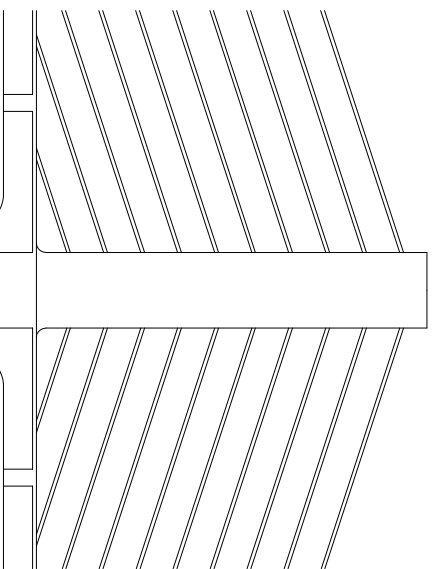

Pilons

1,5 m de Diametre

0,65 m de Diametre

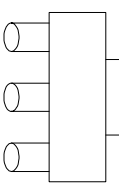
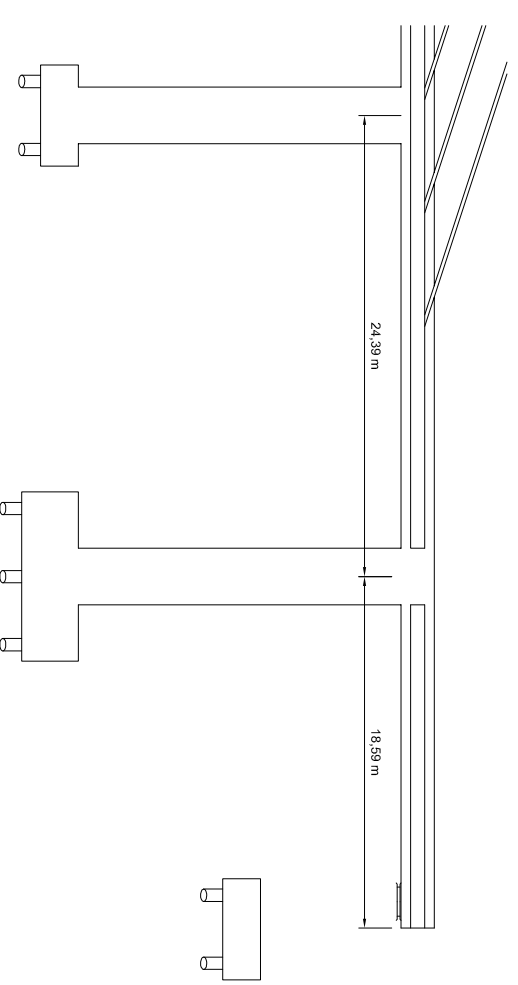

Fonamentació Torre:

Part Superior

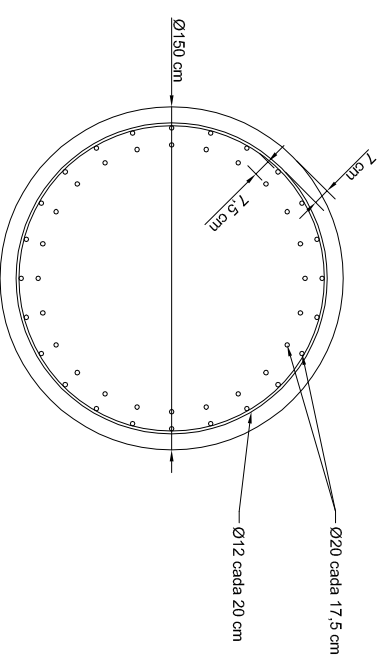

Part Superior

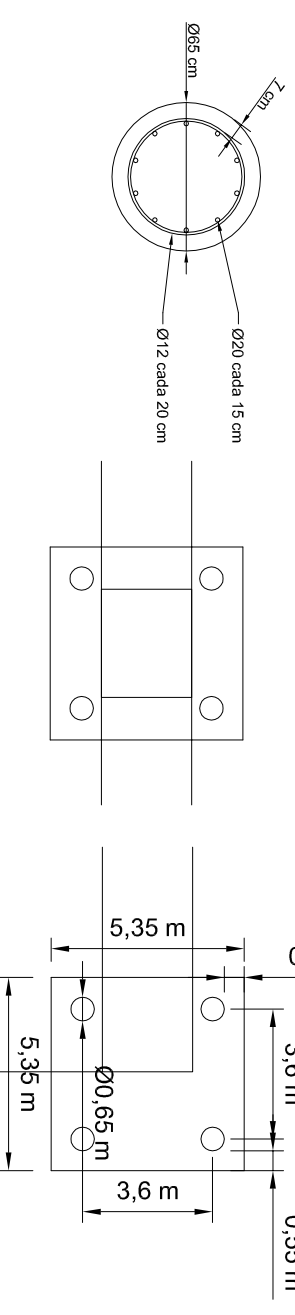

Fonamentacions de les piles separades del costat Barcelona

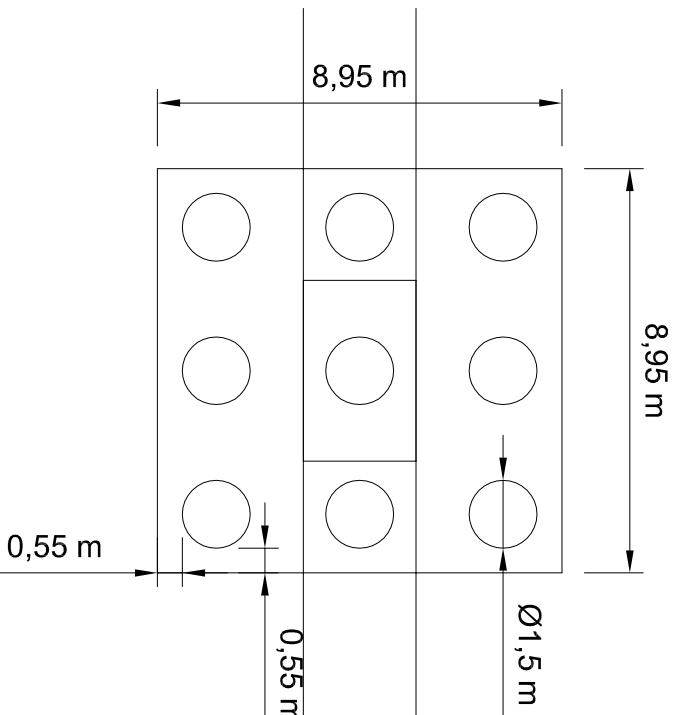

Part Inferior

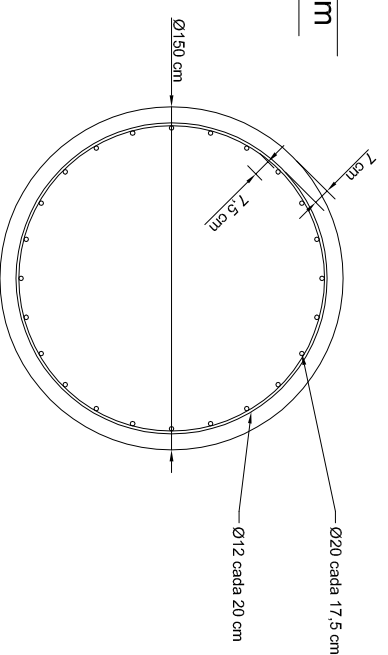

Part Inferior

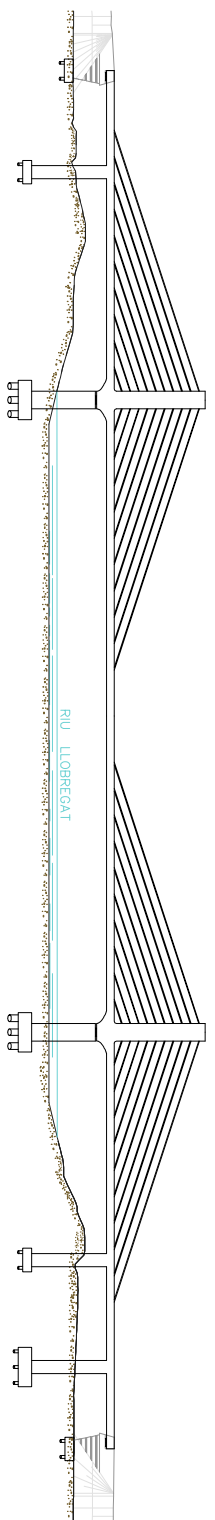
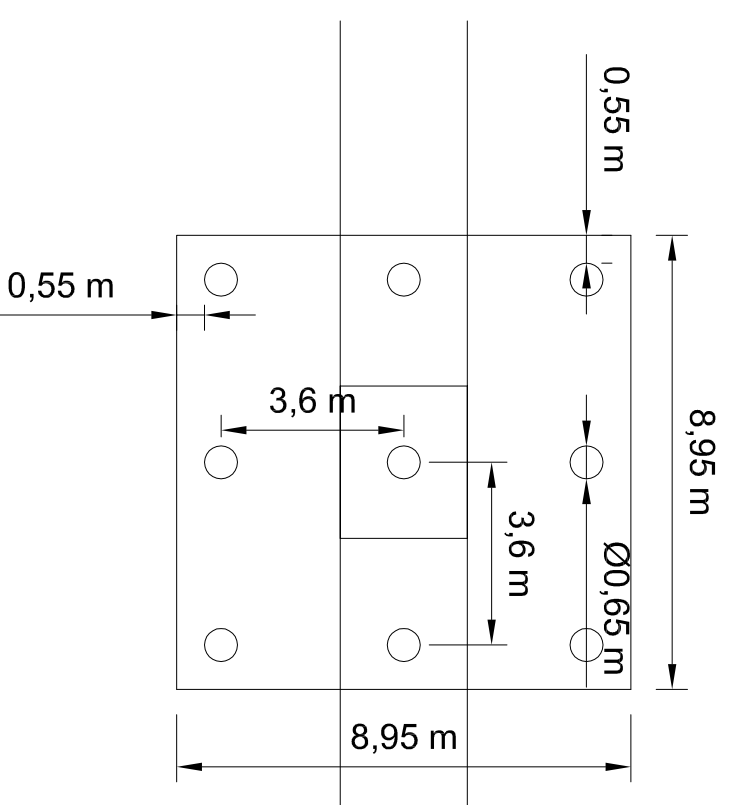
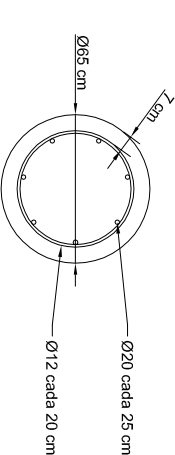

Enginyer Autor del Projecte:
Ulric Celada Blesa

Alternativa al Pont de la
Gola del Llobregat Vial
Port-Aeroport

Escala:
Acotat

Data:
2013

Plànol nº:
15
Detall de pilons i fonamentacions

Longitud dels Tirants:

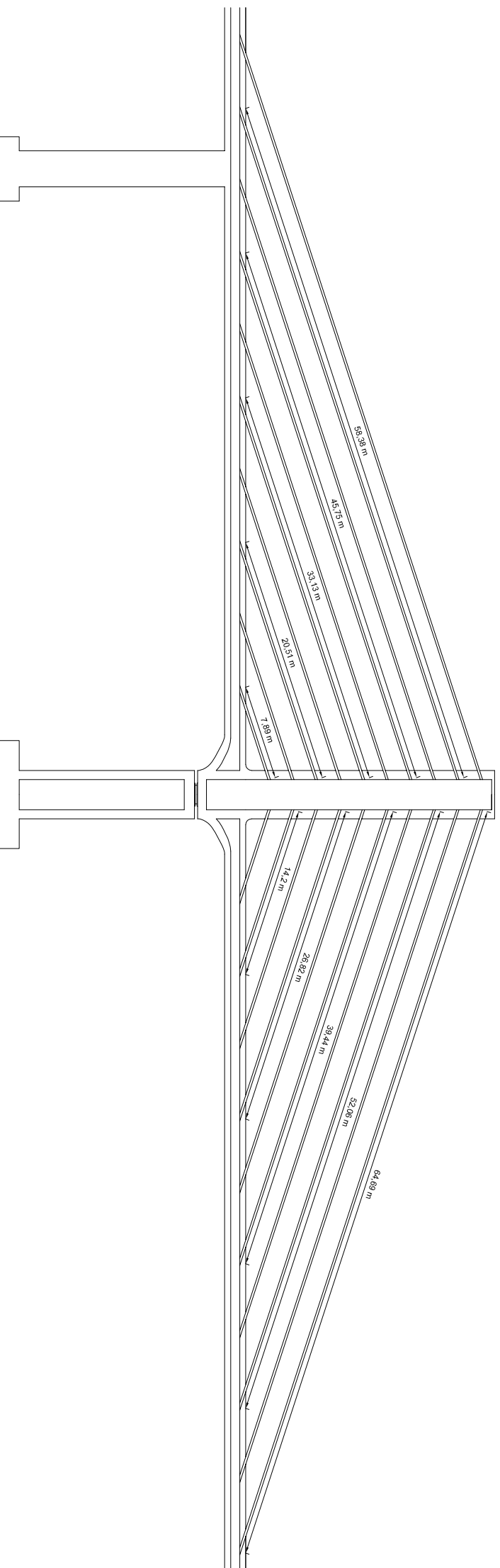

Tots els Tirants tenen un radide 58mm menys els especificats a continuació:
(i els seus simètrics)

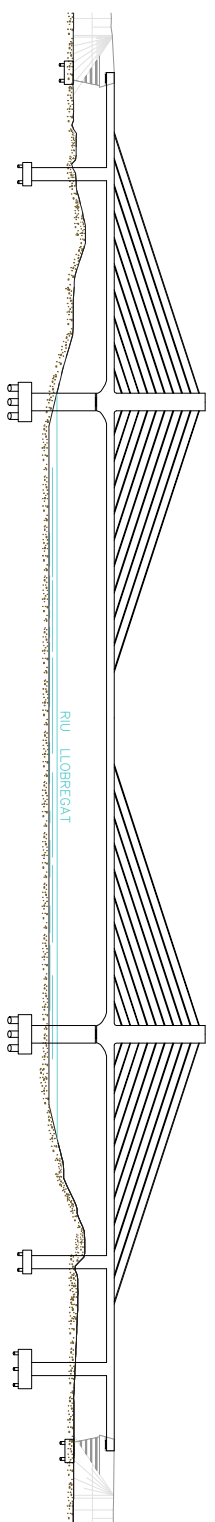
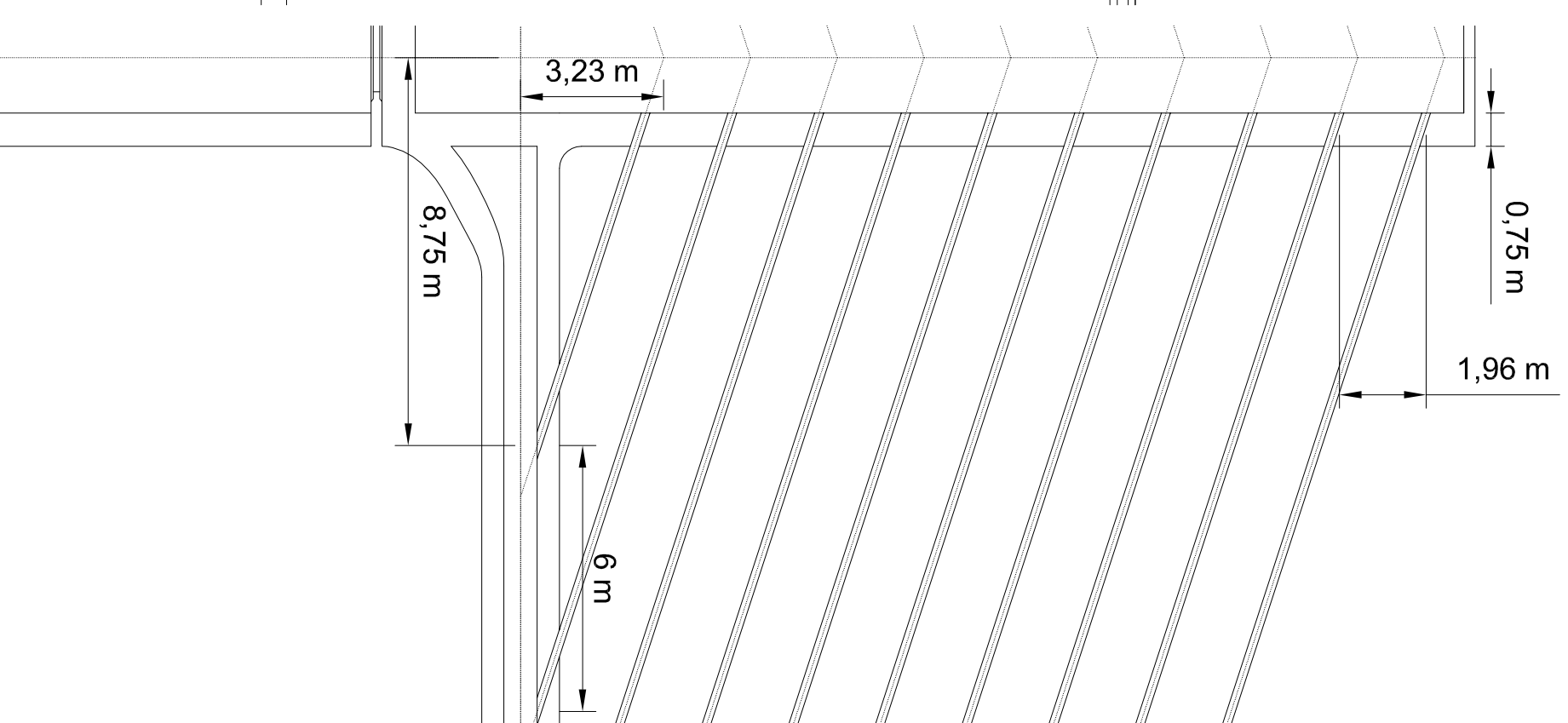
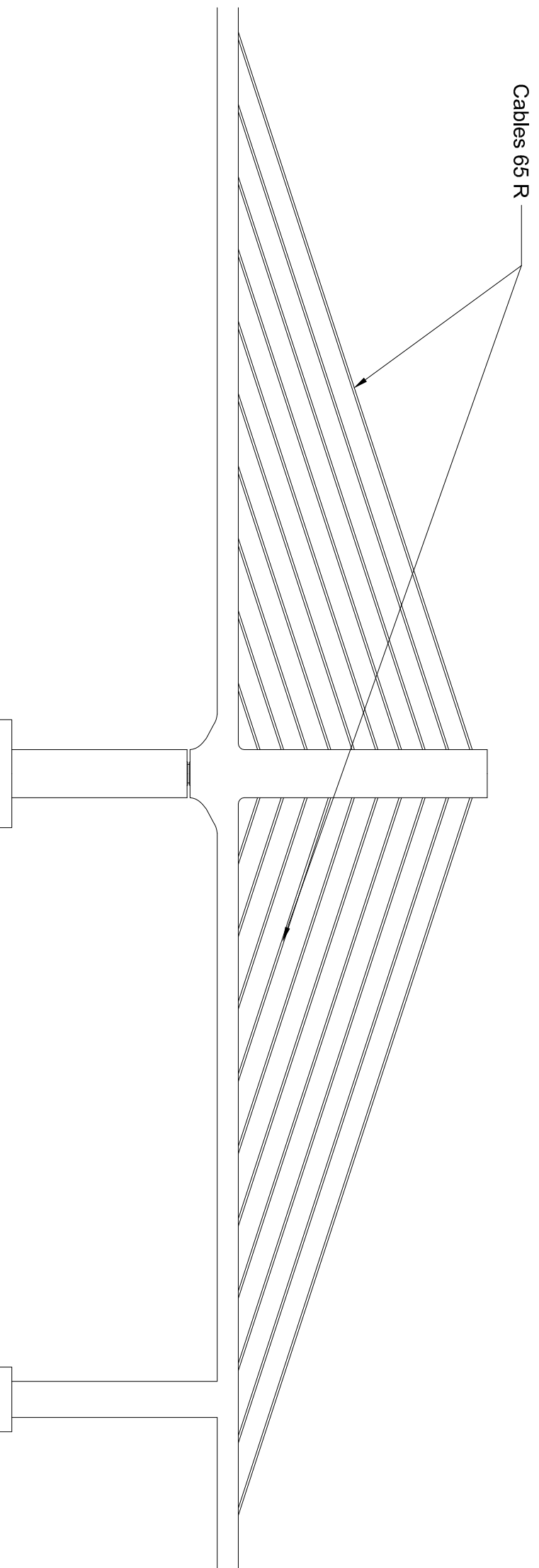

Enginyer Autor del Projecte:
Ulric Celada Blesa

Alternativa al Pont de la
Gola del Llobregat Vial
Port-Aeroport

Escala:
Acotat

Data:
2013

Plànol nº:
Detalls dels Tirants
16



Enginyer Autor del Projecte:
Ulric Celada Blesa

Alternativa al Pont de la
Gola del Llobregat Vial
Port-Aeroport

Escala:
Acotat

Data:
2013

Planol nº: 17
Situació general del pont. Entre Barcelona i el Prat
de Llobregat

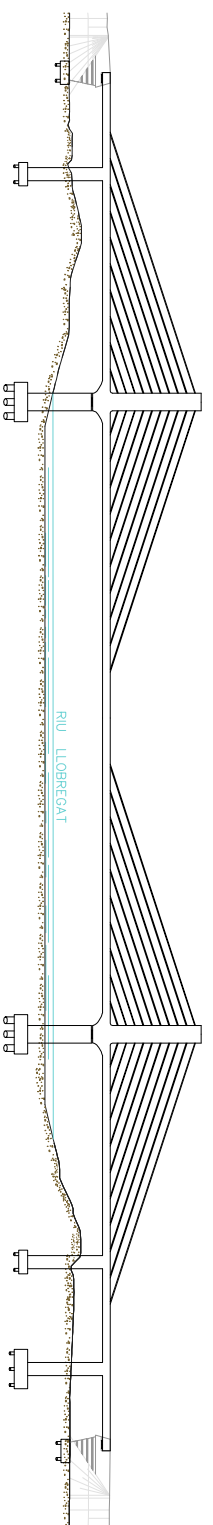
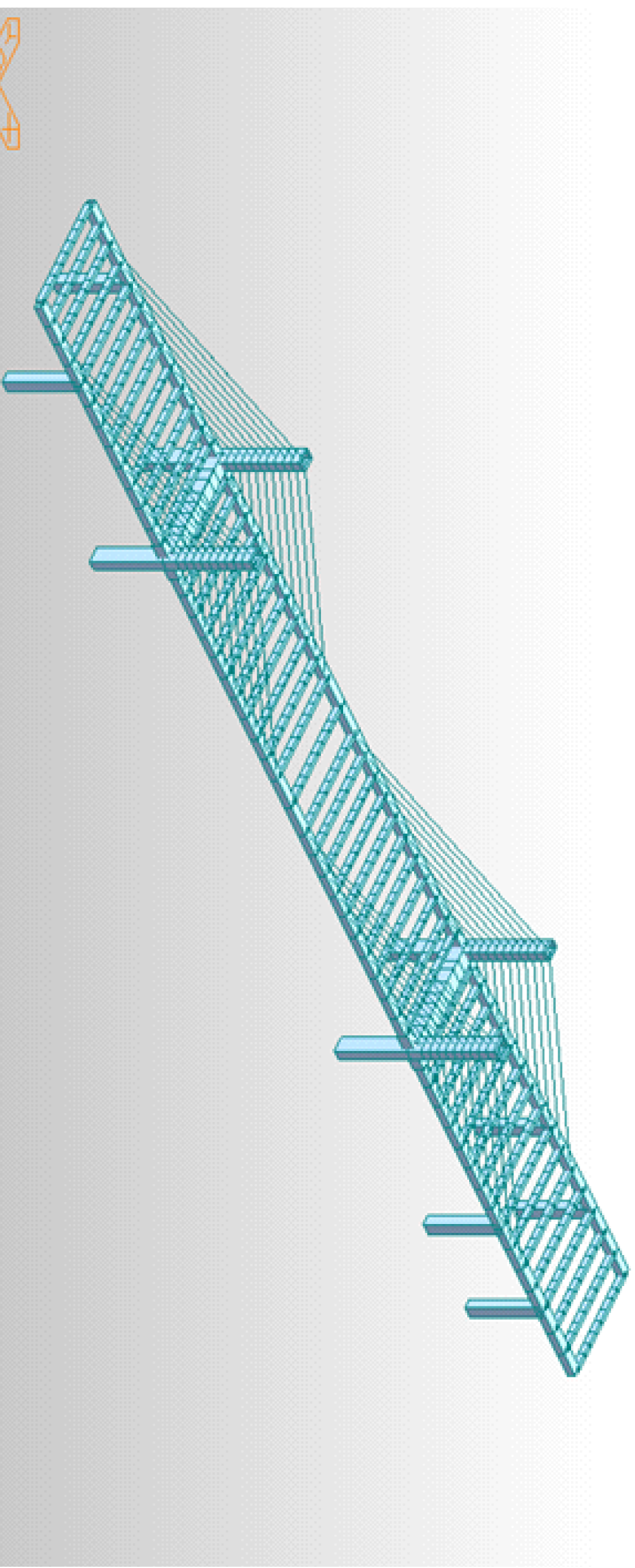
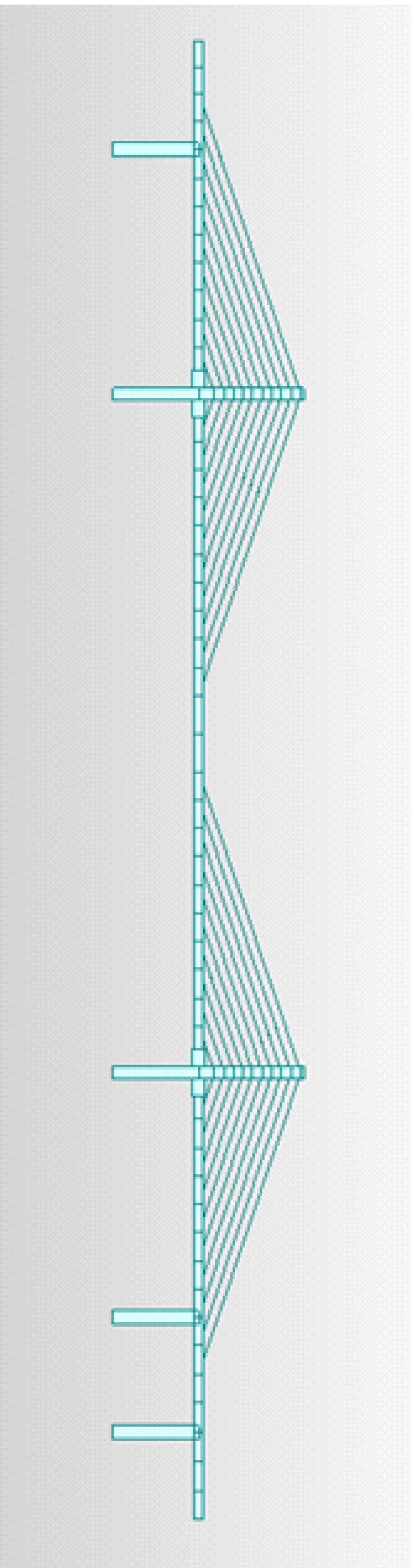

Enginyer Autor del Projecte:
Uric Celada Blesa

Alternativa al Pont de la
Gola del Llobregat Vial
Port-Aeroport

Escala:
Acotat

Data:
2013

Plànol nº: **18**
Model utilitzat per calcular l'estructura