

**CÁLCULO DE OCUPACIÓN SEGÚN CTE DB SI 3.2 TABLA 2.1**

Density (m2/pers)	Occupation (persons)	Useful Area (m2)	
<b>a) SPACE FOR EXHIBITION ACTIVITIES</b>			
2	43	1.1   Access Lobby Room A	86,62 m2
2	135	1.2   Access Lobby Rooms C and D	269,61 m2
10	4	1.3   Control Point and Cloakroom	38,14 m2
10	5	1.4   Ticket sales Point	52,92 m2
40	1	1.5   Centro de Transformación	38,16 m2
2	215	1.6   Foyer	430,54 m2
0	0	1.7   Technic Room GF	8,41 m2
3	7	1.8   Theater Toilets GF	21,47 m2
0	0	1.9   Cleaning Local	1,81 m2
2	138	2.1   Lobby FF	275,02 m2
0	0	2.2   Technic Room FF	81,36 m2
10	4	2.3   Information and Snack	37,66 m2
3	18	2.4   Theater Toilets FF	53,43 m2
10	2	2.5   Communications FF	18,99 m2
2	116	3.1   Lobby SF	231,08 m2
10	1	3.2   Information and Snack	10 m2
3	8	3.3   Theater Toilets SF	23,62 m2
0	0	3.4   Cleaning Local	5,35 m2
10	13	3.5   Communications SF	133,36 m2
10	2	4.19   Communications TF	23,64 m2
<b>ACTORS'S ZONE</b>			
10	1	1.11   Access Hall	7,94 m2
10	1	1.12   Control Point	14,45 m2
10	6	1.13   Lobby and Waiting Room	55,99 m2
10	1	1.14   Syndicate Actor's Office	12,83 m2
10	1	1.15   Conductor's Office	12,66 m2
2	12	1.16   Hairdressing and Make-up	24,43 m2
2	11	1.17   Dressing Room for Extras	22,95 m2
2	10	1.18   Collective Dressing Room GF	19,21 m2
2	2	1.19   Individual Dressing Room GF	12,73 m2
2	60	1.20   Brake Room	186,28 m2
3	7	1.21   Commons Toilets for Artists	21,88 m2
10	6	1.22   Communications GF	56,59 m2
2	11	2.8   Chorus Dressing Room	22,78 m2
2	10	2.18   Collective Dressing Room FF	19,21 m2
2	2	2.19   Individual Dressing Room FF (x2)	25,46 m2
10	6	2.6   Communications FF	59,98 m2
<b>Room A. PROSCENIUM THEATER</b>			
<b>PUBLIC AREA/REPRESENTATION</b>			
588	4.20   Auditorium (Capacity 588 pers)	620,87 m2	
60	1.23   Stage	238,29 m2	
10	3.6   Theatre Box	36,81 m2	
10	6	3.7   Communications SF	61,85 m2
<b>STAGE SERVICES</b>			
2	30	1.24   Rehearsal Room	77,69 m2
2	30	1.25   Rapids Changes	83,83 m2
2	2	1.26   Control Cabin Lighting and Effects	26,49 m2
2	2	1.27   Projection Technic Room	26,49 m2
40	3	1.28   Scenery Deposit	110,51 m2
40	2	1.29   Costume Workshop & Background	73,25 m2
<b>TECHNIC AREA</b>			
<b>Room B. CONCERT HALL</b>			
<b>PUBLIC AREA/REPRESENTATION</b>			
2	97	2.25   Access Lobby Room B	194,25 m2
10	3	2.29   Ticket sales Point	26,37 m2
0	1120	2.32   Auditorium	560,29 m2
10	30	1.30   Stage	90,77 m2
10	2	2.31   Cloakroom	16,09 m2
3	7	2.34   Concert Hall Toilets	22,21 m2
10	3	1.33   Communications GF	34,98 m2
10	7	2.33   Communications FF	68,9 m2
<b>STAGE SERVICES</b>			
2	30	1.31   Rapids Changes	60,67 m2
40	2	1.32   Store Room B	78,32 m2
<b>Room C. ASSEMBLY HALL</b>			
180	1.34   Seating Area and Stage (Capacity 185 pers)	397,02 m2	
2	4	1.35   Space reserved for the speaker	24,1 m2
40	1	1.36   Store Room	40,94 m2
<b>Room D. AUDIO-VISUAL ROOM</b>			
131	2.7   Seating Area (Capacity 131 pers)	167,23 m2	
<b>b) SPACE FOR CREATION OR PRODUCTION</b>			
2	248	2.9   Access Lobby 01	496,38 m2
10	2	2.10   Control Point and Cleaning	24,19 m2
40	0	2.11   Bike Store	19,79 m2
5	30	2.14   Scenery Workshop	152,16 m2
5	14	2.15   Wardrobe Workshop	69,91 m2
5	14	2.16   Models Workshop	70,03 m2
5	13	2.17   Design Workshop	63,11 m2
5	17	2.18   Multipurpose Space	85,95 m2
2	99	2.19   Exhibition Area	198,25 m2
10	3	2.33   Communications	30,05 m2
<b>c) CHOREOGRAPHIC CENTRE</b>			
<b>TEACHING AREA</b>			
2	167	3.10   Access Lobby 02	333,1 m2
2	75	4.1   Lobby TF	173,09 m2
10	2	3.11   Control Point and Cleaning Local	18,45 m2
40	0	3.12   Store	18,76 m2
5	16	3.17   Music Workshop	79,08 m2
5	14	3.18   Chorus Workshop	72,24 m2
5	41	3.19   Dance Classroom (x2)	203,8 m2
5	31	3.20   Rehearsal Room	154,45 m2
2	12	3.13   Digital Edition Classroom	64,41 m2
5	30	4.2   Rehearsal Classroom (x2)	151,32 m2
2	135	4.3   Interpretation Theoretical Classroom (x3)	203,07 m2
10	3	3.16   Communications SF	29,28 m2
<b>LIBRARY</b>			
2	43	3.26   Access Lobby Library	85,66 m2
10	1	3.27   Information	6,74 m2
10	1	4.4   Control Point	12,86 m2
2	165	4.5   Reading Room	330 m2
40	0	4.6   Book Store	12,97 m2
2	3	4.7   Scanner Room	6,78 m2
40	1	4.8   Archive	36,23 m2
2	17	4.9   Multimedia Library	34,54 m2
5	7	4.10   Group Work Room	32,76 m2
3	6	4.11   Toilets	19,03 m2
<b>SCHOOL SERVICES</b>			
3	15	3.14   Toilets SF	43,68 m2
2	10	3.15   Staff Dressing Room	19,79 m2
2	28	2.12   Student Dressing Room	56,94 m2
40	1	2.13   Grupo Electrógeno	50,44 m2
<b>d) PUBLIC SERVICES</b>			
5	22	3.8   Rentable Social Workshop (x4)	111,35 m2
3	5	3.21   Workshop Toilets	15,34 m2
10	8	3.9   Communications SF	78,39 m2
<b>COFFEE PUB AUDITORIUM</b>			
2	109	1.38   Coffee Pub Area	162,82 m2
10	4	1.39   Kitchen	40,36 m2
3	15	1.40   Coffee Toilets	45 m2
10	1	1.41   Staff's Changing Room	14,74 m2
40	0	1.42   Store and Cleaning Local	6,19 m2
40	1	1.43   Kitchen's Store and Cold Store	48,07 m2
10	2	1.44   Communications	23,71 m2
<b>COFFEE PUB CONCERT HALL / LIBRARY</b>			
2	53	2.20   Coffee Pub Area GF	79,49 m2
10	2	2.21   Kitchen GF	21,45 m2
40	0	2.22   Store and Cleaning Local	4,8 m2
3	2	2.23   Coffee Toilets GF	4,97 m2
2	71	3.22   Coffee Pub Area FF	107 m2
10	2	3.23   Kitchen FF	24 m2
3	2	3.24   Coffee Toilets FF	4,97 m2
<b>e) MANAGEMENT SPACE</b>			
<b>GENERAL MANAGEMENT</b>			
<b>SCHOOL MANAGEMENT</b>			
10	1	4.12   Control Point	13,3 m2
10	2	4.13   Administration 01	18,92 m2
10	2	4.14   Administration 02	22,78 m2
10	2	4.16   Teacher Office (x2)	24,95 m2
3	4	4.15   Teacher Toilets	12,06 m2
10	1	4.17   Headmaster Office	12,06 m2
10	3	4.18   Meeting room	33,54 m2
10	7	4.19   Communications	71,63 m2
<b>d) PARKING</b>			
15	202	0.01   Parking	3022,17 m2

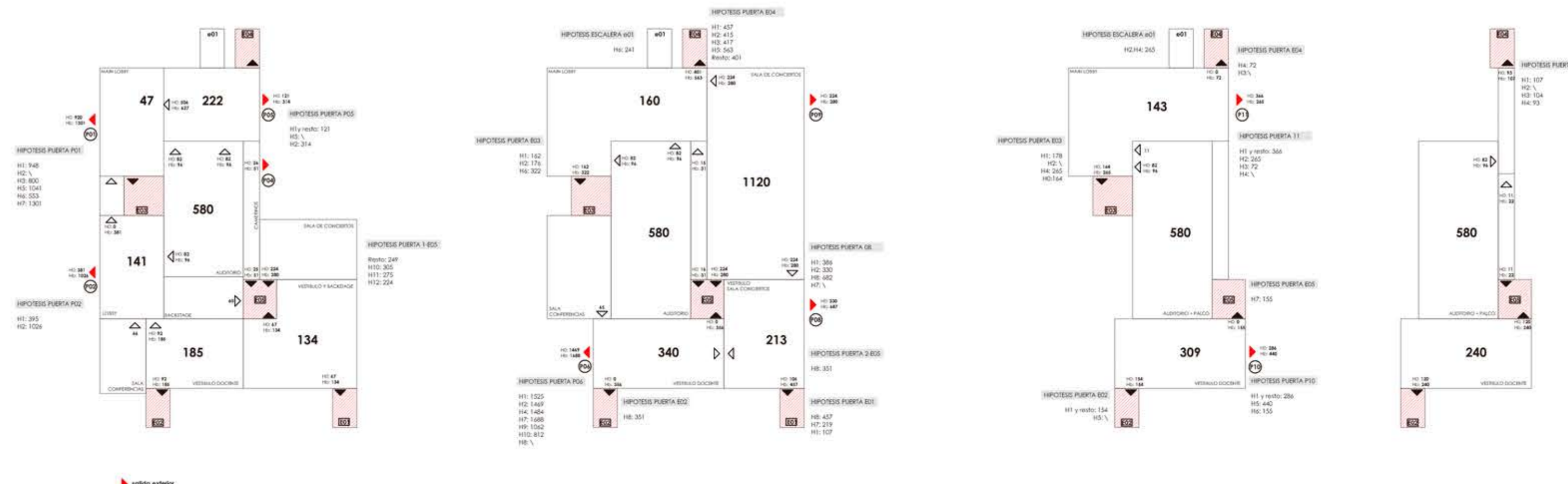

ESQUEMA HIPÓTESIS DE BLOQUE DE ESCALERA



ESQUEMA HIPÓTESIS DE EVACUACIÓN DE EDIFICIO

**LEYENDA**

- Armatón metálico con puerta de vidrio al vacío, sistema de depuración para pulvidor y extintor portátil. Incluye señalización. Detector digital de sistema de aspiración de alta sensibilidad. Detector analógico digital.
- Hidrate
- RAS
- Solicitud de planta
- Extintor Portátil 21A - 113B - C
- Extintor CO2 21B 2K-INDEX EC 2
- Grupo de presión para BES
- Escalera Protegida
- Roca de Incendios Equipada empujada formada por armazón metálico. Mangueo de 25 m y 25mm. Depuramiento para extintor portátil y pulvidor.
- Resistencia al fuego de puertas
- H0 | D | P
- H0 | HB | 356 p
- Recorrido de evacuación desde origen de evacuación hacia desatascador

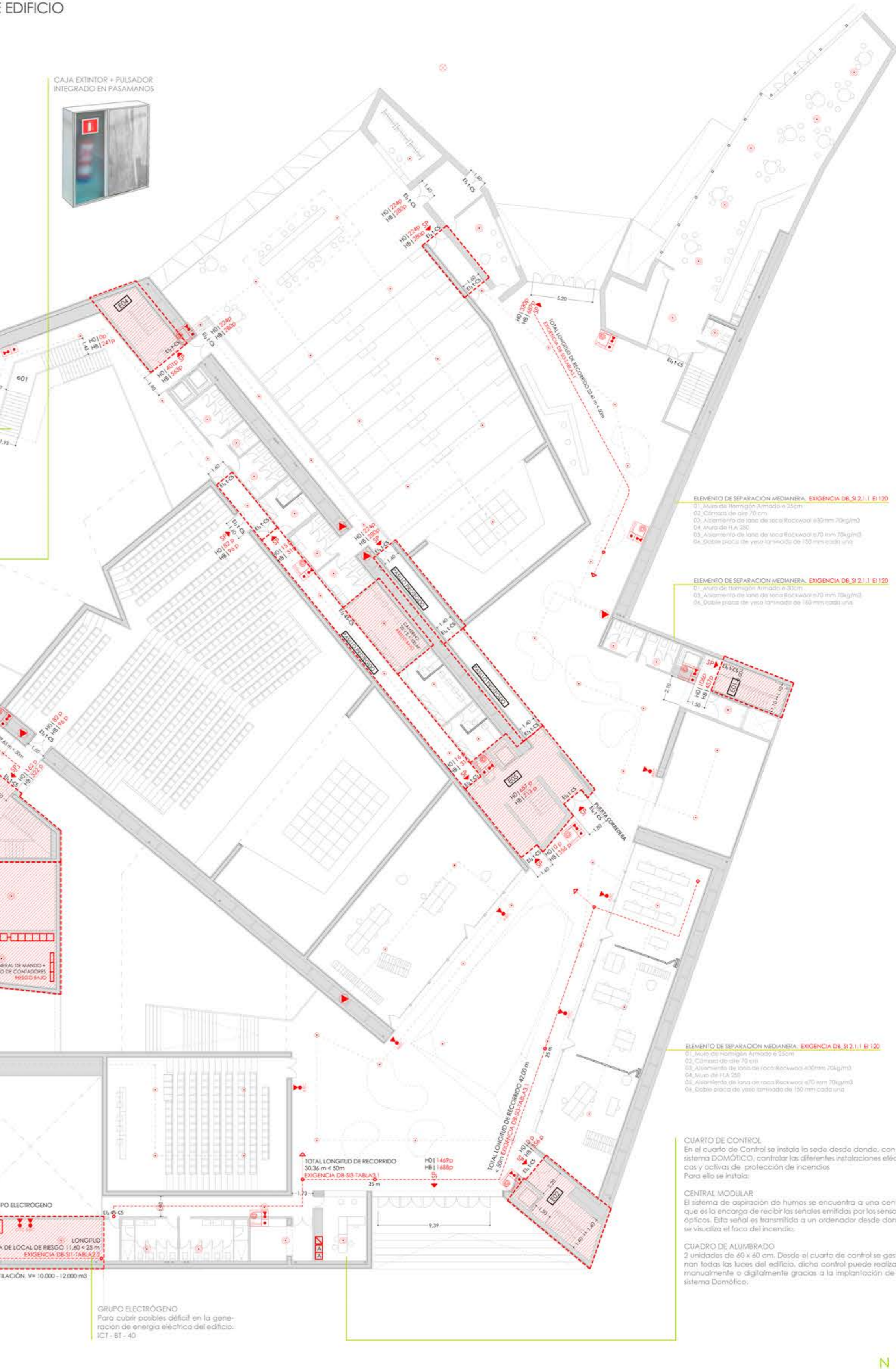
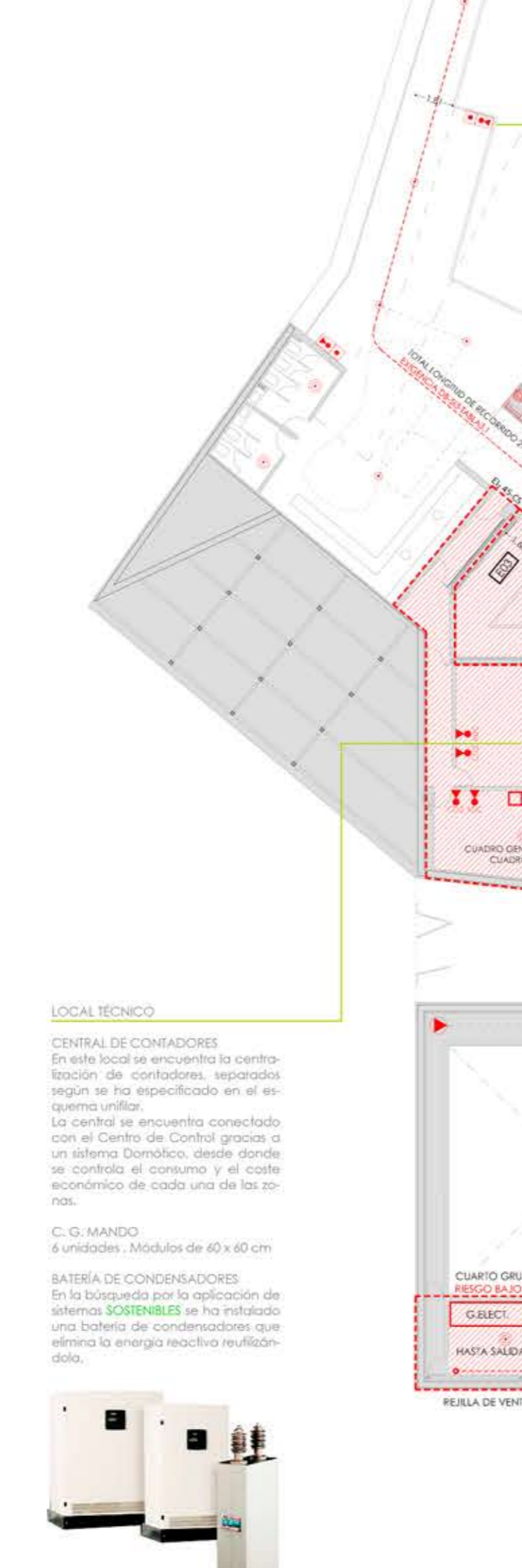

PCI. PLANTA PRIMERA. COTA + 4,00