

Two infrastructures

The planned program is enabled through two infrastructures.

On the spaces that touch the ground a new white glossy floor is designed that spreads in between the existing factory walls, like a liquid being held by a formwork. This strategy enables to link different parts of the factory that are currently isolated. Wall texture and ceramic vaults are left intact, since the floor is the only enclosure that is being activated.

On a higher level, a linear walkway system perforates the factory offering the visitors a narrative sequence that travels from exterior natural spaces to interior factory walls with the culinary activity in the background.

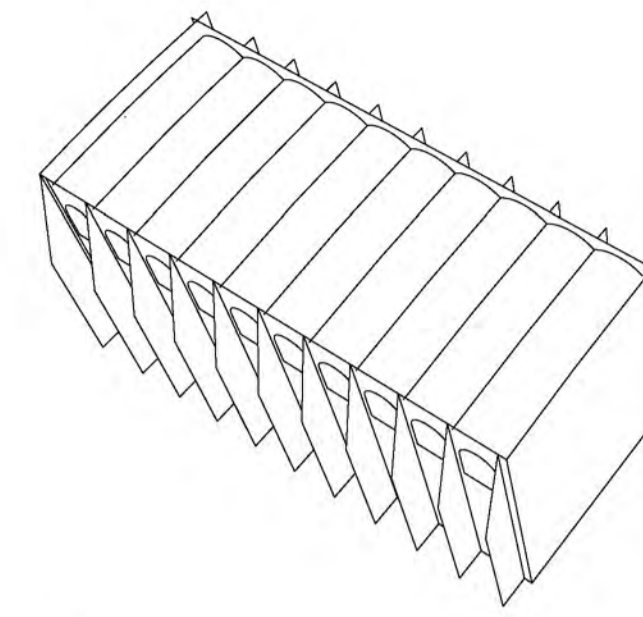

01 Preexisting

The old cement factory's state of abandonment provides a unique space of opportunity due to its unique natural setting and industrial architecture. The lower part of the factory still maintains its original roof (Catalan brick vaulted ceilings) and the upper part is currently in ruins.

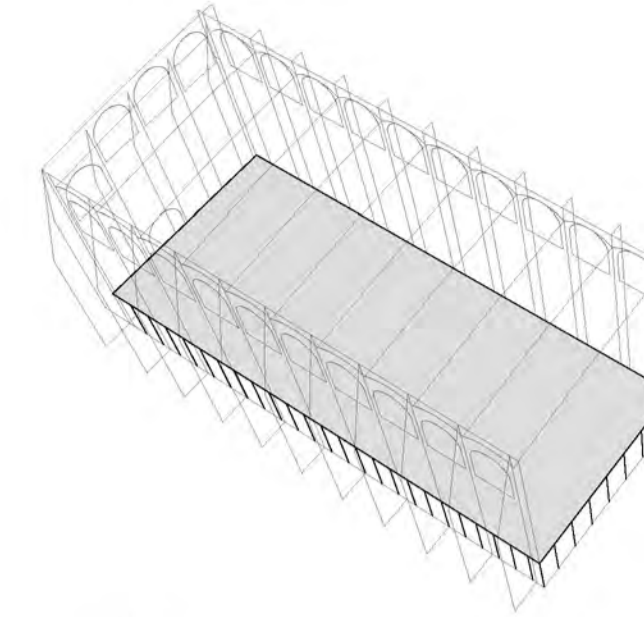

02 Mats

A white gloss floor that spreads touching the factory floor enables the cooking activities, leaving the wall texture intact and the brick vaulted ceilings on top. The adjustable pedestals allow for isolated factory spaces to interconnect adapting level variations into one continuous surface. The hollow access floor allows for technical fittings to run underneath it for easy access. The white finish allows a brighter interior and contrasts with the existing building.

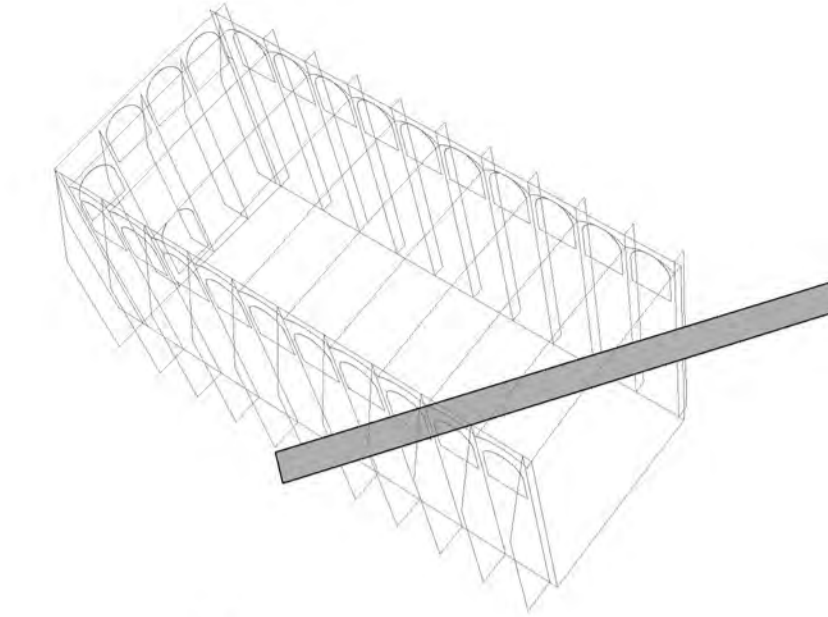

03 Lines

Cutting through the warehouses, a loop of two walkways flies from the inside of the factory complex to the surrounding forest. The new infrastructure doesn't interfere with the culinary school but allows visitors to see the spectacle of cooking in action. This infrastructure is supported on existing factory walls and are designed to minimize the need of new openings.

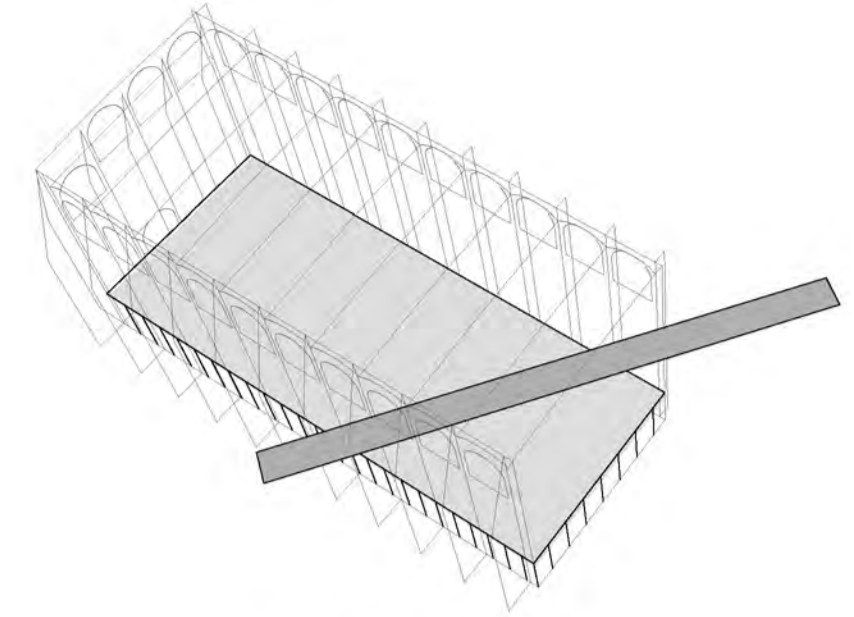

04 FoodFactory

The factory is reactivated through infrastructure. Both elements act as enablers for the retrofitted program. Each one is designed to optimize the material impact in order to be able to fulfill both activities in the industrial framework.



Cooking workshops and visitor walkways share the same space without interference.

