

UN PROCESO ABIERTO

Experiencia y evolución del método de proyección del Plan de Extensión de Amsterdam de 1934

Julián Galindo González



TESIS DOCTORAL
Director: Joaquín Sabaté Bel

ESCUELA TÉCNICA SUPERIOR DE ARQUITECTURA DE BARCELONA, U.P.C. 2.000

1 ELEMENTOS DE AGREGACIÓN

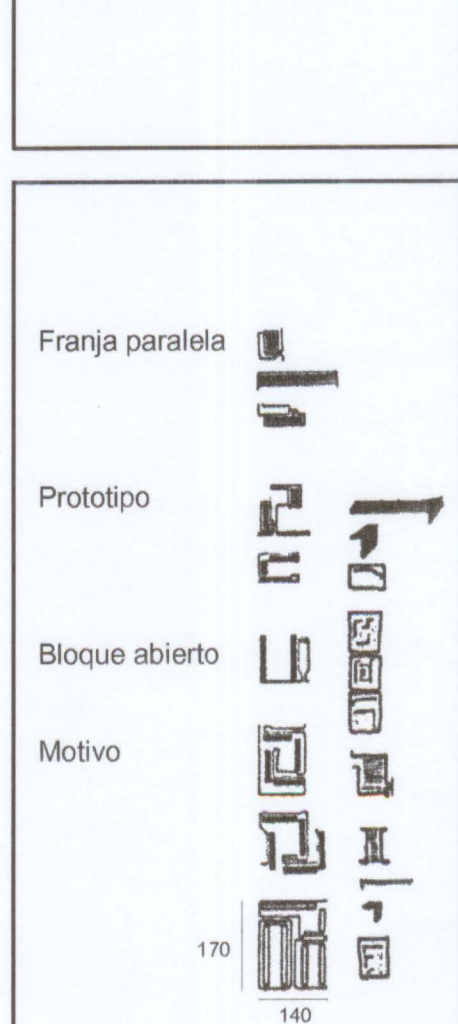

2 AGRUPACIONES SUPERMANZANAS 3 DEFINICIÓN DE LA UNIDAD VECINAL

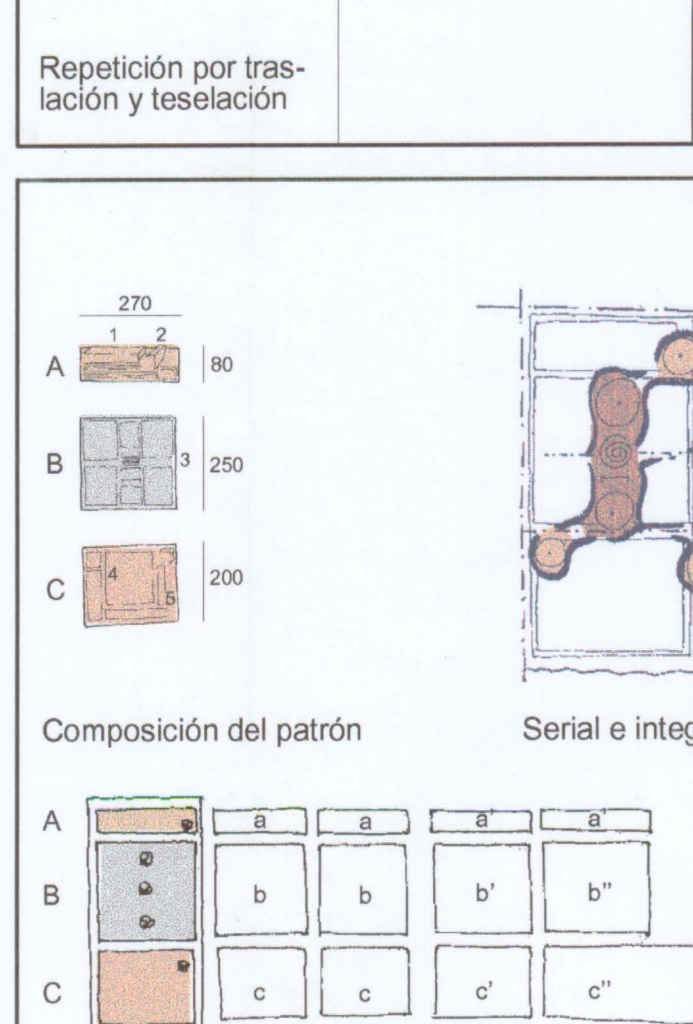
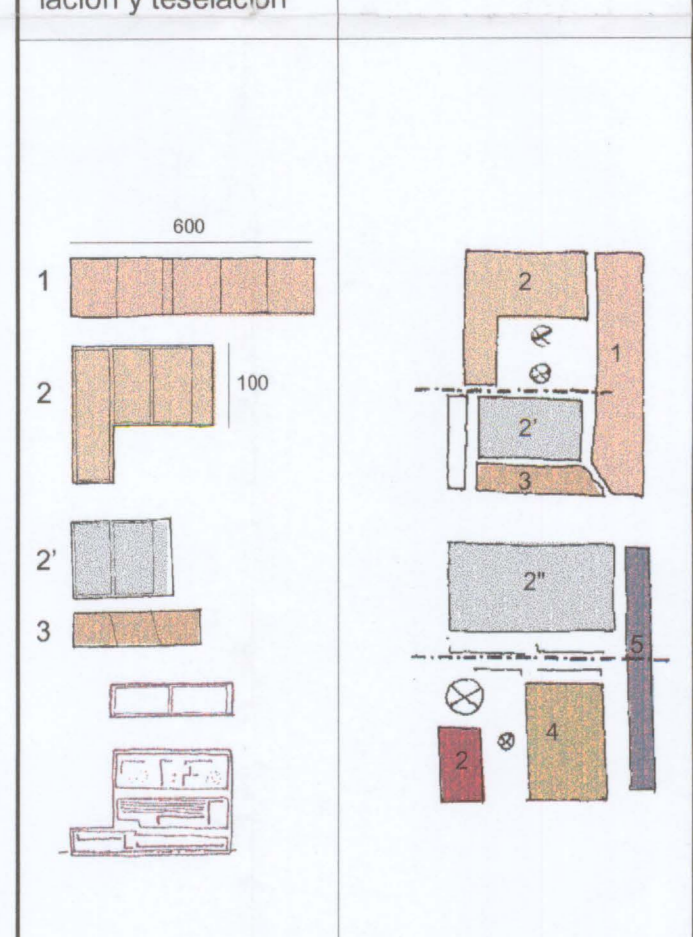
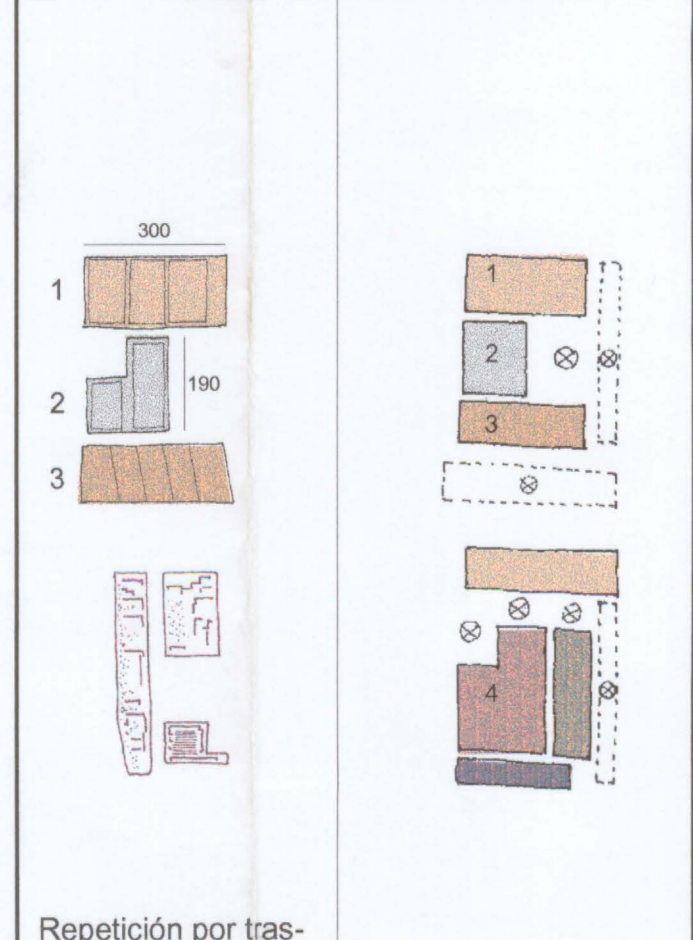
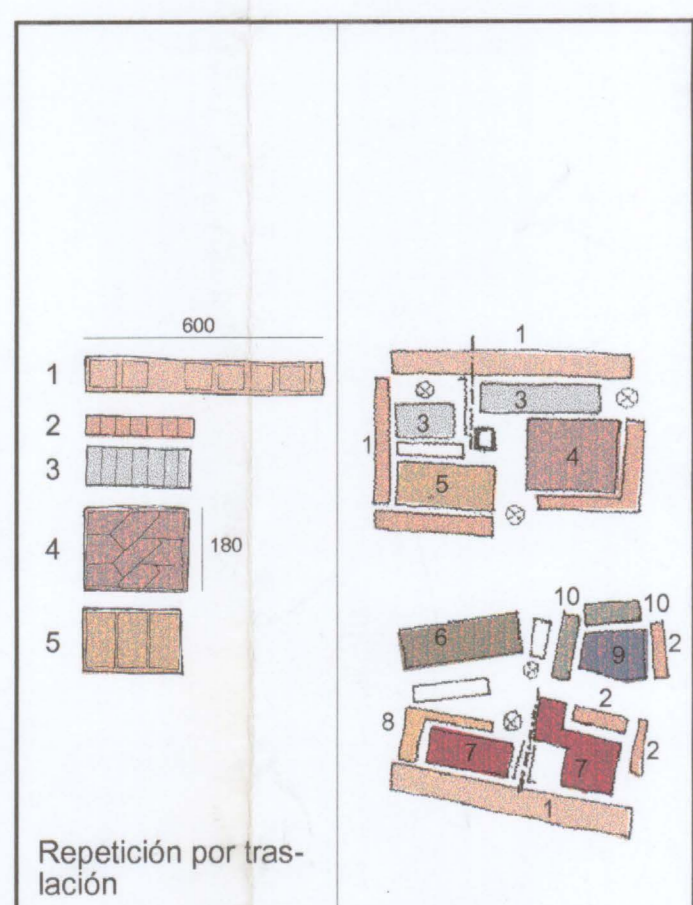

4 ORGANIZACIÓN FUNCIONAL

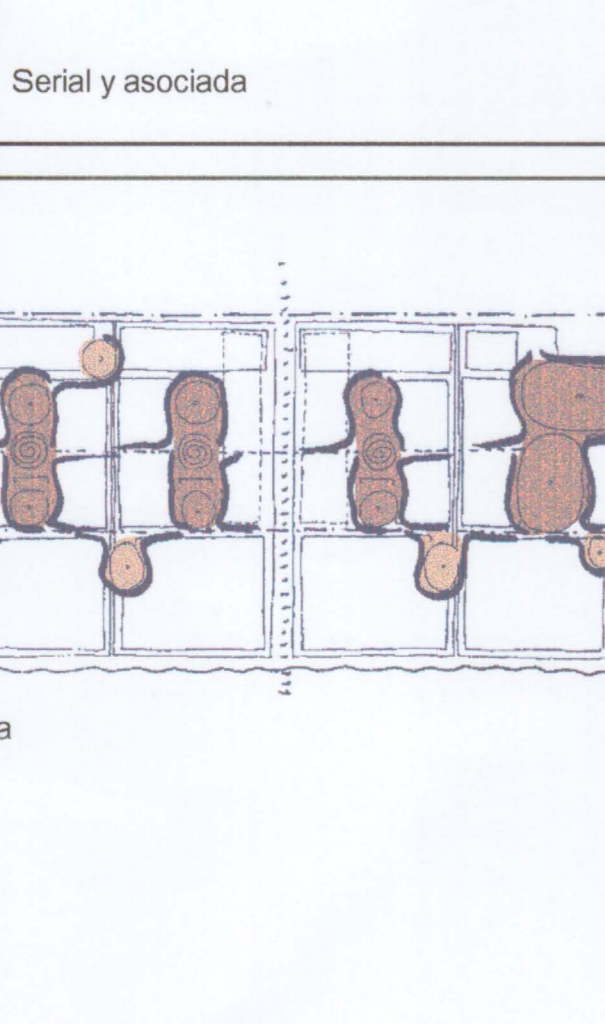
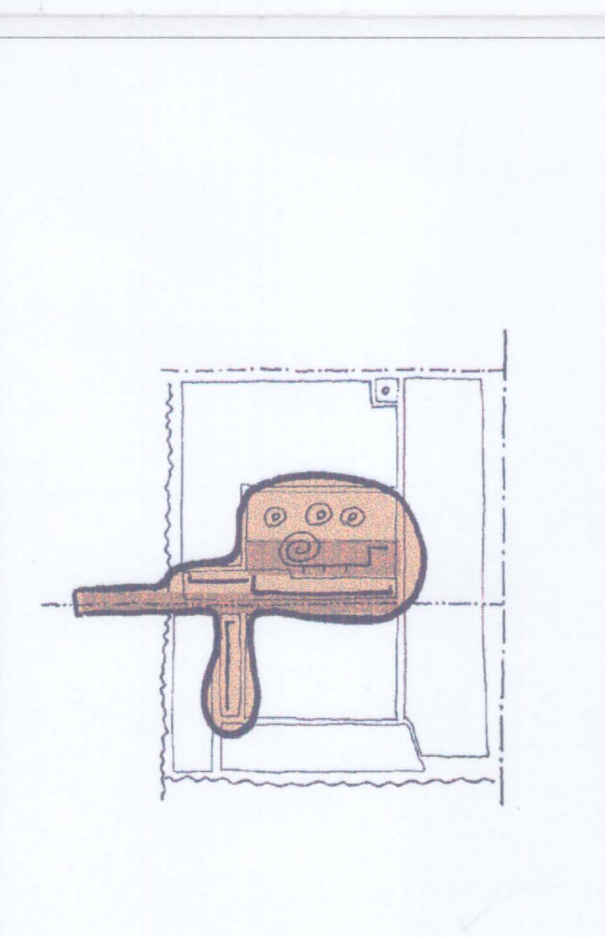
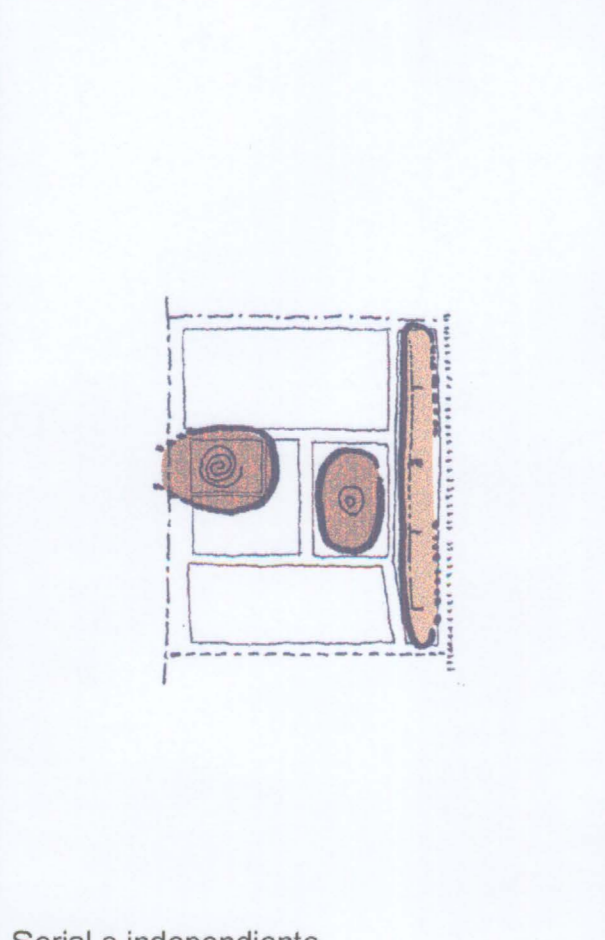
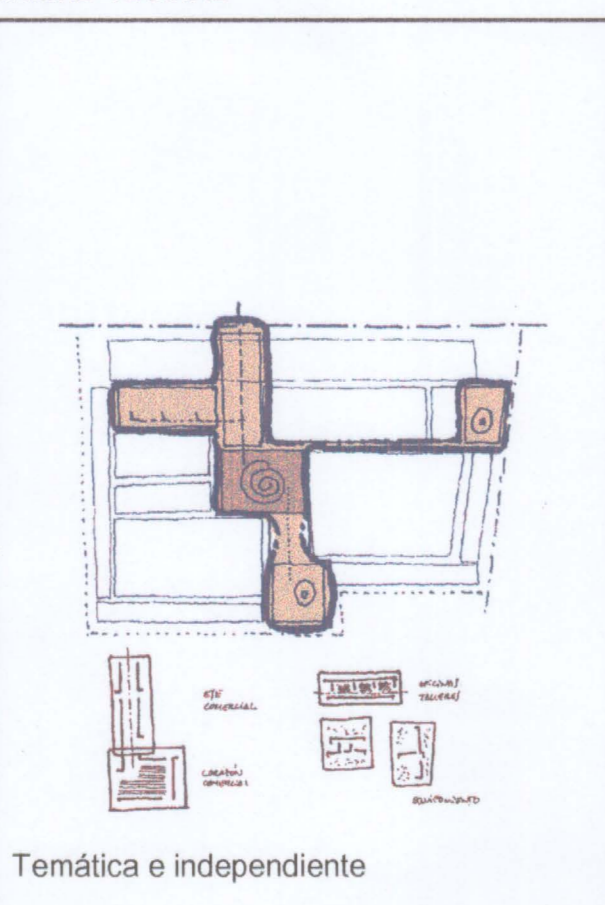

5 ORGANIZACIÓN FORMAL

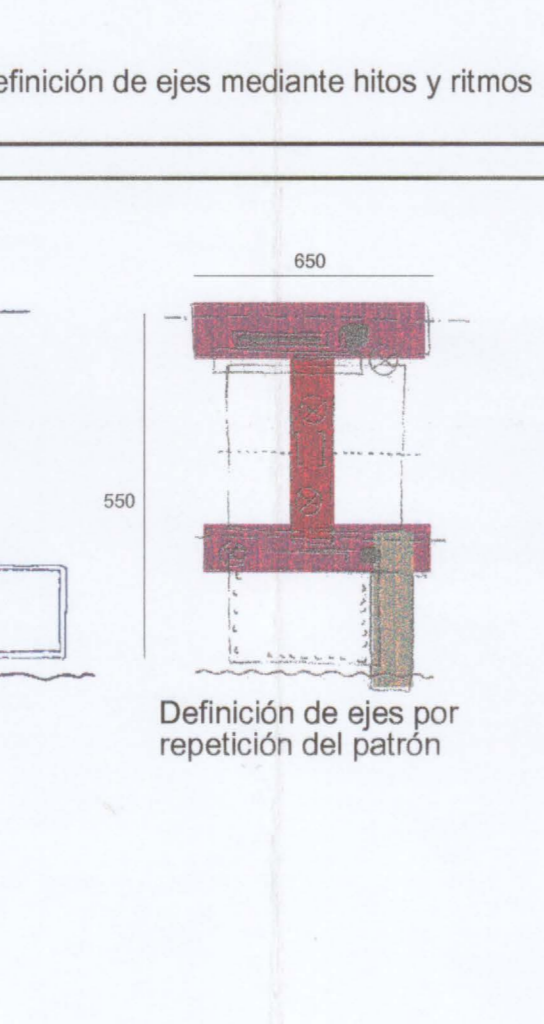
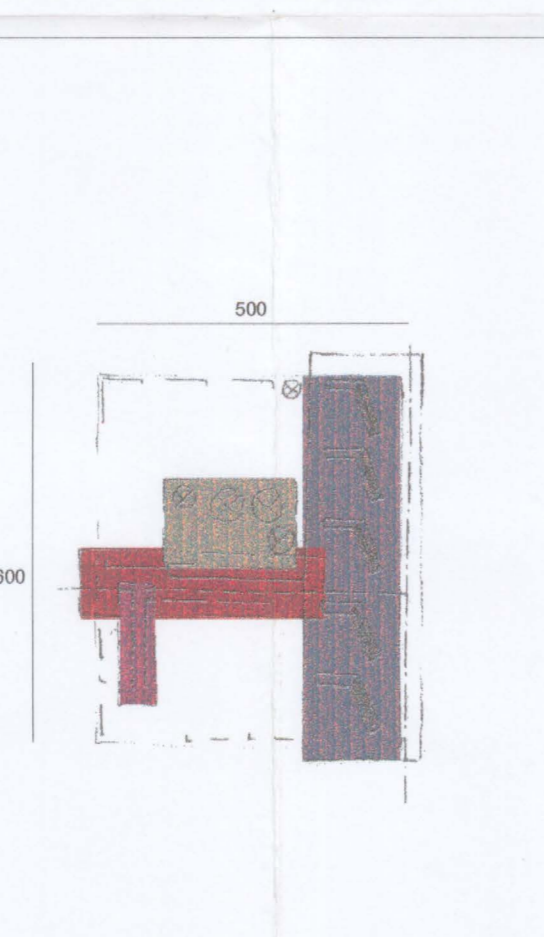
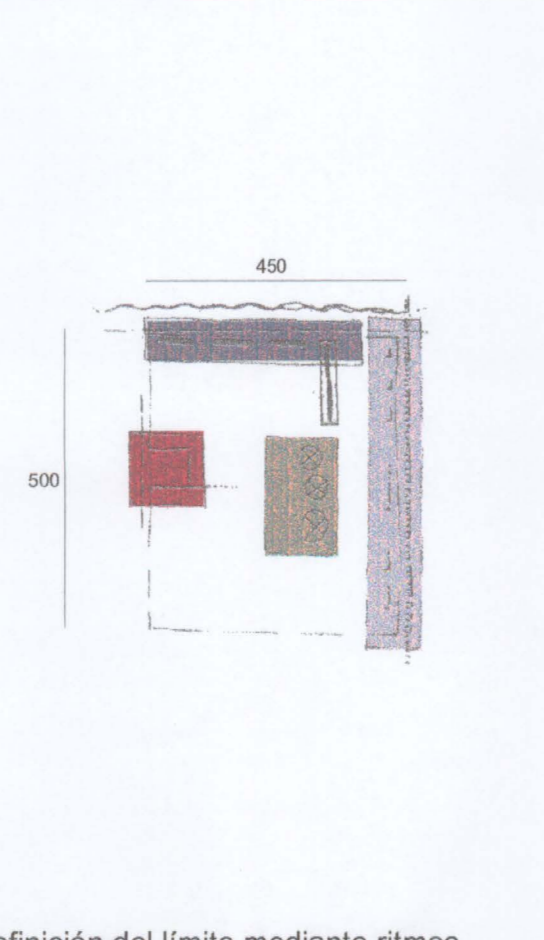
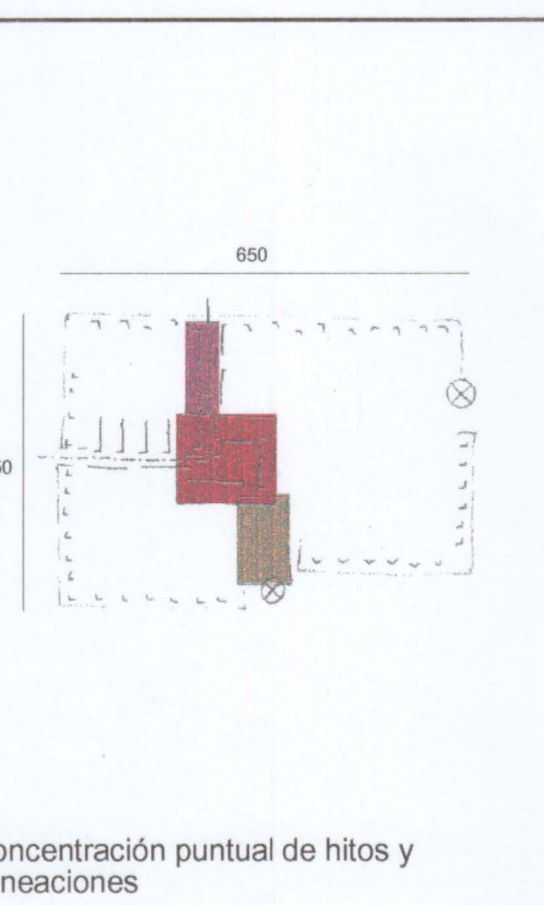

6 ORGANIZACIÓN ESPACIAL

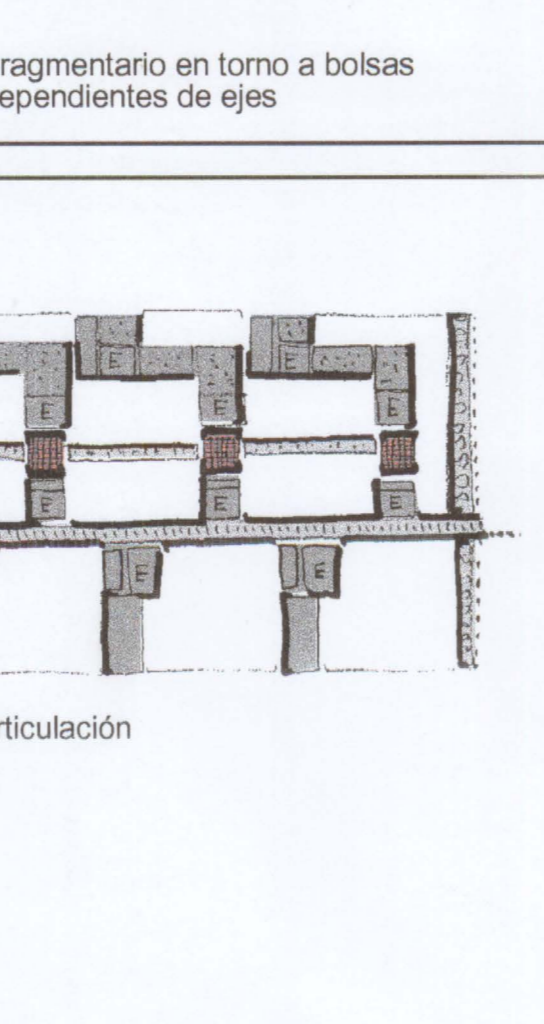
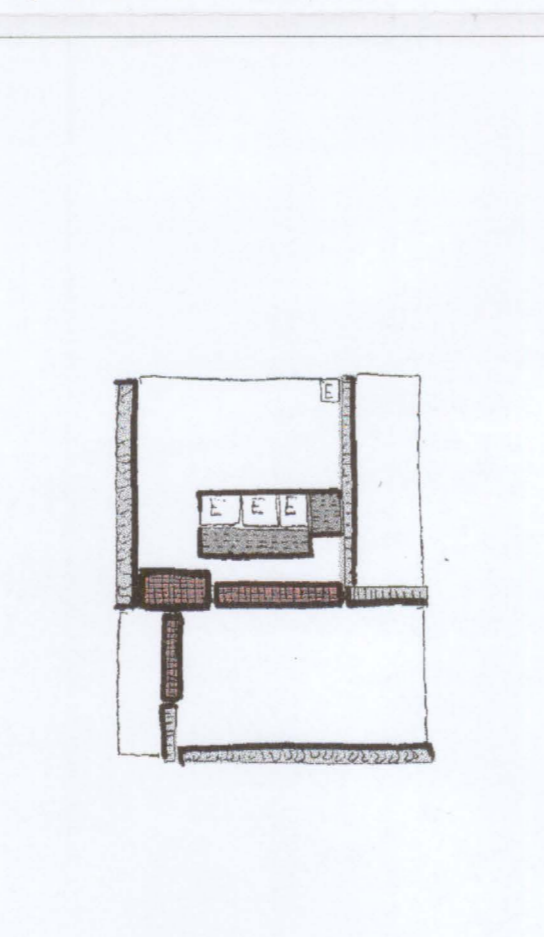
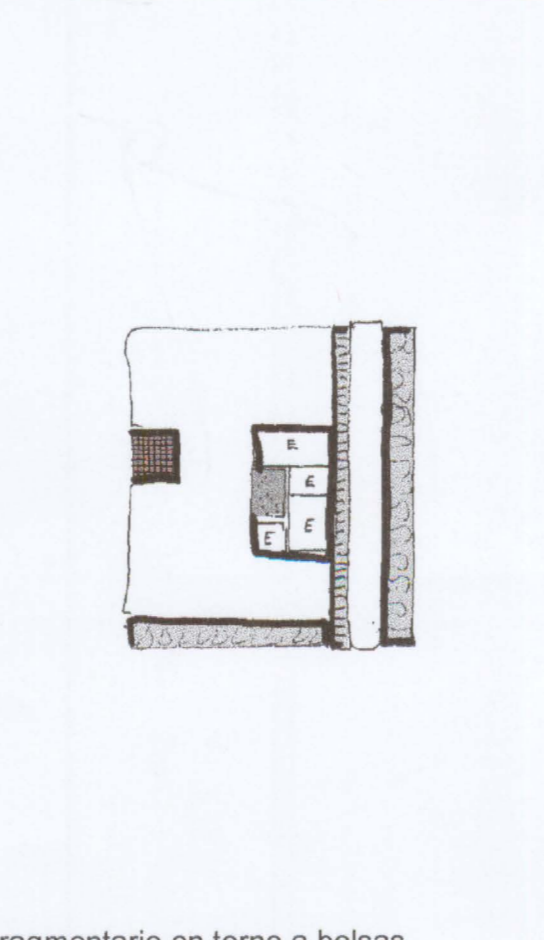
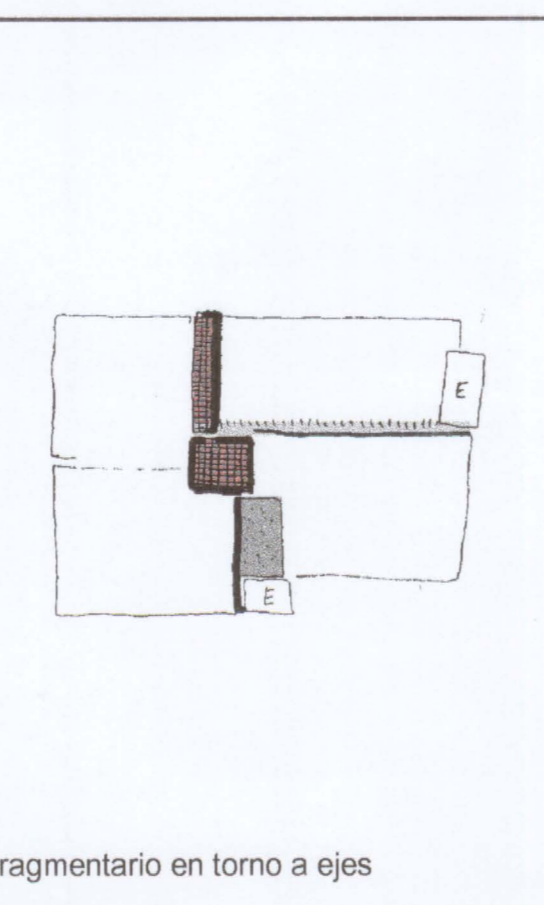

7 TIPOS DE UNIDAD VECINAL 8 ASOCIACIÓN DE UNIDAD VECINAL

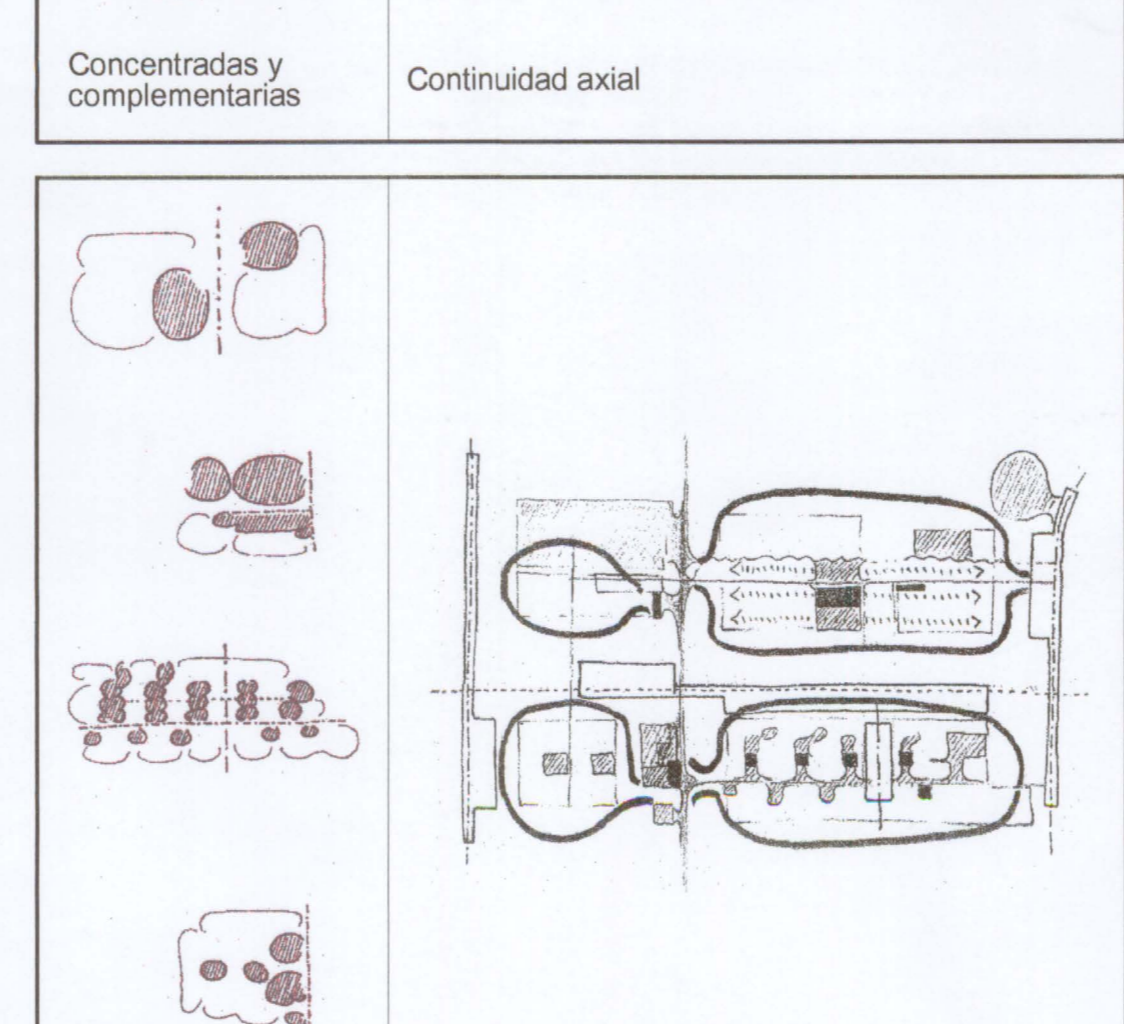
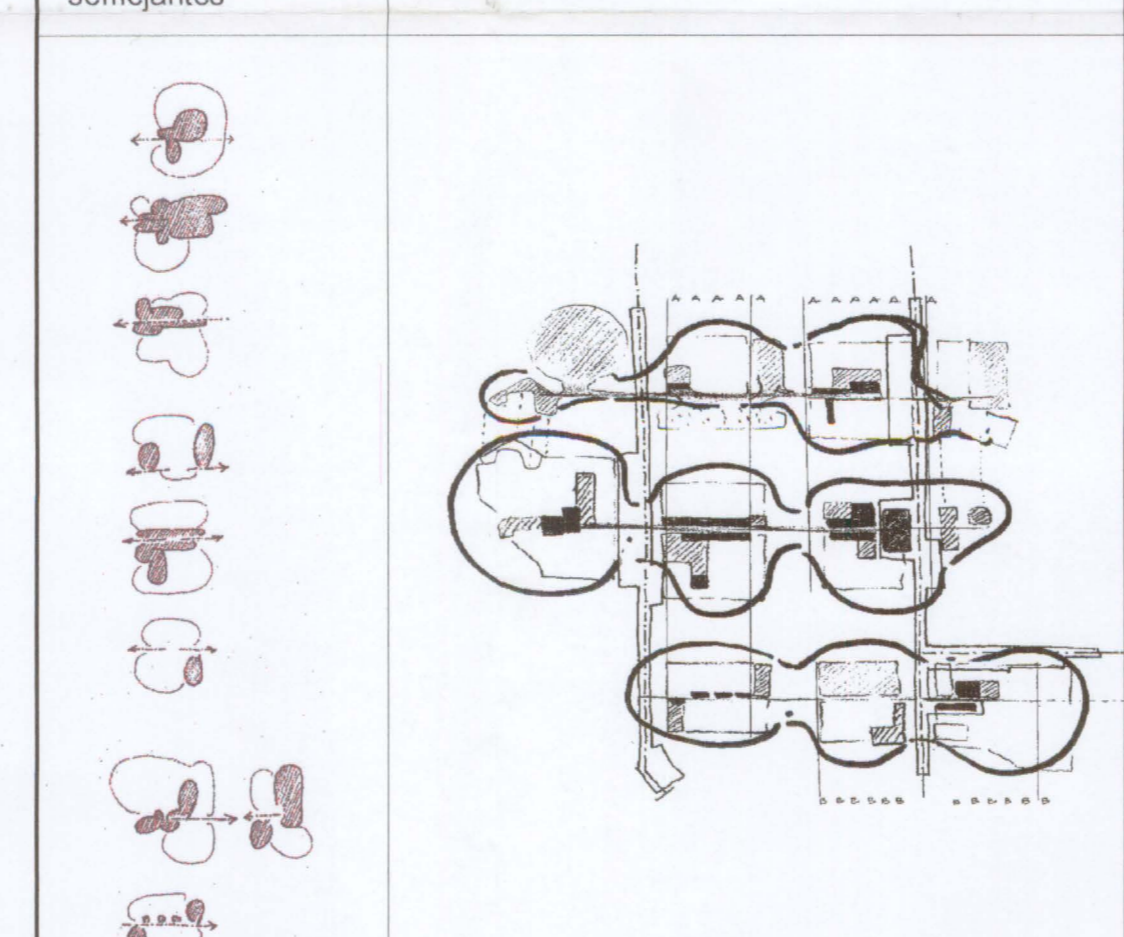
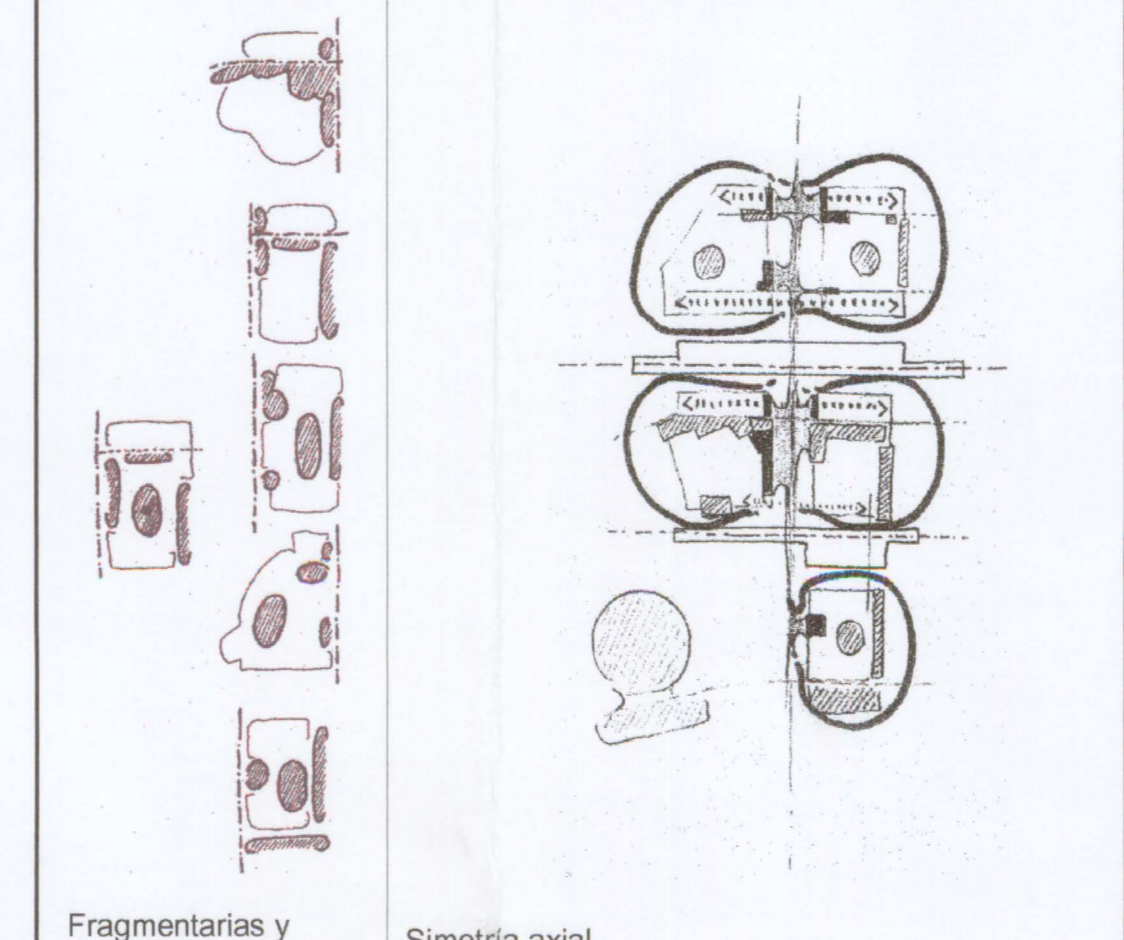
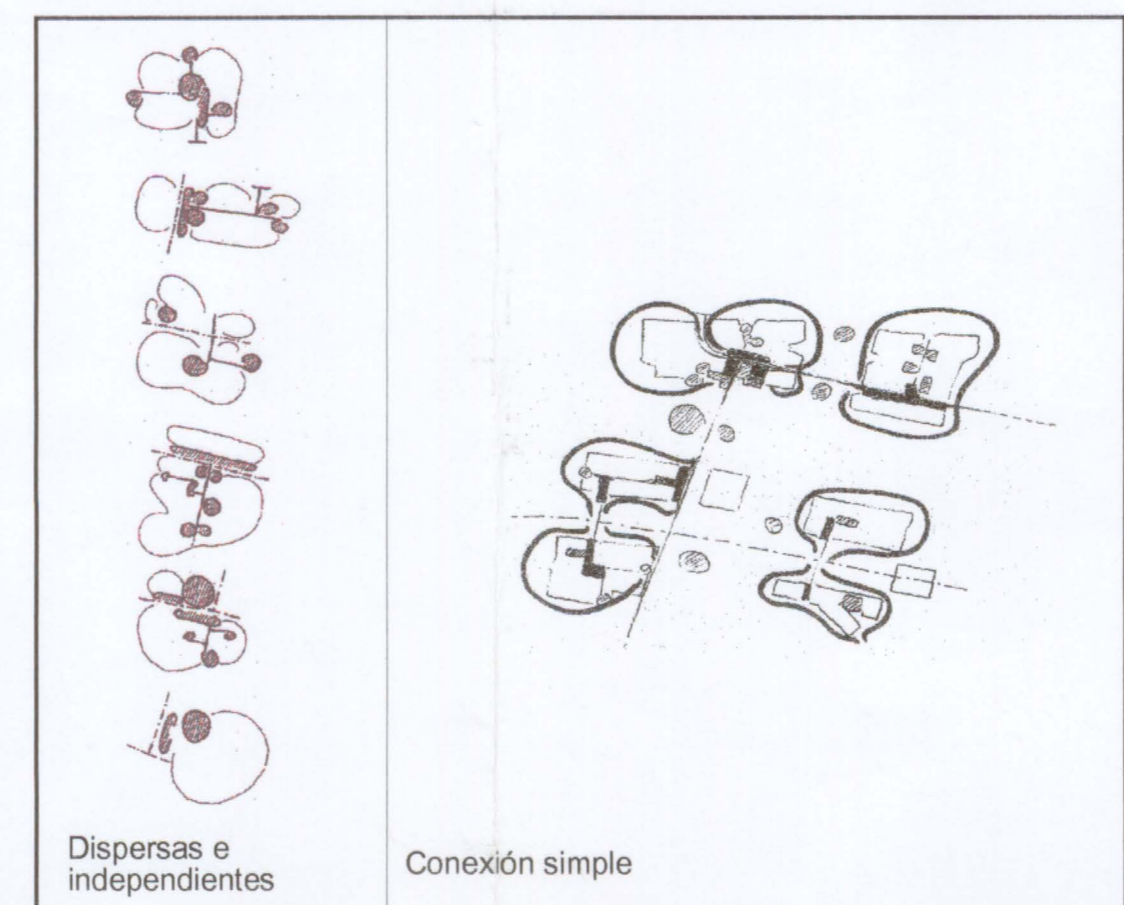

9 ORGANIZACIÓN FUNCIONAL

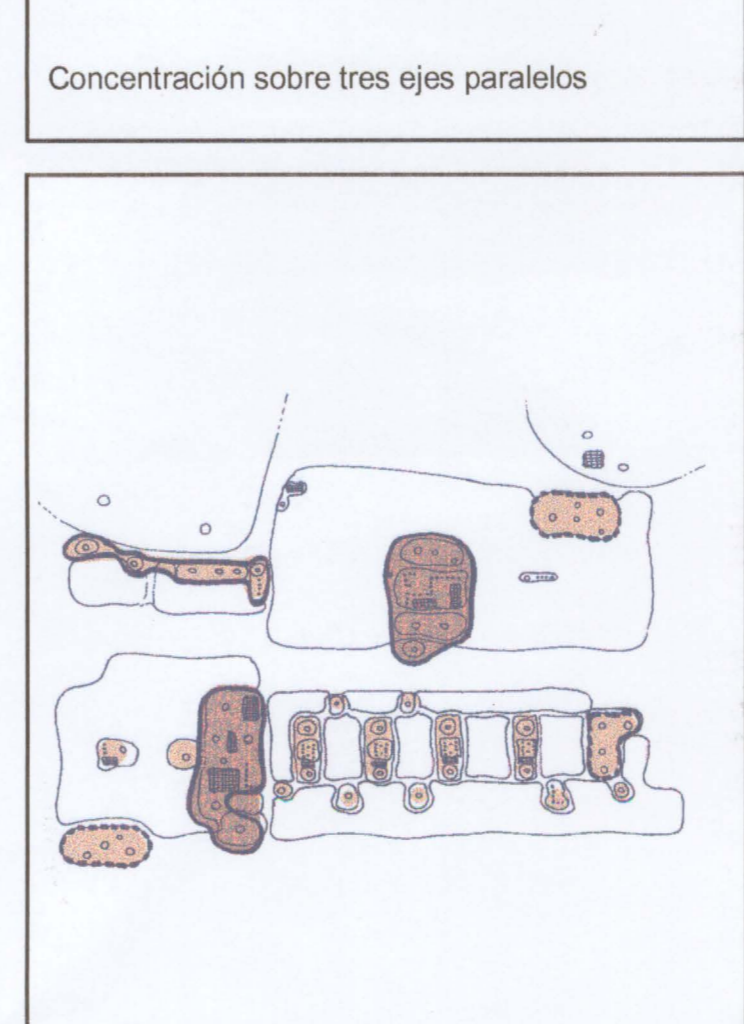
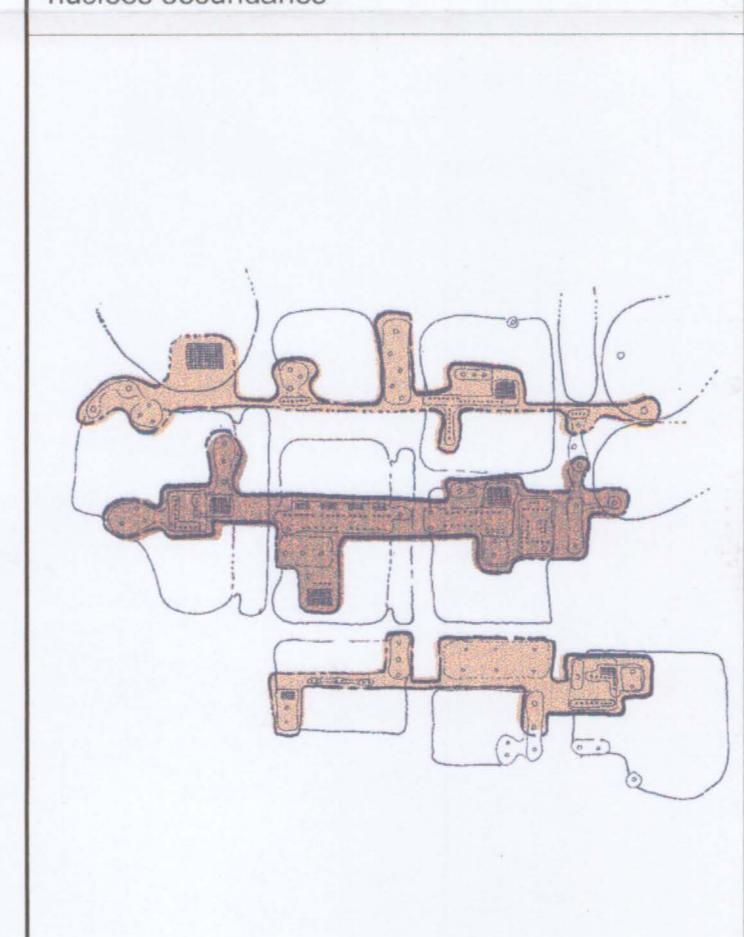
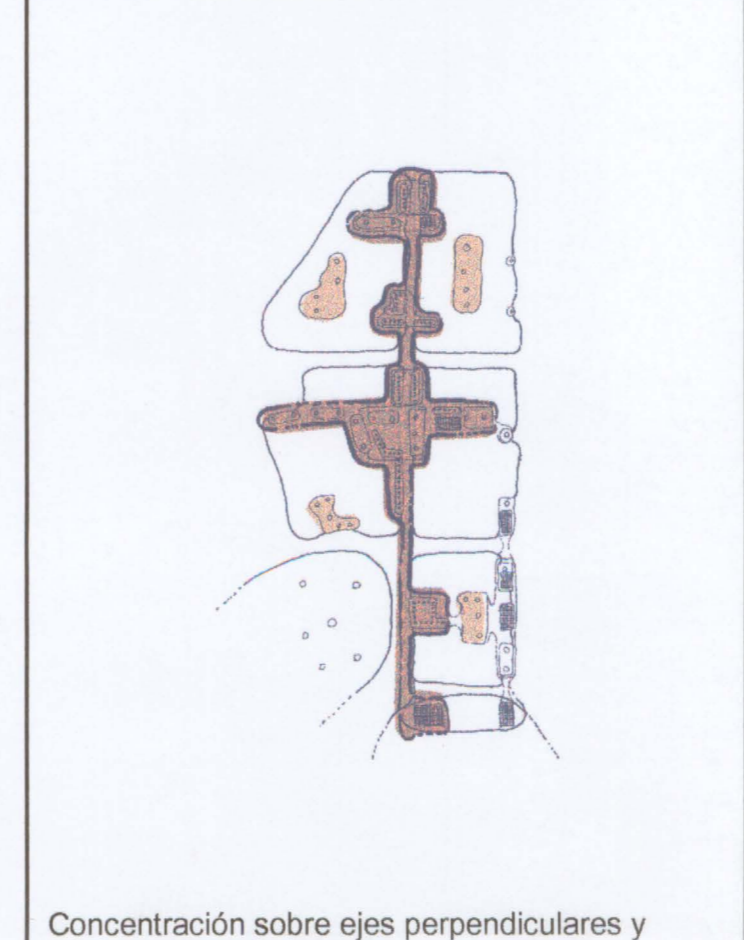
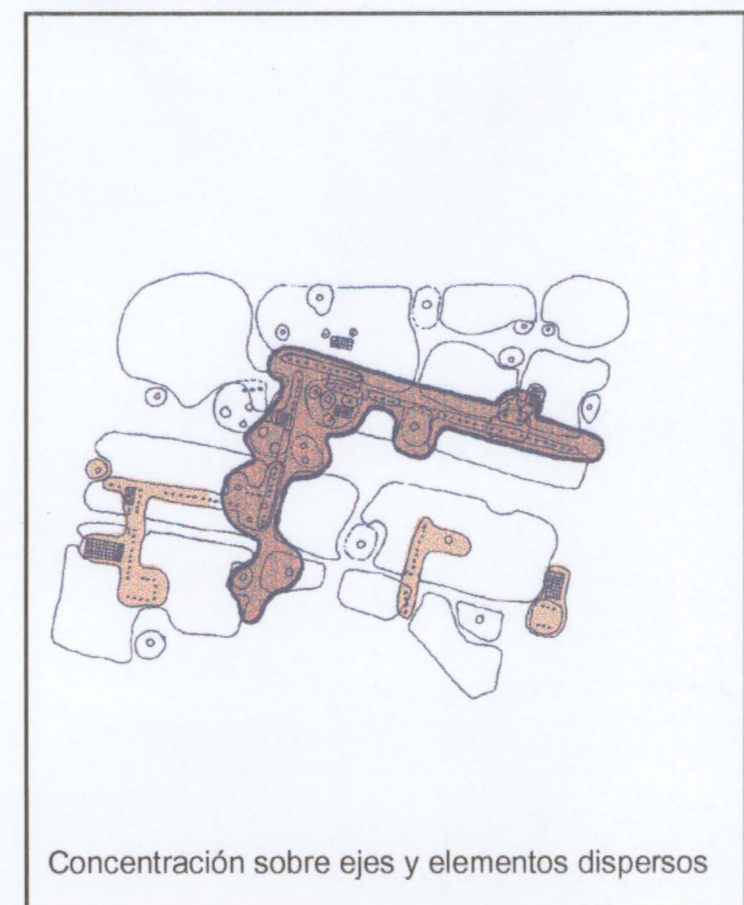

10 ORGANIZACIÓN FORMAL

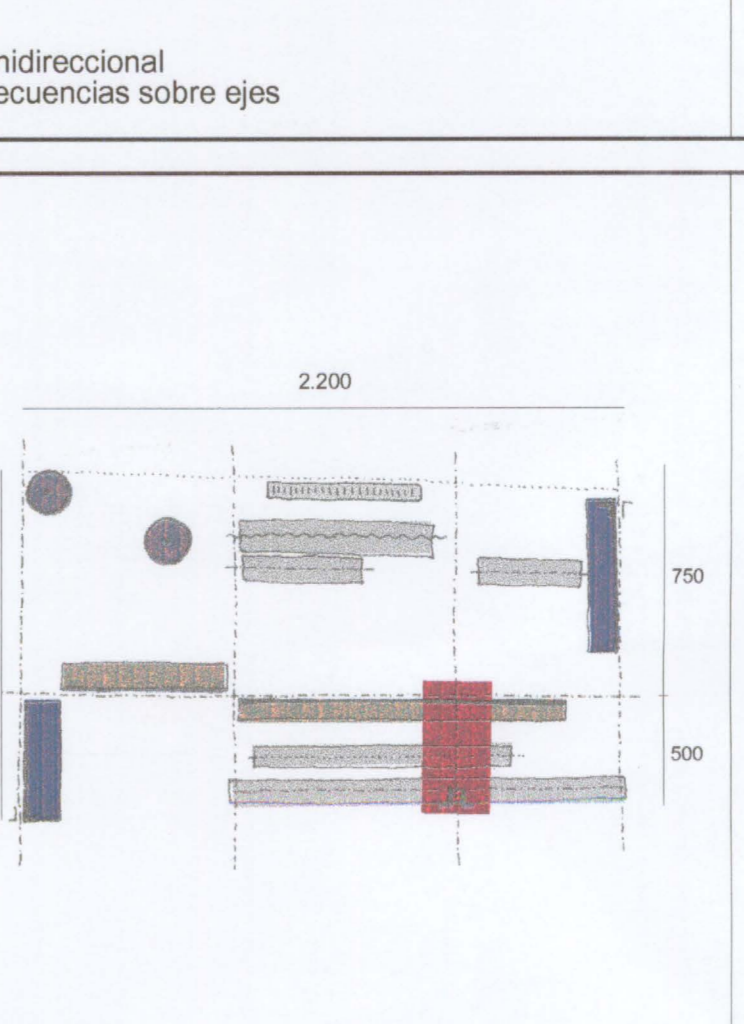
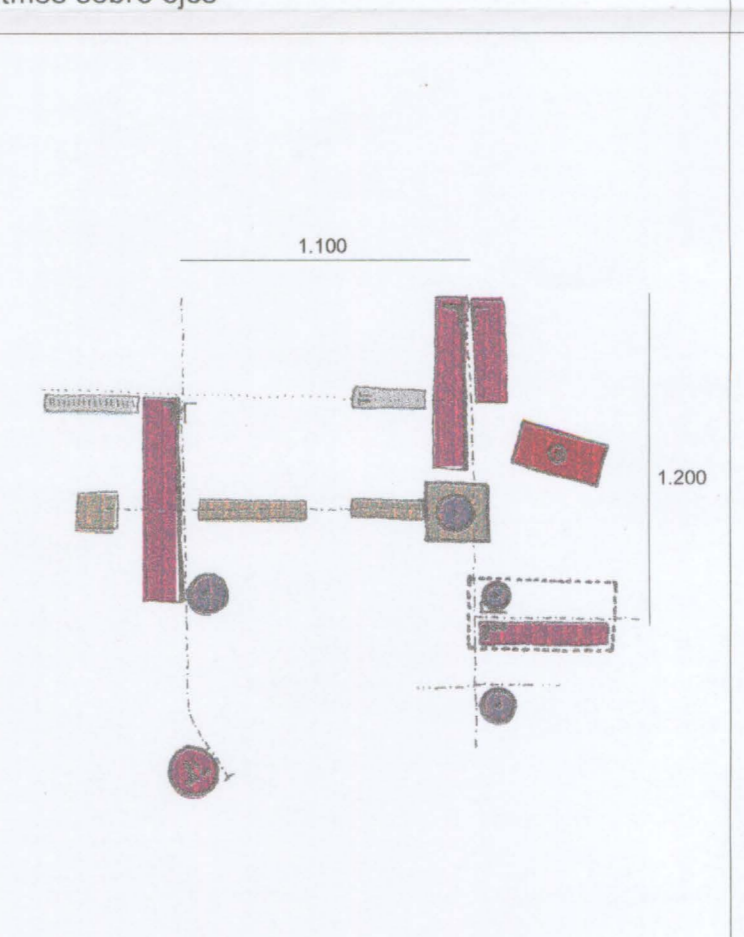
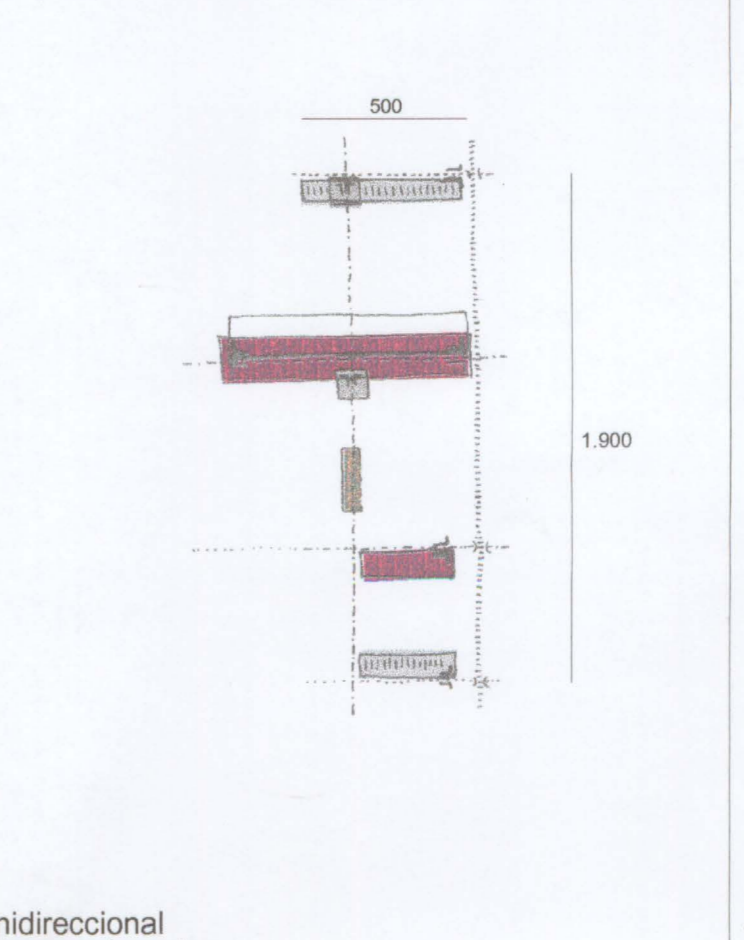
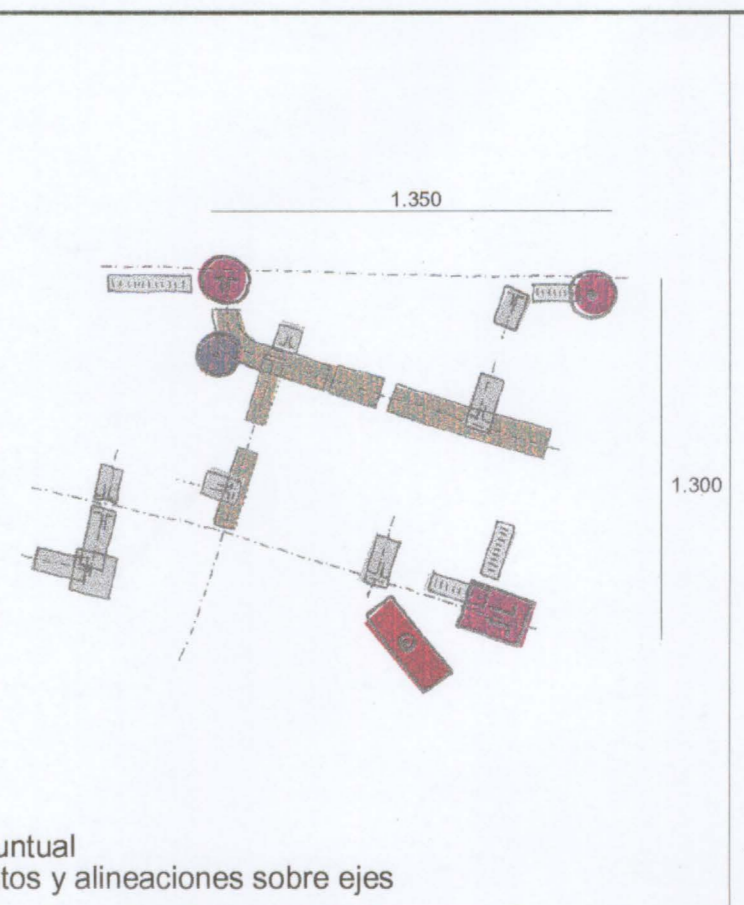

11 COMPOSICIÓN DE DISTRITO

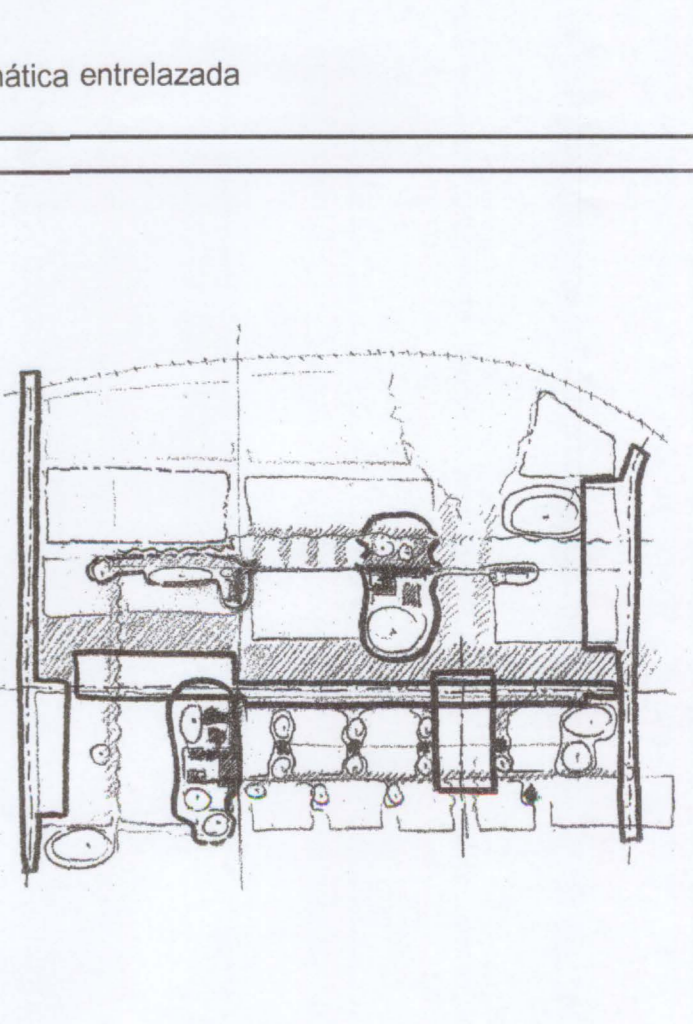
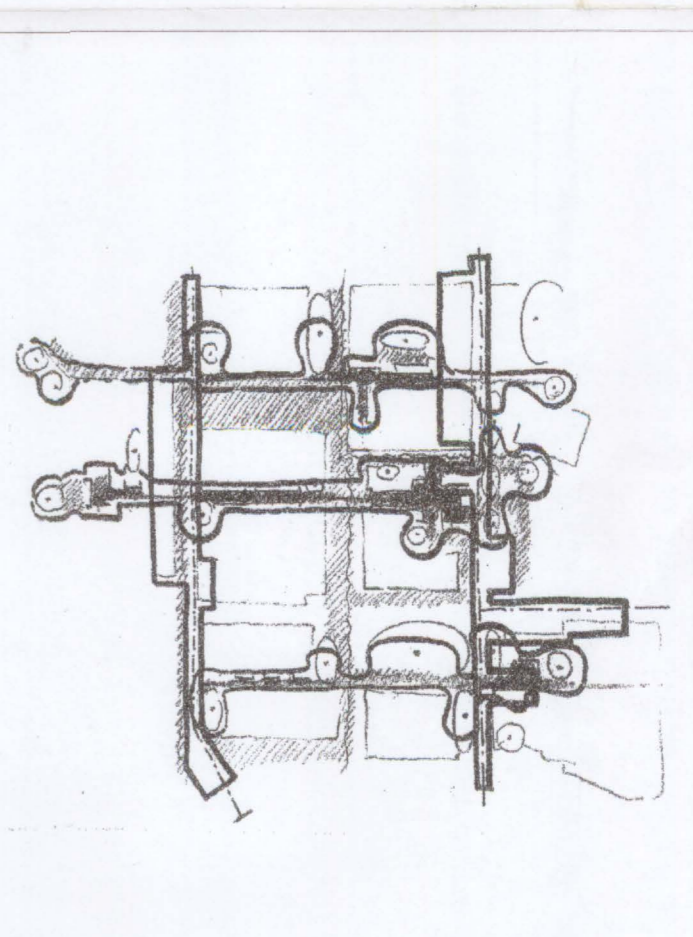
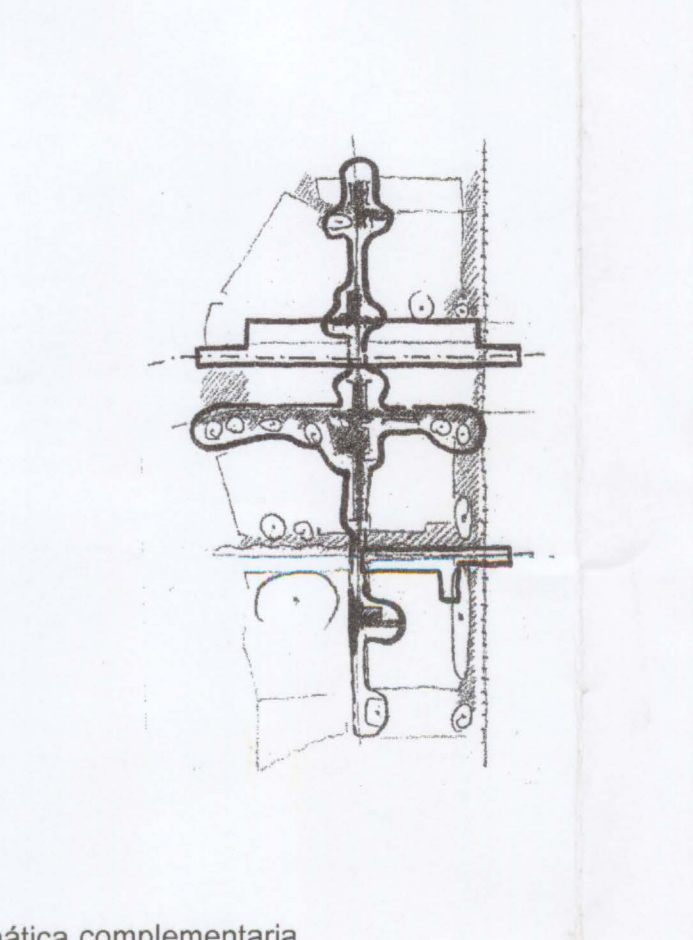
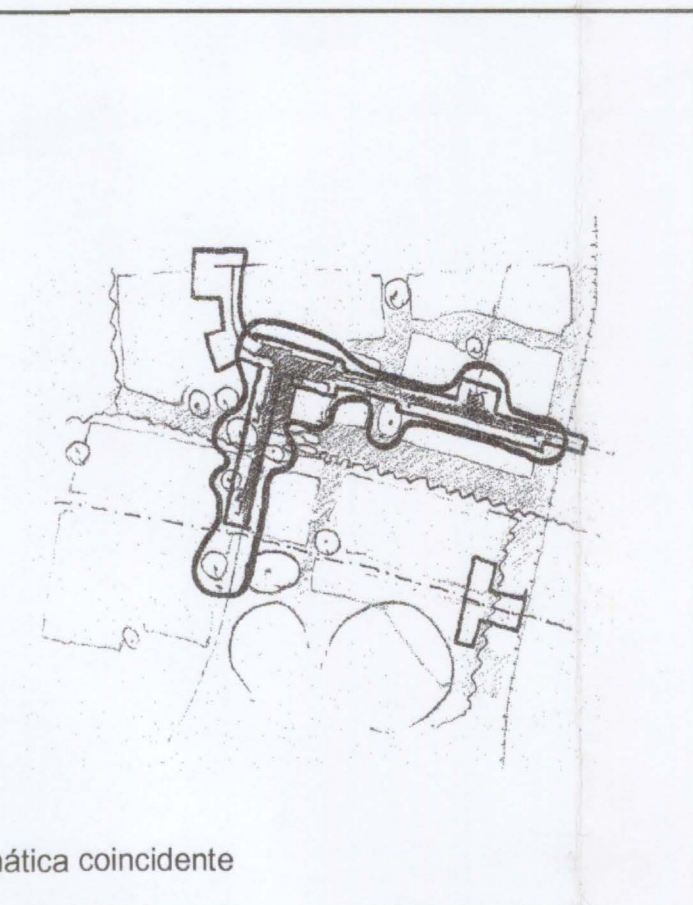

UN PROCESO ABIERTO

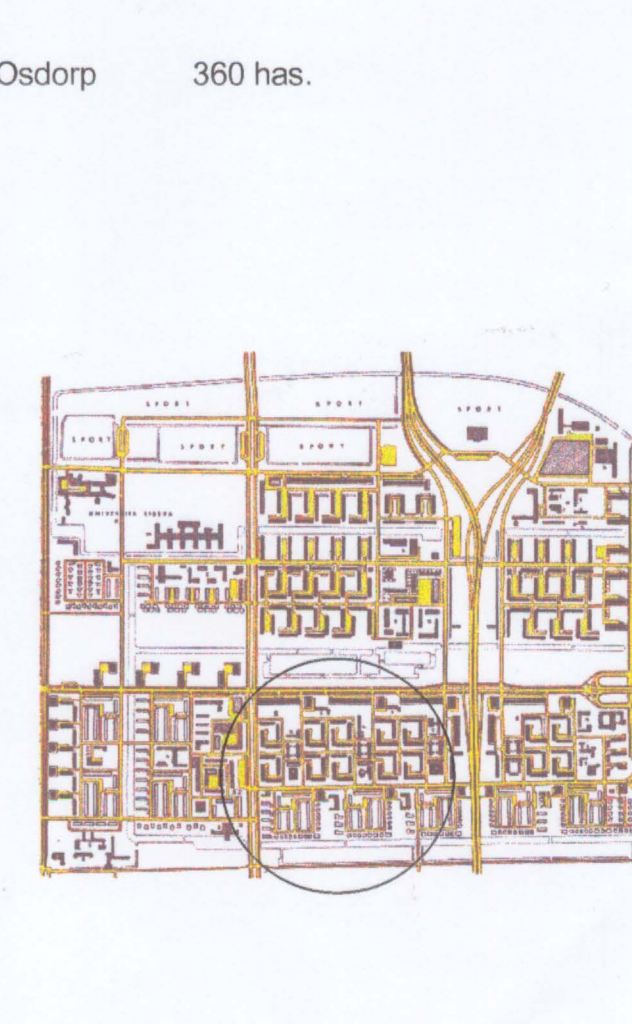
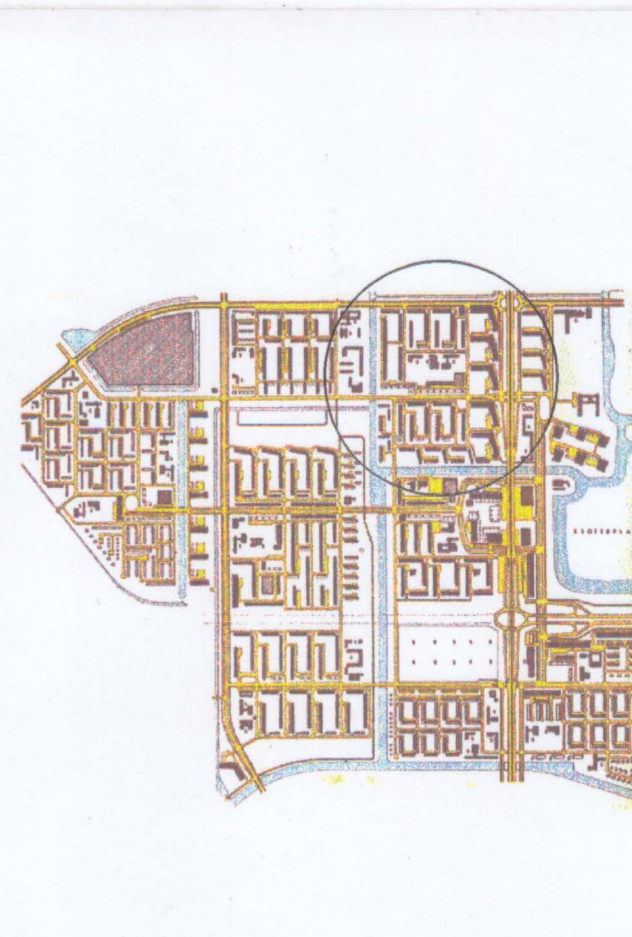
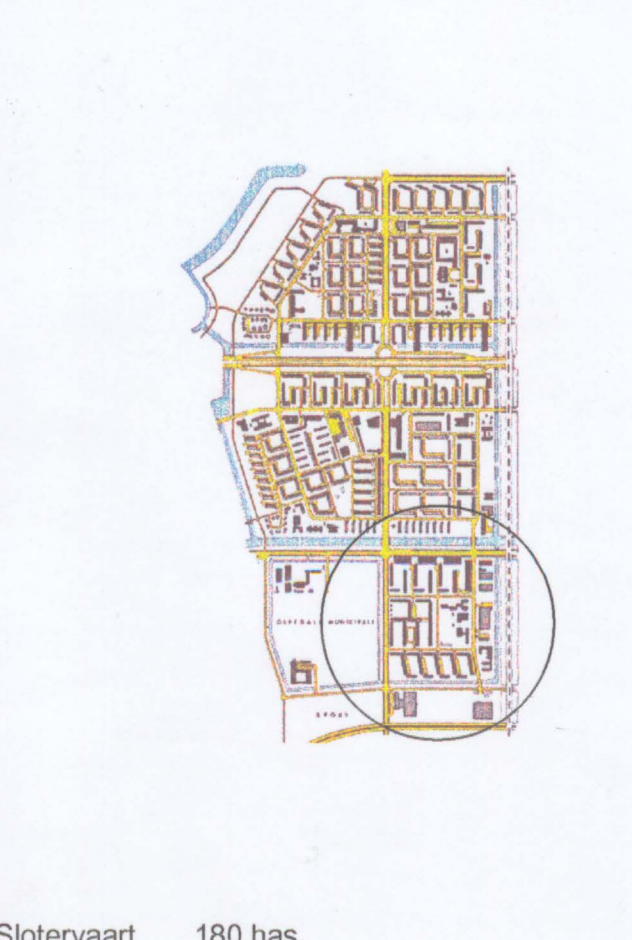

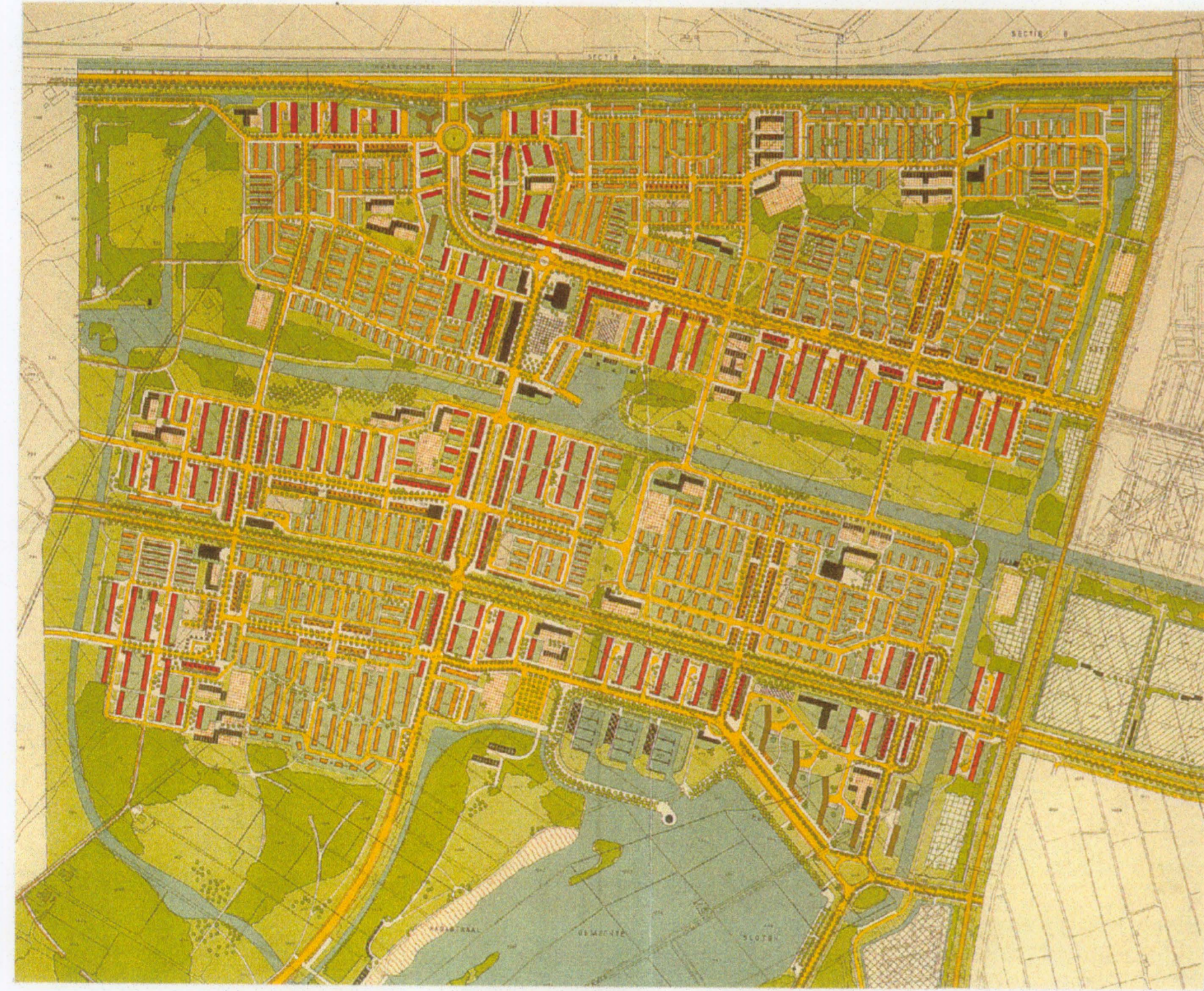

Sloterveer, 1939



Slotervaart, 1953

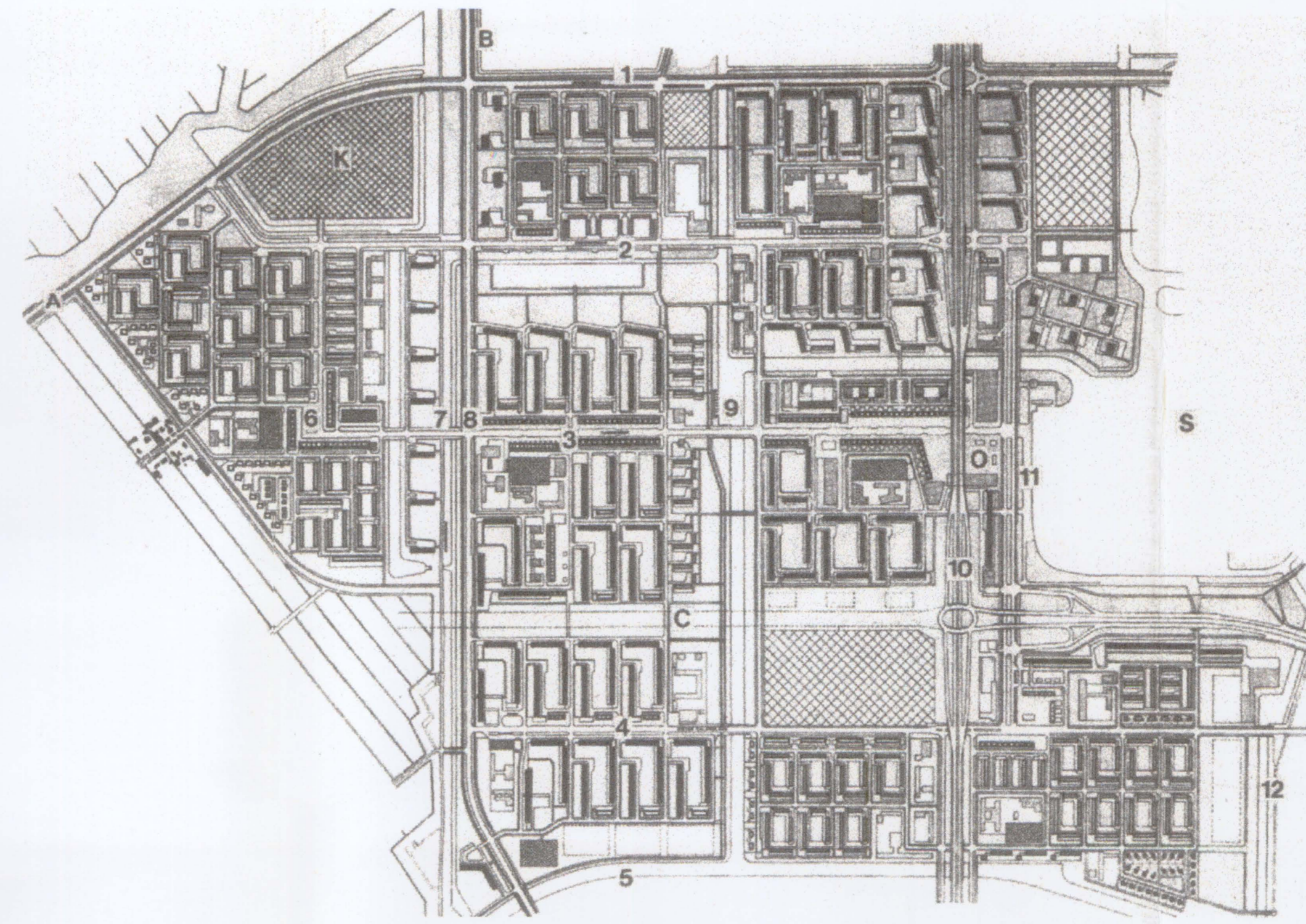

Osdorp, 1958

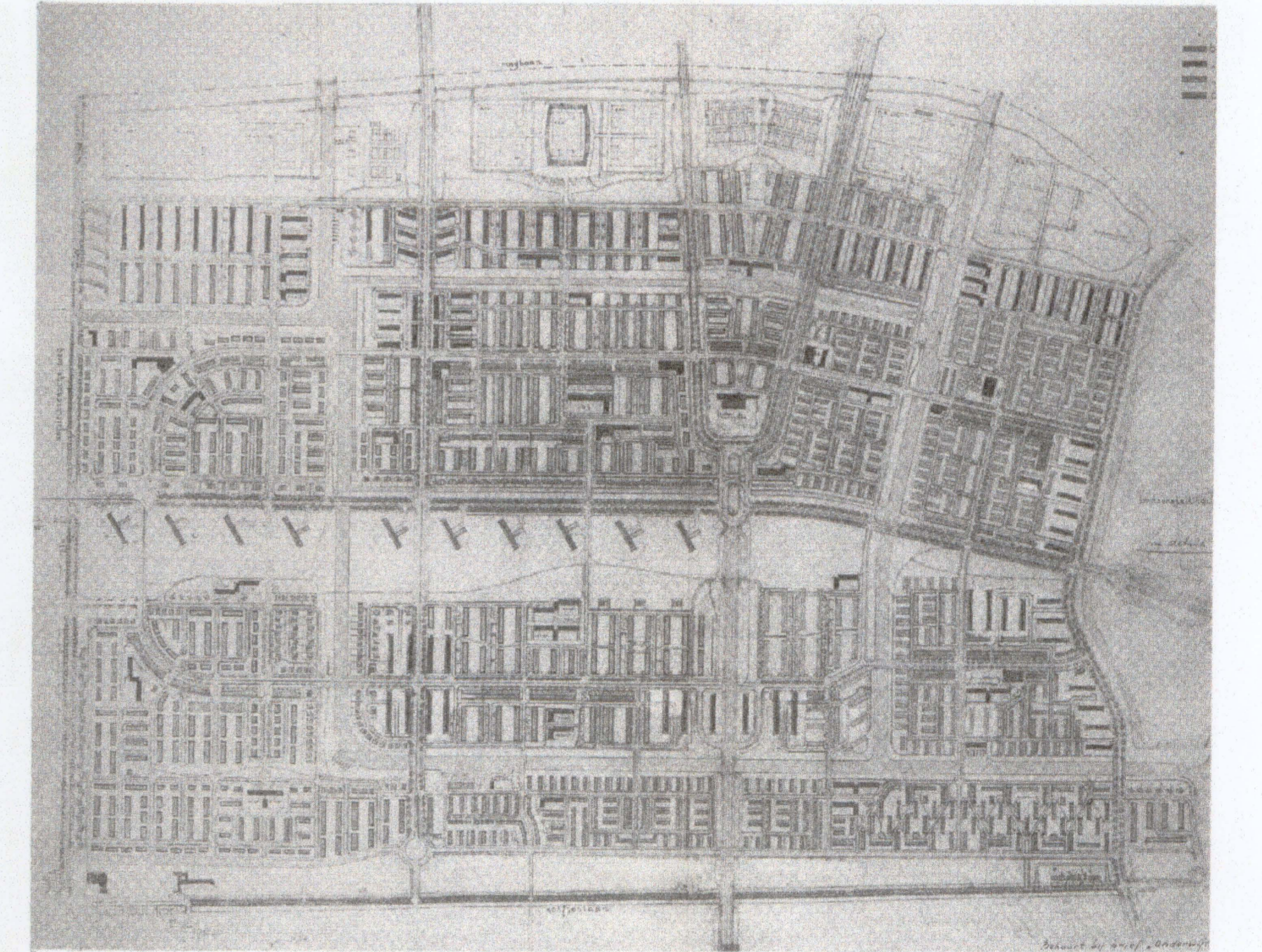

Buitenveldert, 1940



Sloterveer, 1963

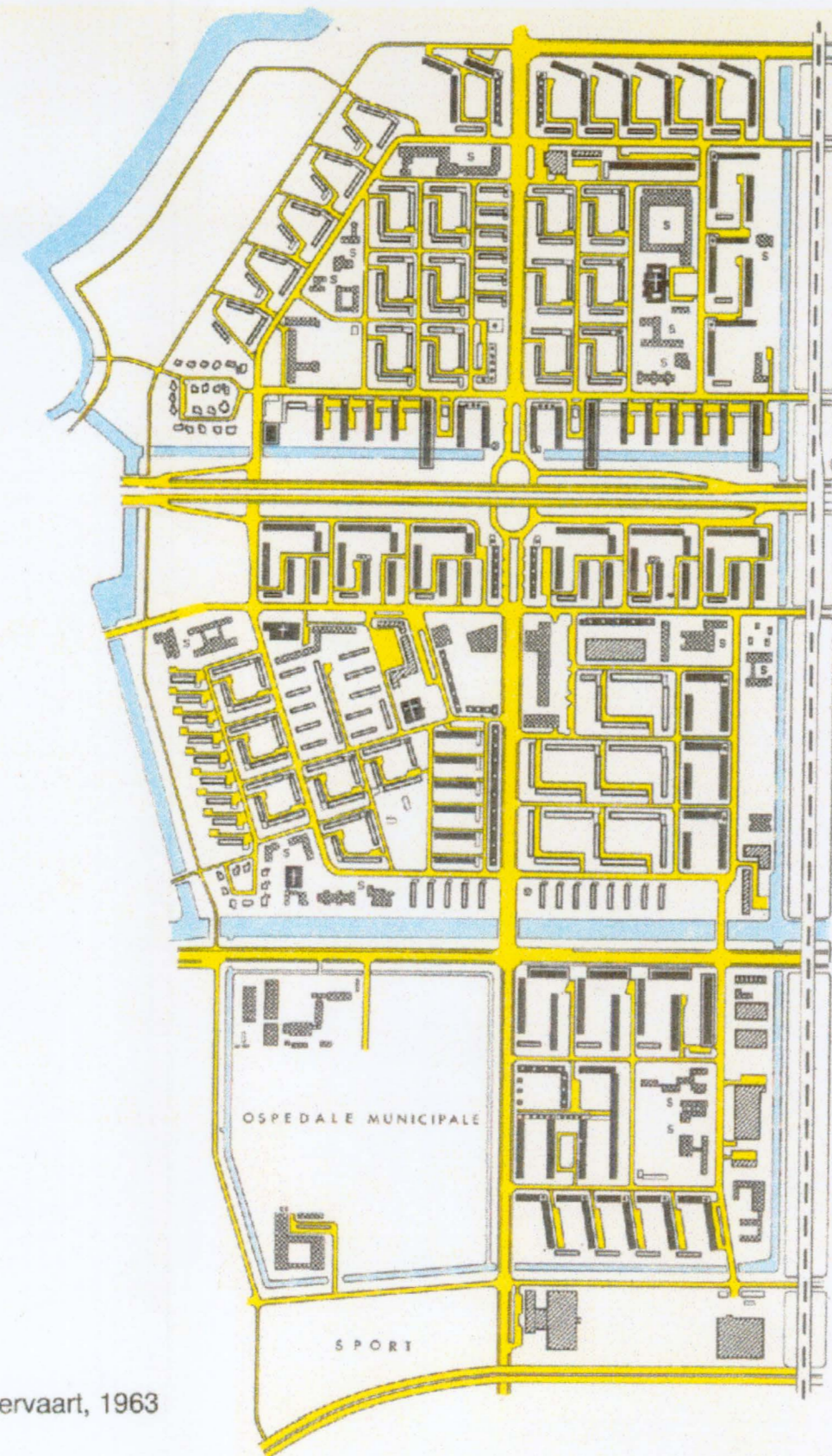

Slotervaart, 1963

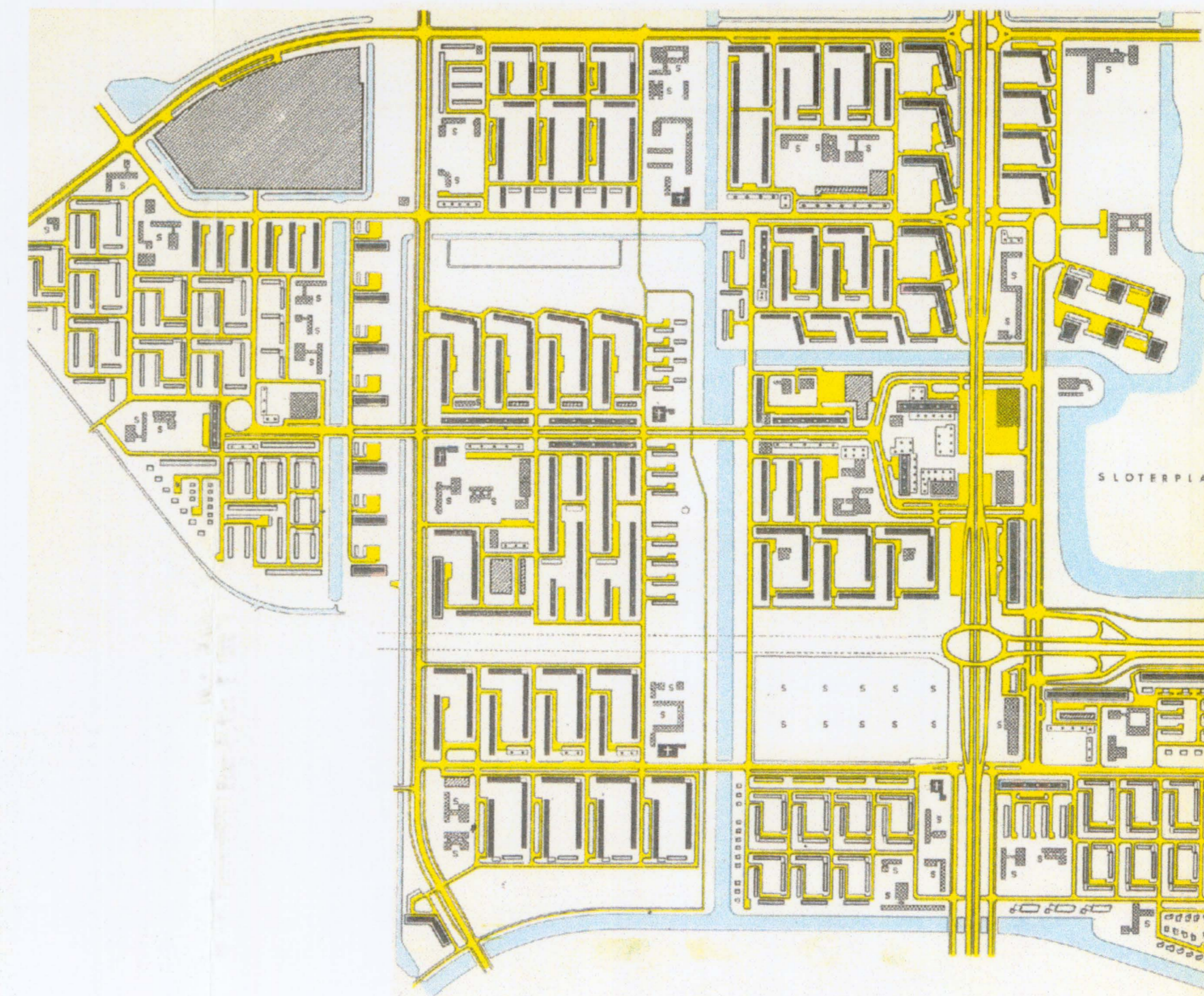

Osdorp, 1963

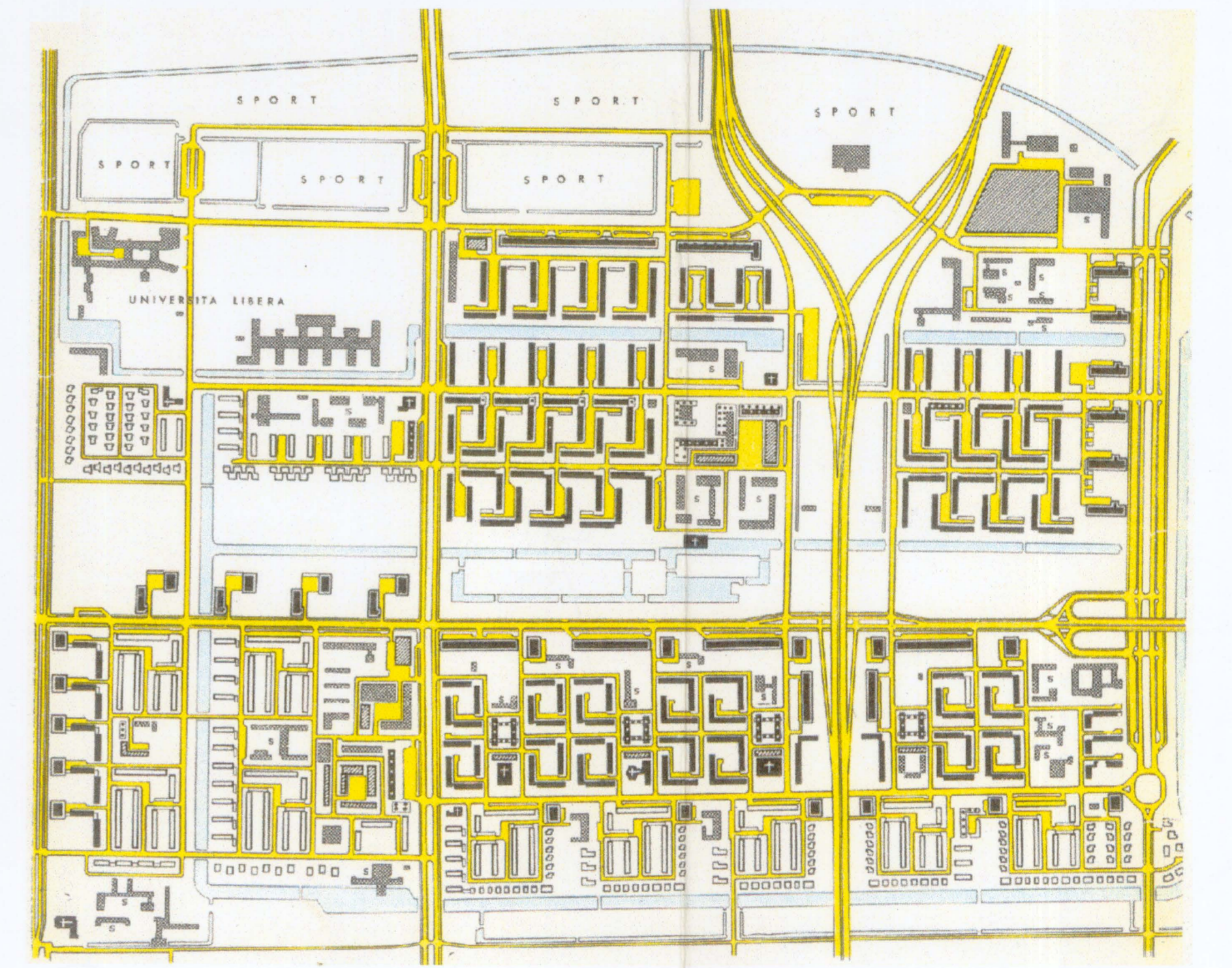

Buitenveldert, 1963