

CÁLCULO DE CARGAS APLICADAS A LA ESTRUCTURA DE SÓTANO

Table with 2 columns: 'ESTADO DE LÍMITES ÚLTIMOS' and 'ESTADO DE LÍMITES DE SERVICIO'. It lists load values for different states like 'PA x 1.35 + PP x 1.35 + SU x 1.5 + SN x 1.5' and 'PA x 1 + PP x 1 + SU x 1 + SN x 1'.

PÓRTICO 1 Y 2 (ANCHO DE BANDA = 7.5)

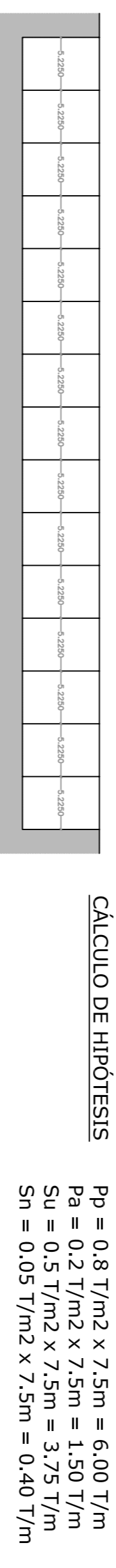

PÓRTICO 3 (ANCHO DE BANDA = 6.5)

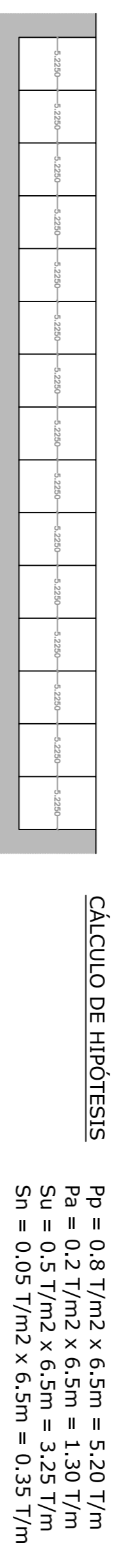

PÓRTICO 4-10 (ANCHO DE BANDA = 5.5)

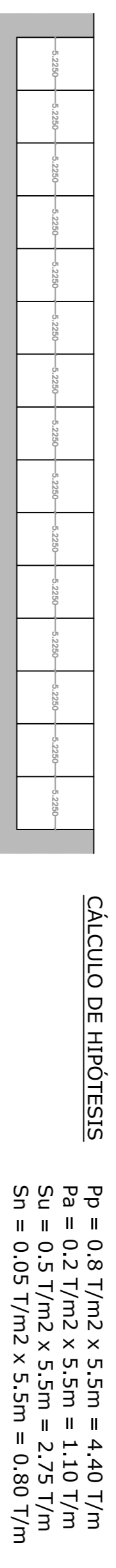

PÓRTICO 11 (ANCHO DE BANDA 1 = 5.5) (ANCHO DE BANDA 2 = 2.75) (ANCHO DE BANDA 3 = 6.5)

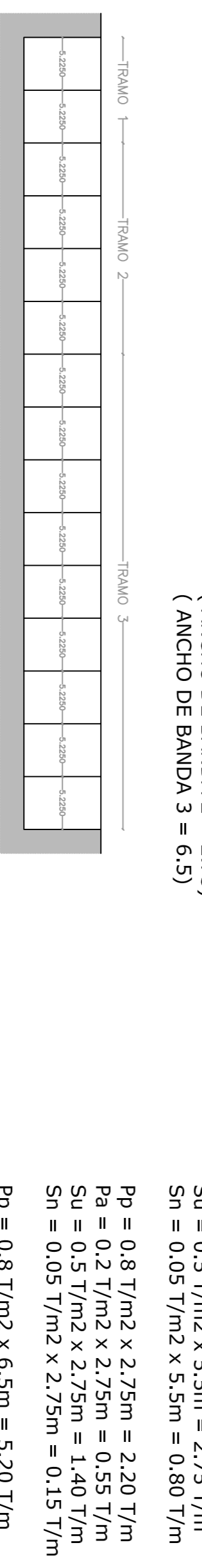

PÓRTICO 12 (ANCHO DE BANDA = 5.5) PÓRTICO 13-21 (ANCHO DE BANDA = 5.5)

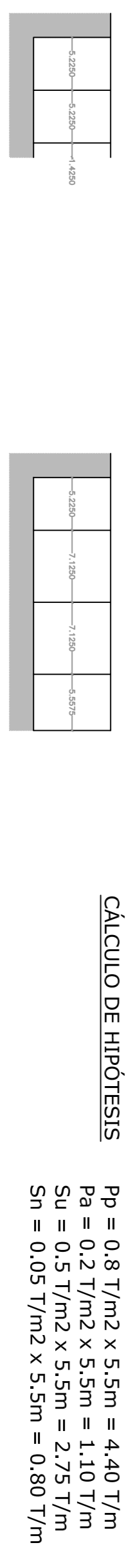

PÓRTICO 22-28 (ANCHO DE BANDA = 7.5)



PÓRTICO 29 (ANCHO DE BANDA = 5.5) PÓRTICO 30 (ANCHO DE BANDA = 1.85)



CÁLCULO DE LOS ELEMENTOS ESTRUCTURALES

JÁCENAS 310, 324, 325, 349, 350, 364



JÁCENAS 151-162, 166-178, 182-193, 197-211, 198-232, 236-248, 252-263, 266-278, 282-306, 283-307

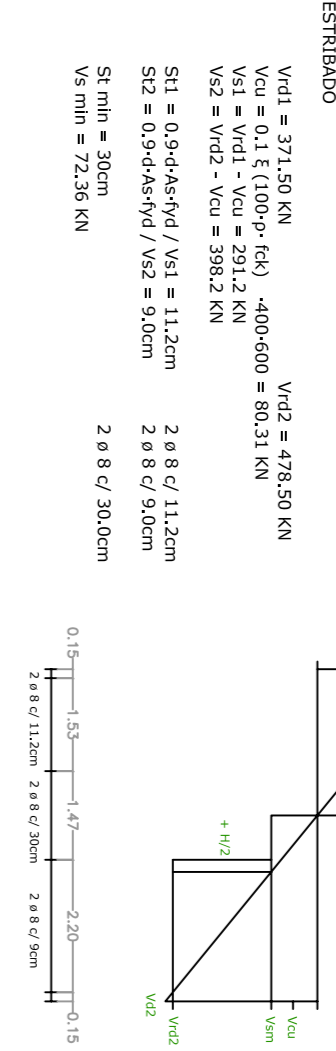

JÁCENAS 311-323, 326-348, 351-363

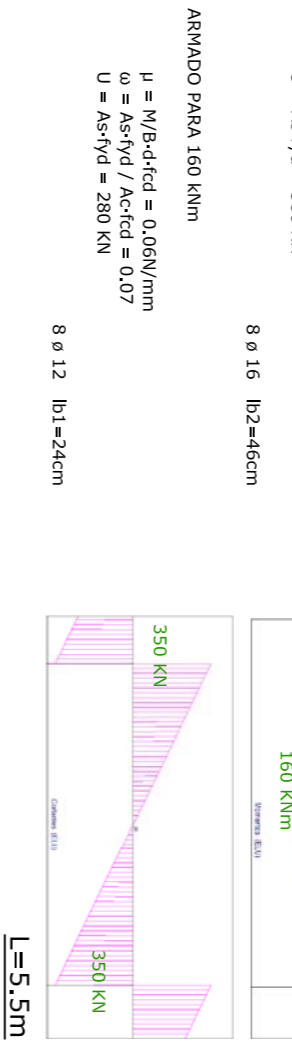

JÁCENAS 41, 53, 54, 77, 88, 99, 100, 114



JÁCENAS 30, 33, 45, 61, 62, 80, 91, 105, 106, 115, 123, 124, 139, 140

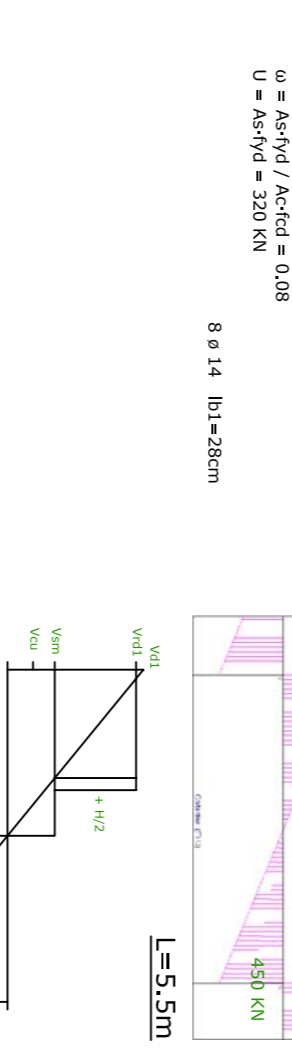

JÁCENAS 1, 2, 21, 24, 46, 63, 64, 92, 107, 116, 125, 126, 141

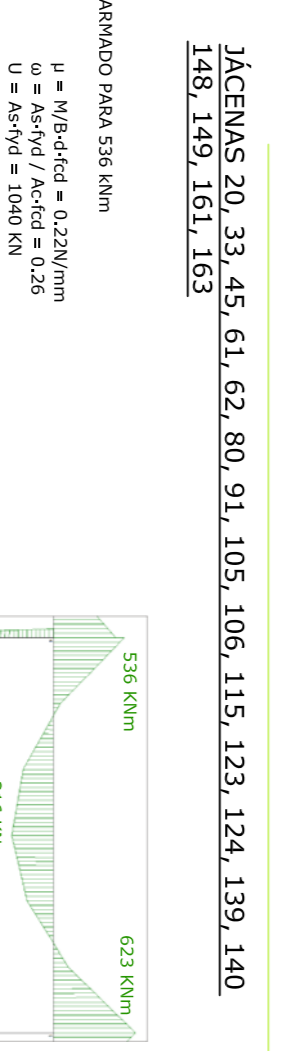

JÁCENAS 150, 156, 164, 165, 179, 180, 194, 195, 196, 233, 234, 235, 249

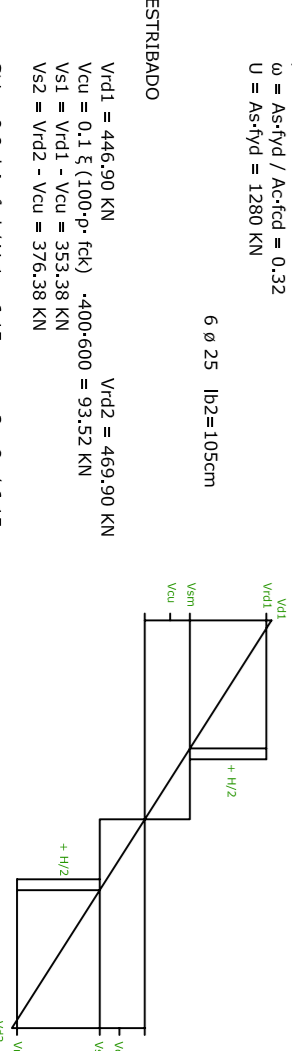

JÁCENAS 250, 254, 265, 279, 280, 308, 281, 309



JÁCENAS 311-323, 326-348, 351-363

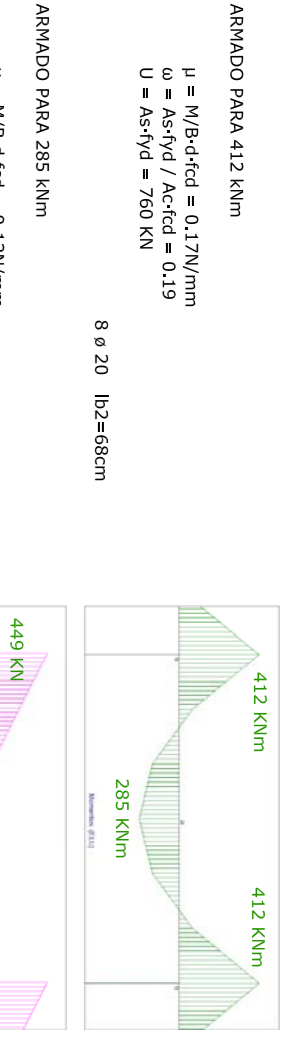

JÁCENAS 40, 52, 75, 76, 98, 113, 122, 137, 138, 147

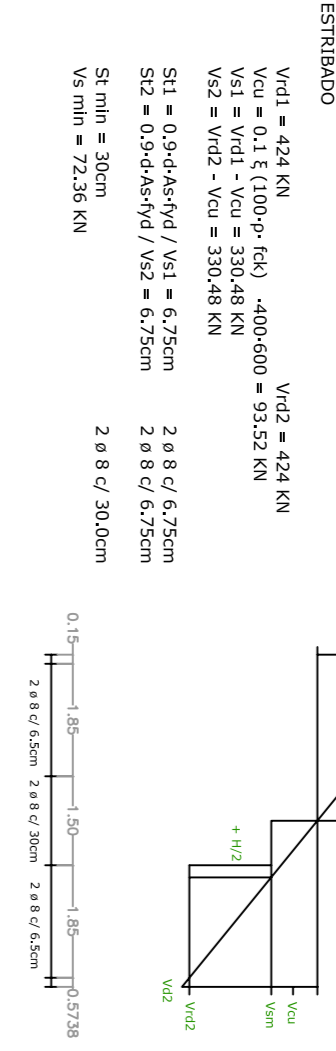

JÁCENAS 41, 53, 54, 77, 88, 99, 100, 114



JÁCENAS 30, 33, 45, 61, 62, 80, 91, 105, 106, 115, 123, 124, 139, 140



JÁCENAS 1, 2, 21, 24, 46, 63, 64, 92, 107, 116, 125, 126, 141

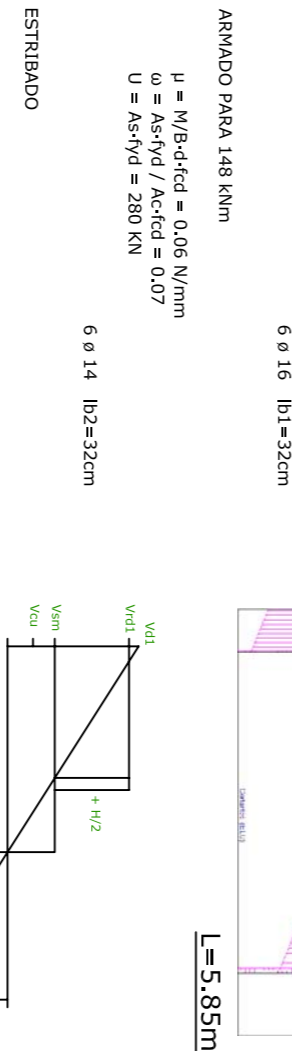

JÁCENAS 150, 156, 164, 165, 179, 180, 194, 195, 196, 233, 234, 235, 249

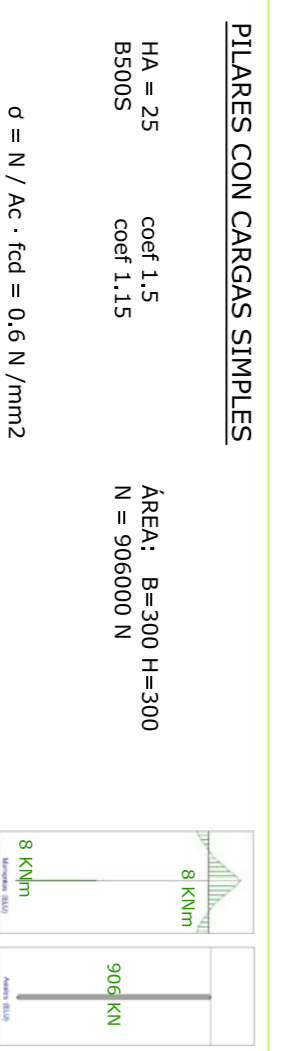

JÁCENAS 250, 254, 265, 279, 280, 308, 281, 309

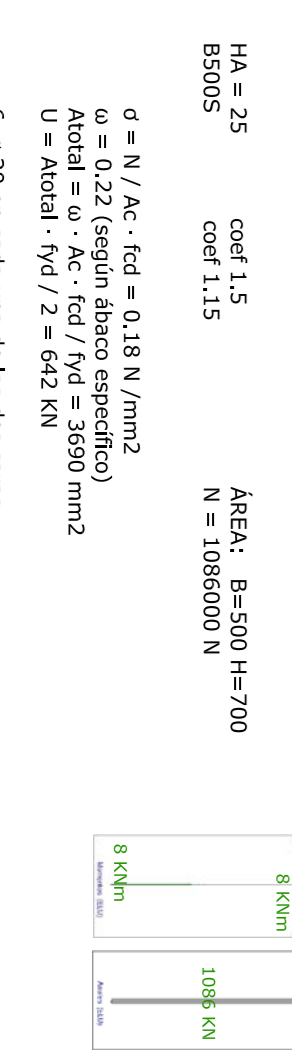

JÁCENAS 150, 156, 164, 165, 179, 180, 194, 195, 196, 233, 234, 235, 249

